

Rutledge Park

Water Play Feature and Washroom Building

A Quadra Cedar Hill Community
Association partnership with
Saanich Parks and Recreation



Background



1997

Background

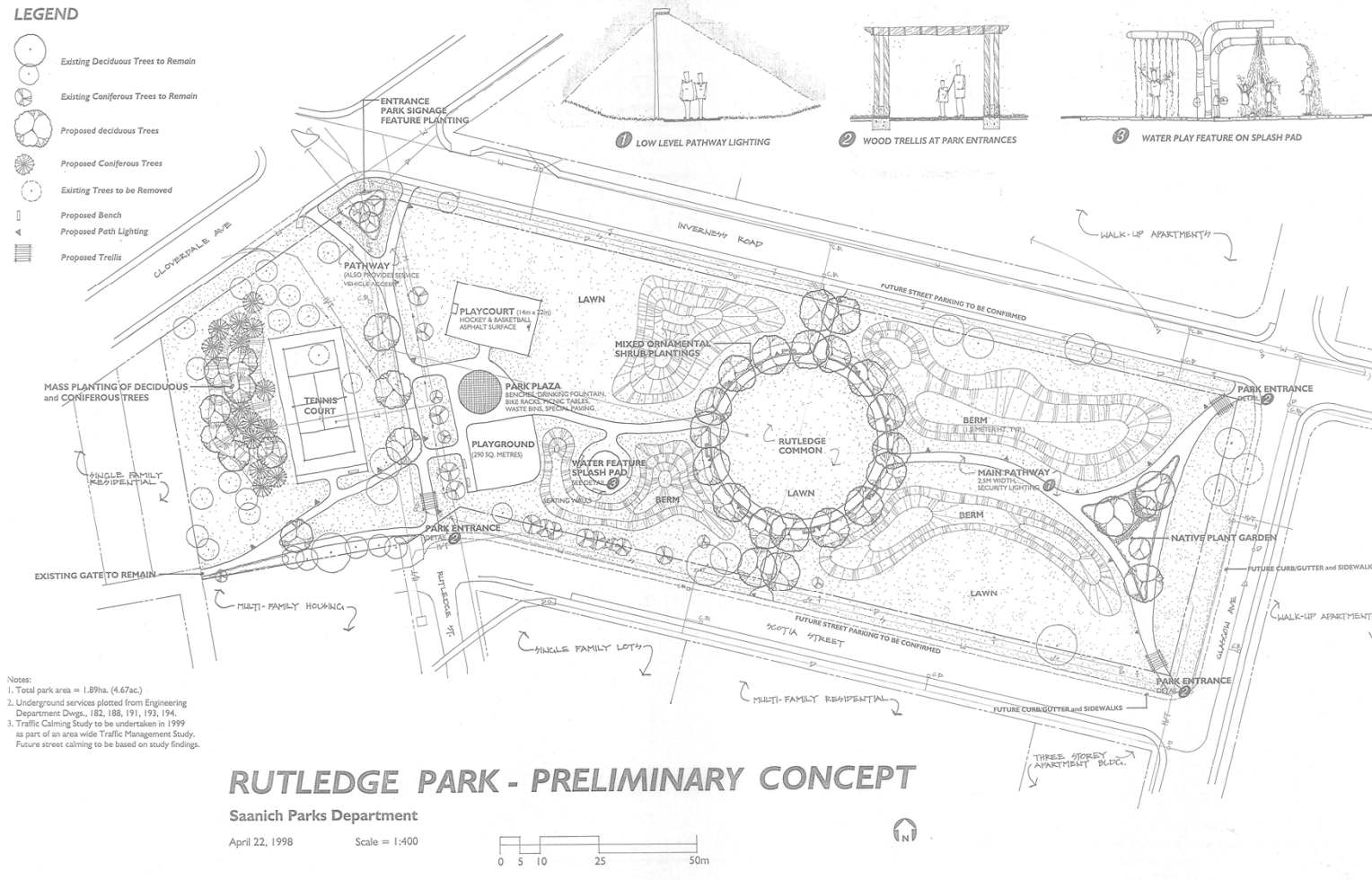

1998

Background



2013

Issues

- Community Feedback – Public Participation
- Design
- Budget / Funding – including Council approval
- Operations
- Site related – existing infrastructure, parking and washroom / changeroom



Design Considerations

Inclusive Play

Age & Development

Sensory
Stimulating
Activities

Universal Design

Universal Design

- Simple and intuitive to use
- Equitable and flexible in use
- Low level of physical effort
- Low chance of error or unintended actions
- Good size and space for approach



Universal Design

- Simple and Intuitive – clear water spray provides great feedback in how to use this piece.



Credit: Vortex and Monica Slanik, OT

Universal Design

- Equitable use – the design is useful and appeals to people of diverse abilities.

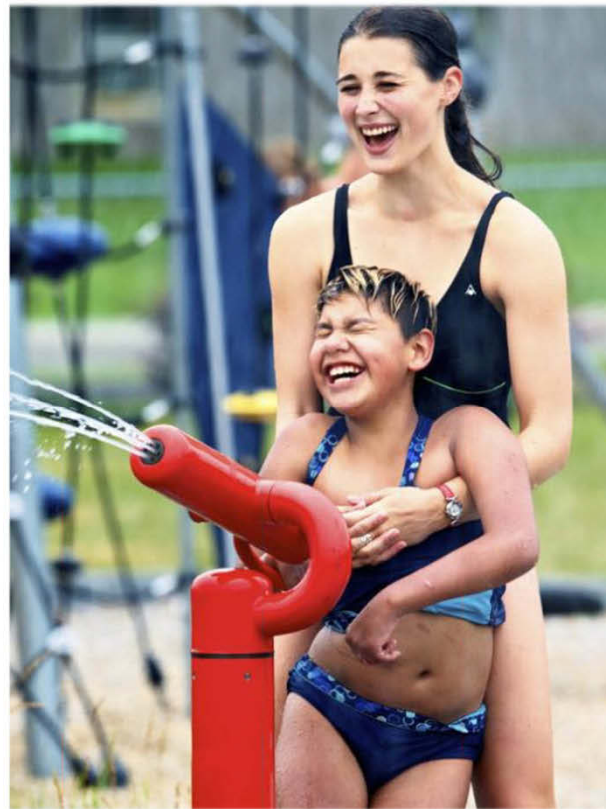

Credit: Vortex and Monica Slanik, OT

Universal Design

- Flexibility – the young girl can choose how to enjoy the water cannon, each choice provides different experiences and accommodates different abilities.

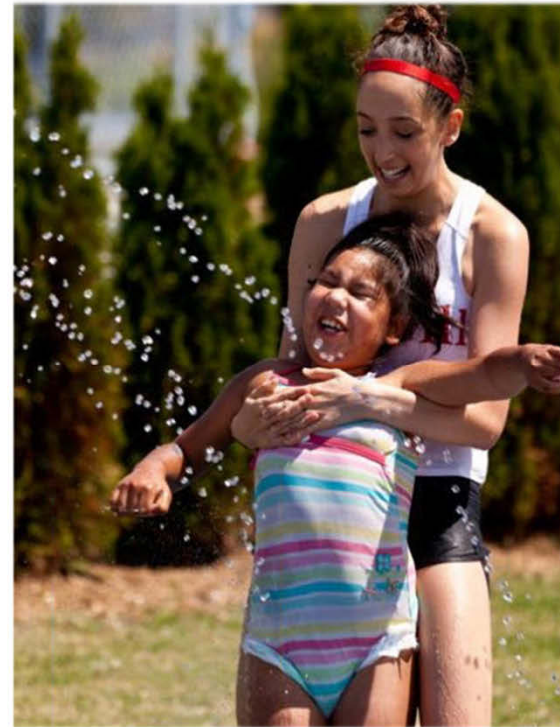

Credit: Vortex and Monica Slanik, OT

Age and Development

- Bay Design – appeals to everyone by providing play areas for families, toddlers and teens.



Age and Development

- Toddler Bay – includes different sized features and sensory experiences.



Credit: Vortex and Monica Slanik, OT

Age and Development

- Appropriateness – consideration given to various age groups based on those needs for sensorial experience and water intensities.



Age and Development

- Cross Generational – opportunity for different generations to share experiences and learn together.



Credit: Vortex and Monica Slanik, OT

Inclusive Play

- Inclusive play is primarily about all children and young people having equal access to, and equal participation in local play and leisure opportunities.



Credit: Vortex and Monica Slanik, OT

Inclusive Play

- Include both social and solitary types of play experiences and a range of play opportunities.



Credit: Vortex and Monica Slanik, OT

Inclusive Play

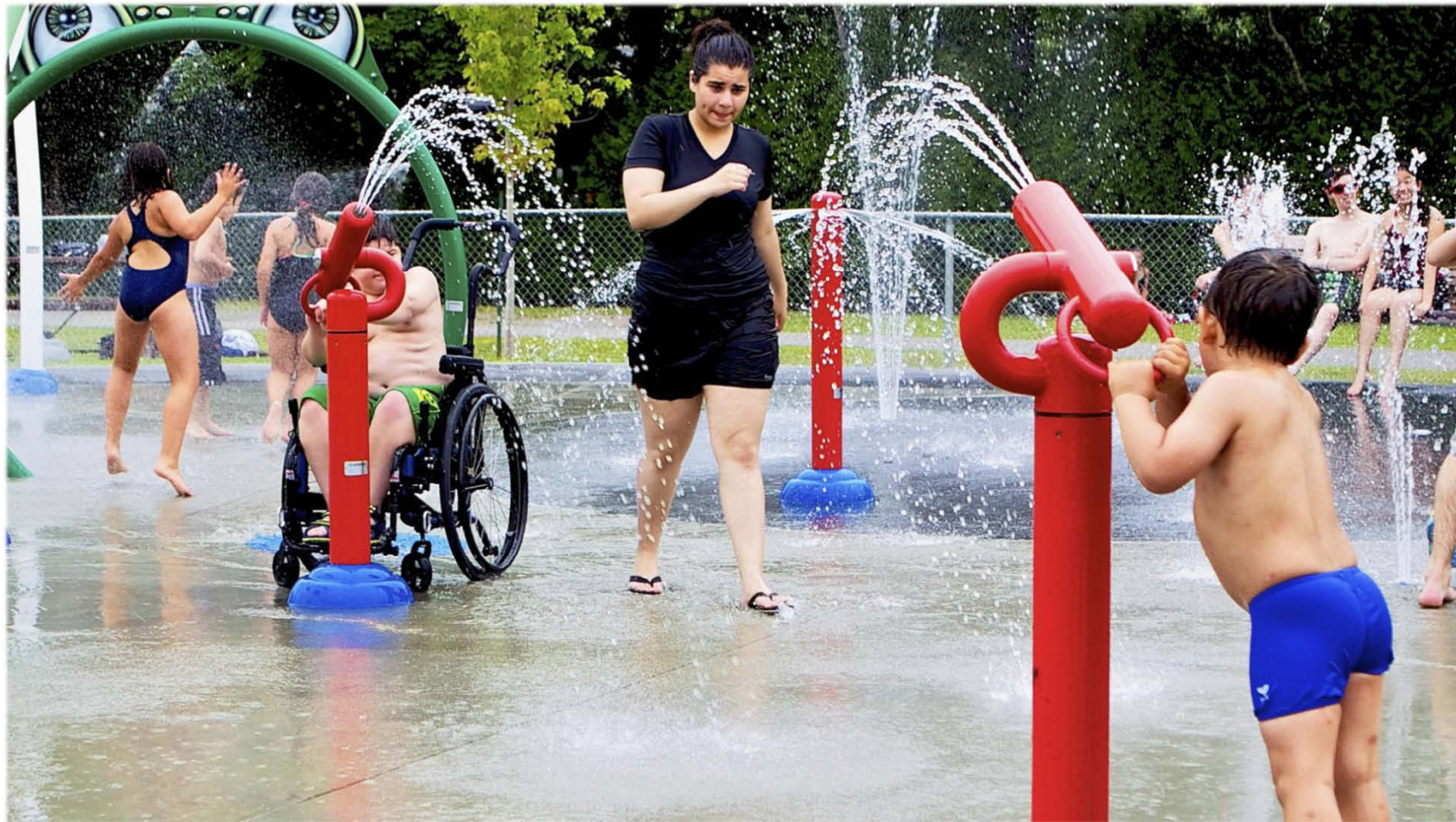

Credit: Vortex and Monica Slanik, OT

Sensory Stimulating Activities

- Water Textures

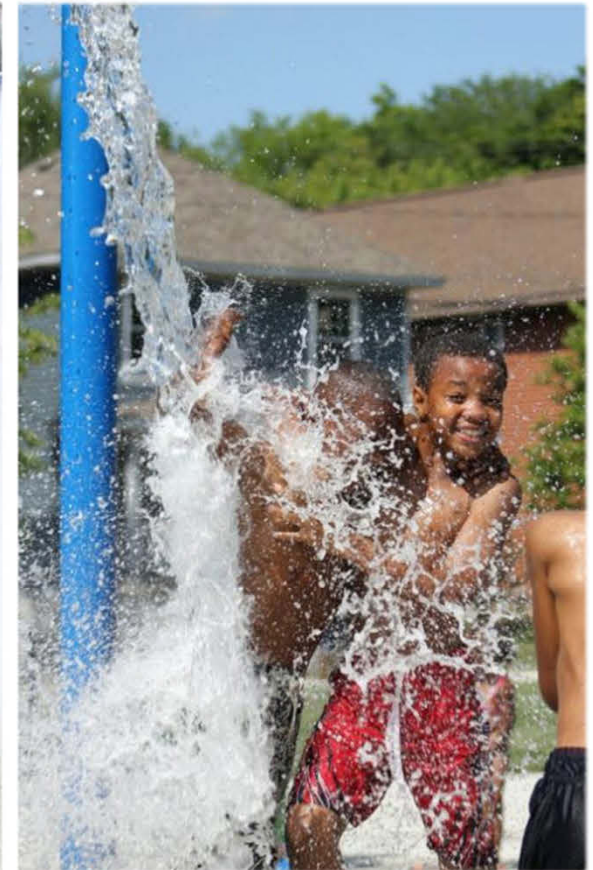

Sensory Stimulating Activities

- Water Effects – auditory, tactile variety, predictable and unpredictable



Credit: Vortex and Monica Slanik, OT

Sensory Stimulating Activities

- Water Effects



Soft Texture

Misty Sprays

Cascading

Dumping

Strong Jets

Sensory Stimulating Activities

- Integration Therapy – exposure to many types of sensorial experiences.
- Best therapeutic activity is play!



Sensory Stimulating Activities

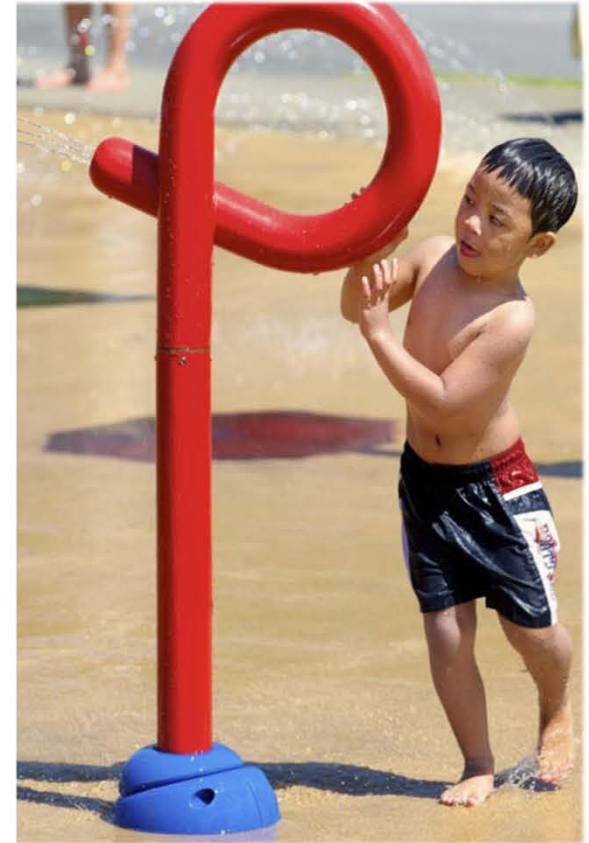

Credit: Vortex and Monica Slanik, OT

Sensory Stimulating Activities



Credit: Vortex and Monica Slanik, OT

Sensory Stimulating Activities



Credit: Vortex and Monica Slanik, OT

Sensory Stimulating Activities

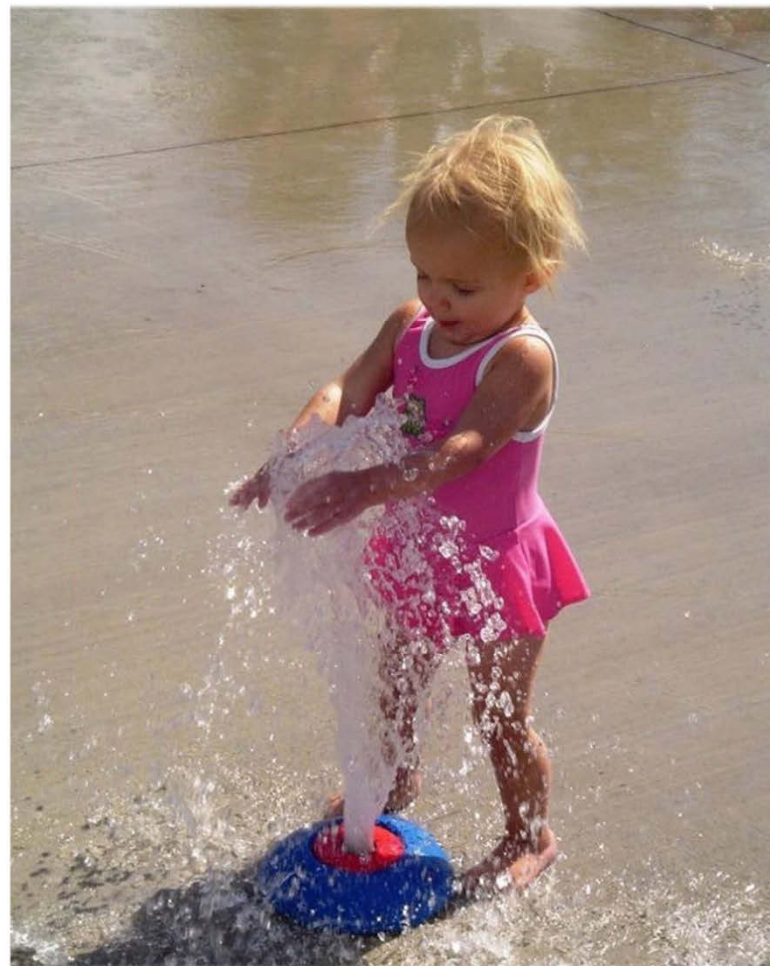

Credit: Vortex and Monica Slanik, OT

Water Spray Feature Examples



City of Kelowna **Quilchena Park**

- Small splash pad approximately 2,000 square feet
- 5 above ground elements
- Activation button with water on timer to reduce waste
- Seasonal hours of operation



Water Spray Feature Examples



City of Langford **Veteran's Park**

- Small splash pad approximately 500 square feet
- 4 above ground elements
- 3 ground sprays
- Poured in place rubber surface
- Activation button with water on timer to reduce waste
- Seasonal hours of operation



Water Spray Feature Examples



City of Victoria

Beacon Hill Park

- Small splash pad approximately 750 square feet
- 4 ground sprays
- Activation button with water on timer to reduce waste
- Seasonal hours of operation



Water Spray Feature Examples



Uptown

Centre Plaza

- Small splash pad approximately 1,000 square feet
- 15 ground sprays
- Mosaic tile surface
- LED lighting
- Seasonal hours of operation



Water Spray Feature Examples



District of Saanich **Beckwith Park**

- Medium sized splash pad approximately 3,250 square feet
- 4 above ground elements
- 12 ground sprays
- Activation button with water on timer to reduce waste
- Seasonal hours of operation

Water Spray Feature Examples



City of Richmond **Garden City Park**

- Organic water play area approximately 3,000 square feet over 50m long
- Custom built with boulders, rivers, dams and bridges
- Various activation methods with water on timer to reduce waste
- Water empties into nearby pond
- Seasonal hours of operation

Public Washroom Examples



CRD Parks

Galloping Goose Trail

- Small concrete block building
- Mens/Womens stalls
- Wheelchair accessible

Public Washroom Examples



District of Saanich **Beckwith Park**

- Large concrete block building
- Mens/Womens stalls and changing areas
- Wheelchair accessible



Public Washroom Examples



City of Kelowna **Gerstmar Park**

- Small custom building
- 2 Unisex stalls large enough for changing area
- Wheelchair accessible



Public Washroom Examples

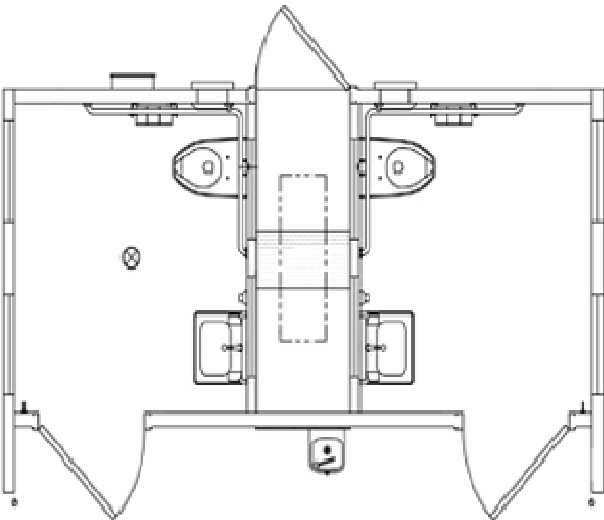

Pre-Manufactured **CXT Buildings**

- Many configurations available*
 - Siding options
 - Colour choices
 - Drinking fountain
- Easy maintenance
- Wheelchair accessible
 - ADA compliant (USA standard)
- Quick installation and buildings are delivered ready to use.

*Example shown here called Denali

Next Steps

- Today is just the starting point
- Survey will help determine needs and wants
- Assess community needs and wants
 - Who lives in walking distance, family ages (refer to 2011 Census)
 - School types nearby
 - Seniors residences – any cross generational opportunities
- Public Participation
 - What does this look like?
- Determine Location and Conceptual Design



Rutledge Park

Water Play Feature and
Washroom Building

Questions?
Contact Saanich Parks at
250-475-5522 or
parks@saanich.ca

