

Lambrick Park

CAMPUS RENEWAL PROJECT

Help us re-envision Lambrick Park Campus as a key community asset that meets the needs of our evolving community.

We want to hear from you!

ABOUT THE PROJECT

Lambrick Park serves the surrounding community with many open spaces and natural areas, the Gordon Head Recreation Centre, sports fields, courts, and many other recreation amenities. The Park is directly adjacent to Lambrick Park Secondary School and Gordon Head Middle School.

The purpose of the Lambrick Park Campus Renewal Project is to:

- Establish a long-term vision for the future of the Park.
- Modernize and expand recreation amenities.
- Improve accessibility and safety for all users.
- Enhance connectivity to surrounding areas.
- Support a growing and diverse community, and.
- Promote environmental stewardship.

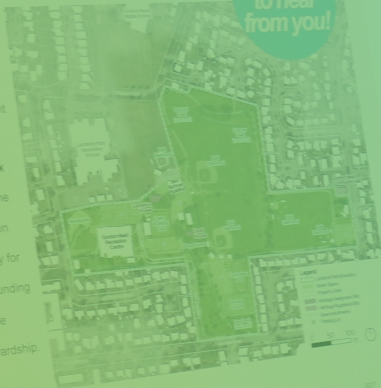

PROJECT PROCESS AND TIMELINE

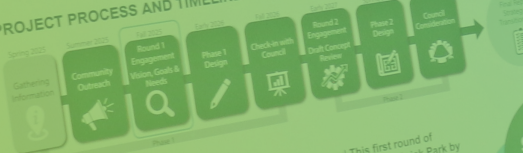

GOALS FOR TODAY

We are in an active engagement phase, and want to hear from you! This first round of engagement focuses on establishing the vision, goals, and needs for Lambrick Park by evaluating the opportunities and constraints of the area. Your input will be summarized and integrated into the design stage in Phase 2.



Lambrick Park

CAMPUS RENEWAL PROJECT

Territorial Acknowledgement

The District of Saanich is within the territory of Ləkʷəŋən peoples known today as Songhees and Xʷsepsəm (Kosapsum) Nations, and the ƱSÁNEĆ peoples, represented today by the ƱJOŁEŁP (Tsartlip), BOKÉĆEN (Pauquachin), SƆÁUTƱ (Tsawout), ƱSIKEM (Tseycum) and MÁLEXEŁ (Malahat) Nations. The First Peoples have been here since time immemorial and their history in this area is long and rich.

The District of Saanich is proud that our name is derived from the ƱSÁNEĆ peoples. Saanich Council is committed to taking a leadership role in the process of healing wounds of the past and becoming a more just, fair and caring society.

Lambrick Park Campus Renewal Project What We Heard Report

The Lambrick Park Campus Renewal Project was developed with significant support and input from multiple departments within the District of Saanich.

Prepared Winter 2026 by: **DIALOG**

Navigating this Report

Phase 1 Engagement for the Lambrick Park Campus Renewal project was comprehensive and wide-ranging, offering multiple formats and methods for participation. This *What We Heard Report* is organized into the following sections:

1.0 What's Going On

Provides an overview of the project, including goals and objectives, the planning process, and contact information for questions or feedback.

2.0 What We Did

Outlines each engagement event and method used during Phase 1, along with the number of inputs received. This section is organized by volume of input rather than chronological order.

3.0 Who We Heard From

Presents a demographic summary of respondents who completed the online questionnaire.

4.0 What We Heard

Summarizes quantitative findings from each engagement event and method, including sentiment analysis. Like Section 2.0, it is organized by number of inputs received rather than chronologically.

5.0 Key Themes

Explores overarching themes that emerged across all engagement activities and provides qualitative context to support the sentiment analysis.

6.0 Next Steps

Outlines the upcoming stages of the planning process and how public input will continue to inform the project.

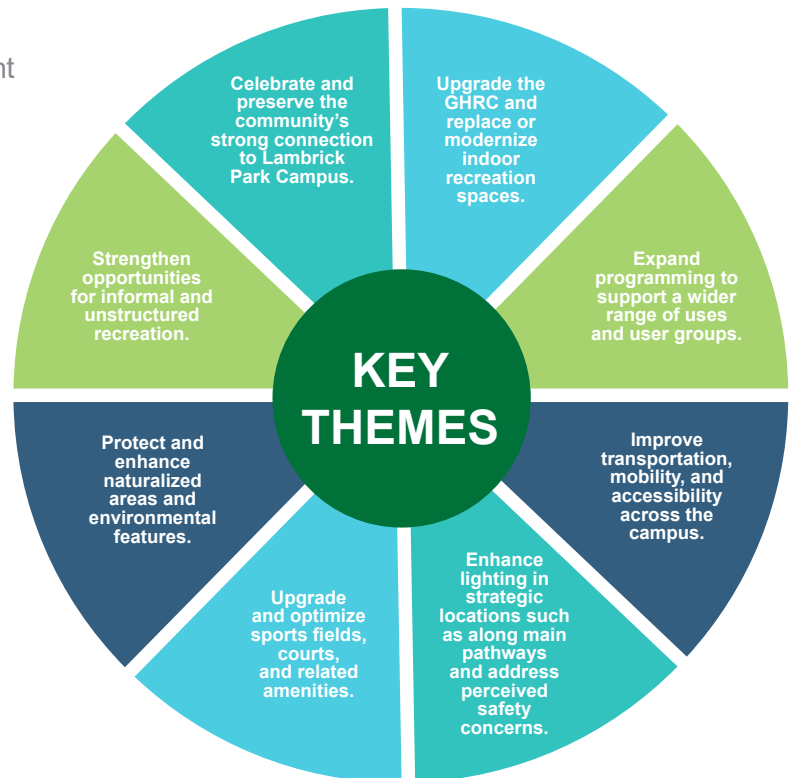

Contents

1.0

What's Going On 1

- 1.1 About the Park 2
- 1.2 Planning Process 4

2.0

What We Did 5

- 2.1 Promotional Activities & Outreach 6
- 2.2 Engagement Activities 7
 - 2.2.1 Online Questionnaire 8
 - 2.2.2 Open House 8
 - 2.2.3 Family Day Pop Up 9
 - 2.2.4 Gordon Head Recreation Centre Pop Up 9
 - 2.2.5 Youth Pop Up 9
 - 2.2.6 Older Adult (55+) Pop Up 10
 - 2.2.7 Virtual Information Sessions 10
 - 2.2.8 Rec Centre Service Providers Workshop 10
 - 2.2.9 District Staff Workshop 11
 - 2.2.10 Sports User Groups 11
 - 2.2.11 Adult Aquafit Pop Up 11
 - 2.2.12 Correspondence 11
 - 2.2.13 1:1 Interviews 11
- 2.3 Engagement Activity Summary by Participation Level 11

3.0

Who We Heard From 12

- 3.1 Questionnaire Demographics 14

4.0

What We Heard 17

4.1	Engagement Even Feedback Summaries	18
4.1.1	Online Questionnaire	18
4.1.2	Open House	22
4.1.3	Family Day Pop Up	27
4.1.4	GHRC Pop Up	28
4.1.5	Youth Pop Up	28
4.1.6	Older Adult (55+) Pop Up	31
4.1.7	Virtual Information Sessions	32
4.1.8	Rec Centre Service Providers Workshop	33
4.1.9	District Staff Workshop	34
4.1.10	Sports User Groups	35
4.1.11	Adult Aquafit Pop Up	37
4.1.12	Correspondence	37

5.0

Key Themes 38

6.0

Next Steps 51

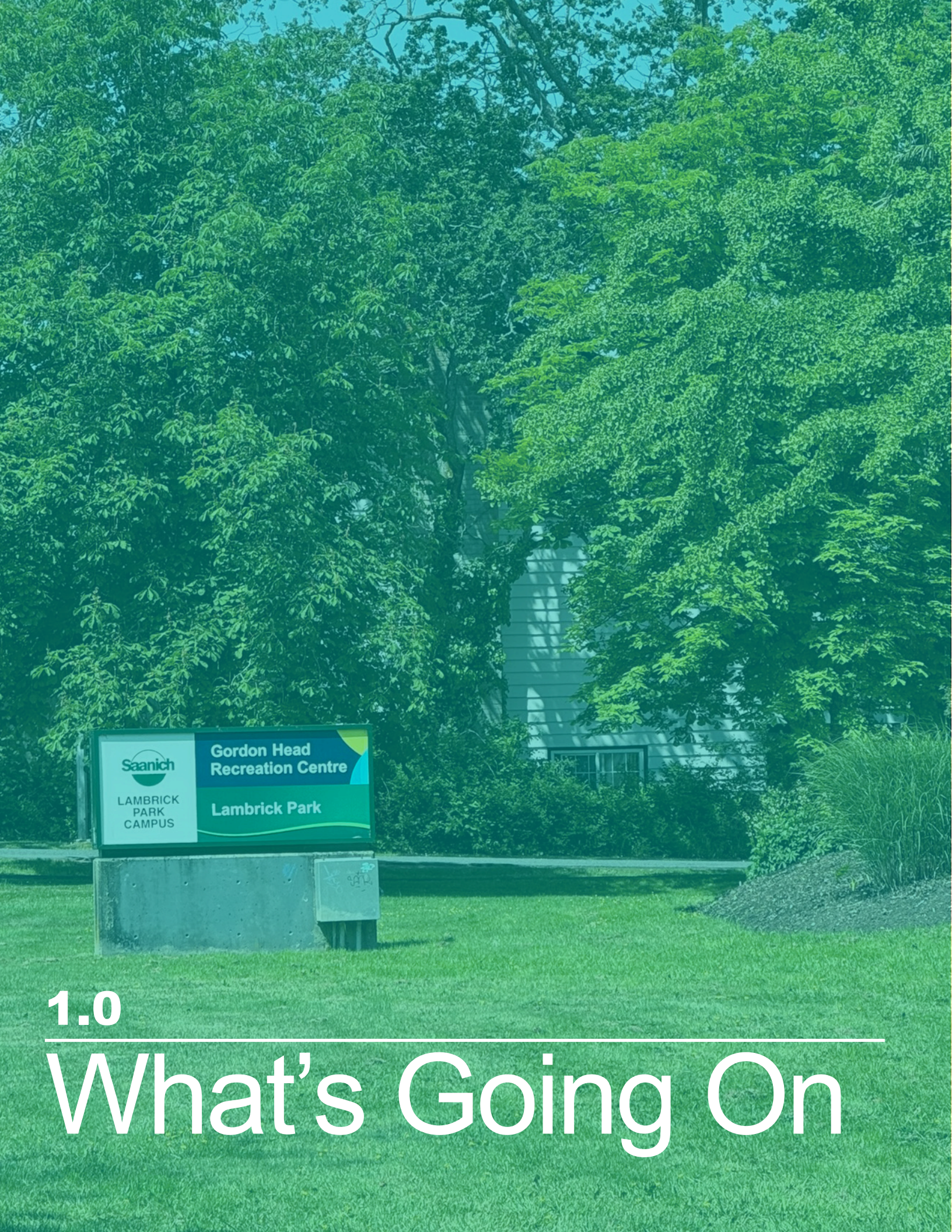

1.0

What's Going On

The District of Saanich’s Parks, Recreation, and Community Services (PRCS) Department is working with DIALOG for the future renewal of the Lambrick Park Campus. This report aims to summarize what we heard from park users, community members and District staff during Round 1 of engagement.

1.1 About the Park

Lambrick Park Campus (Map 1) serves as an important sports, recreation, and community space for residents both District-wide and within the region. The park is a diverse site with not only sports and physical recreation amenities, but also serves as space for youth groups, cultural programming and more.

Lambrick Park Campus serves the surrounding community with:

- » **Open spaces and natural areas**
- » **Gordon Head Recreation Centre**
- » **Sports fields**
- » **Park maintenance buildings**
- » **Ancillary facilities**

The Park also serves as an important amenity to Lambrick Park Secondary School and Gordon Head Middle School.

While the park currently serves a variety of purposes, there is also opportunity for enhancement.

The District of Saanich is home to four recreation centres, all located within parks. These sites offer a multitude of amenities and activities – more of a “campus” feel, and certainly much more than your typical park! This shift from “park” to “campus” represents Lambrick’s importance as a community gathering space.

Goals of the Project

1. Establish a long-term vision for the future. 
2. Modernize and expand recreation amenities. 
3. Improve accessibility and safety for all users. 
4. Enhance connectivity to surrounding areas. 
5. Support a growing and diverse community. 
6. Promote environmental stewardship. 

MAP 1
Context

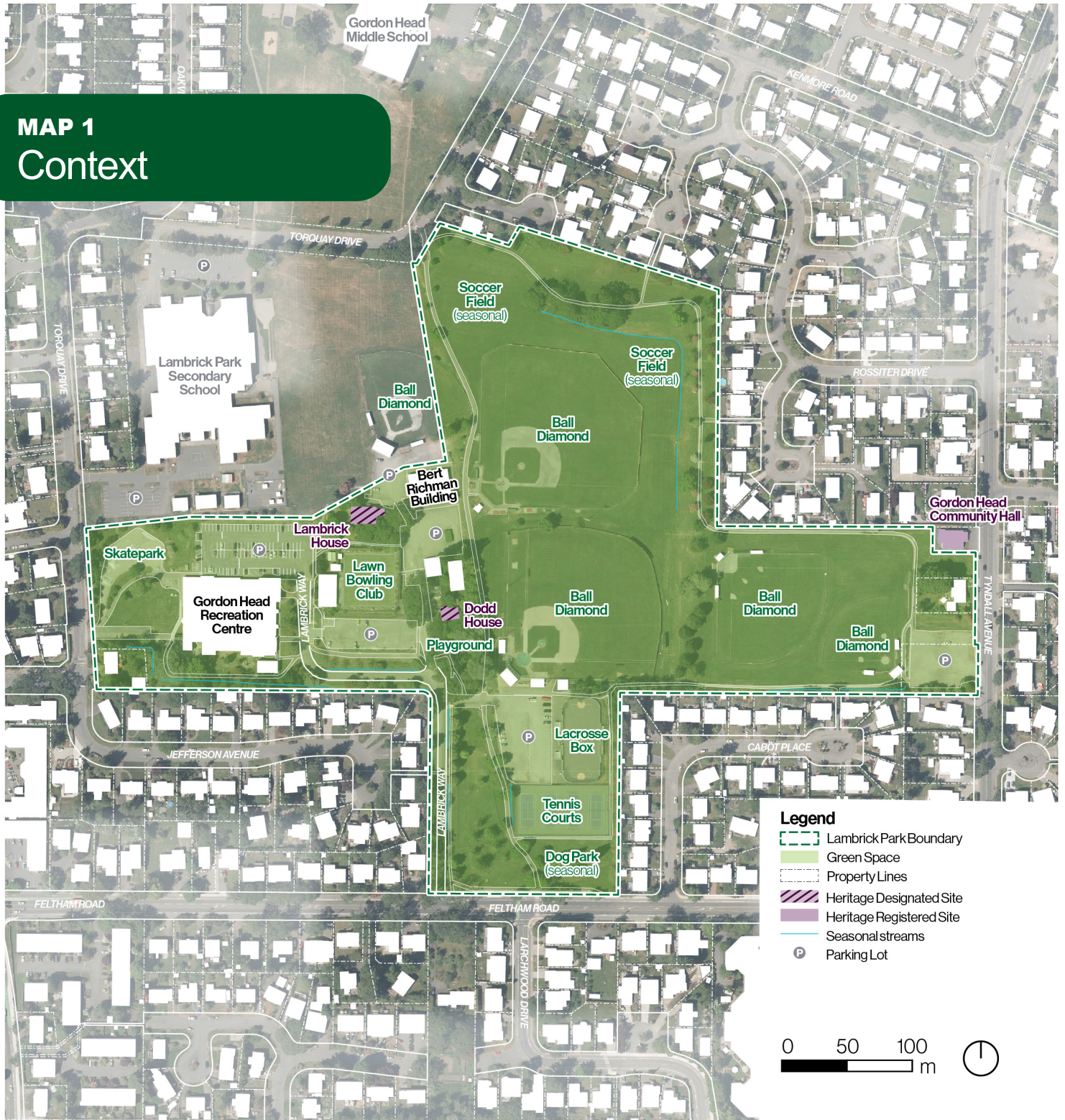

1.2 Planning Process

The planning and concept design process will help the Project Team understand the area and its context, community needs, programming options, financial strategies, and phasing approaches to transform Lambrick Park into a vibrant destination for a growing and evolving community. This report presents a summary of the findings of Round 1 Engagement, which aimed to understand the context of the park, the opportunities and constraints, and the vision, goals and needs of community members.

The engagement input contained in this document will be integrated into the Phase 1 design and will inform how to approach future engagement in Phase 2.

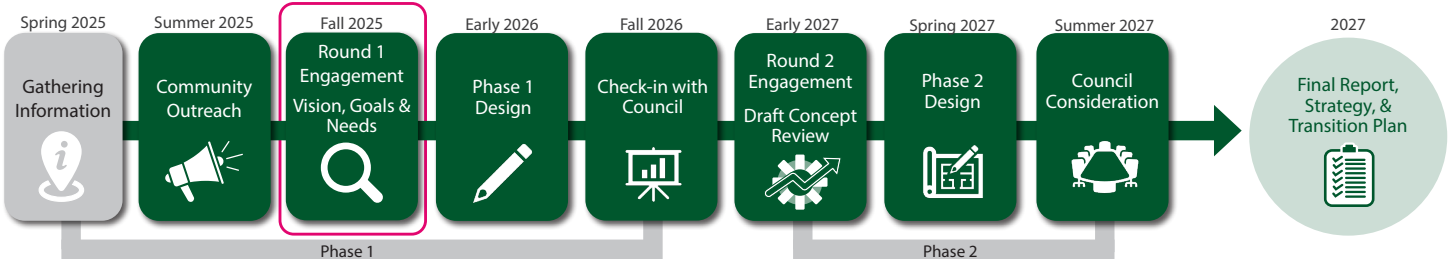

Methods of engagement in Round 1 included:

- Online Questionnaire
- Open House
- Pop Ups
- Drop In Sessions
- Virtual Information Sessions
- Staff Workshops
- Group Meetings
- Correspondence
- 1:1 Interviews

To summarize the community's needs and vision for the future, key themes have been identified within the engagement input. While every perspective is valued, some pieces of input were omitted if they were inappropriate, disrespectful, or offensive.





2.0

What We Did

The following section summarizes promotional activities, outreach and engagement events that took place during the Phase 1 engagement, which took place from September 2025 to January 2026.

2.1 Promotional Activities & Outreach

To support the project launch and generate early interest in the upcoming engagement activities, a coordinated outreach campaign began in mid September 2025. Initial efforts included an update to the District of Saanich website, the development of the Hello Saanich project website (the District's online participation platform), and the issuance of a media release.

These foundational actions were followed by a series of additional Phase 1 promotional activities, which included:

- Targeted email notifications sent to project followers on Hello Saanich
- Multiple posts on the District of Saanich's Facebook page and the PRCS Department's Facebook / Instagram accounts
- Paid Facebook advertisements that ran Saanich-wide for three weeks
- Two advertisements in the Times Colonist Sunday edition
- Two advertisements in Saanich News
- Community posters and rack cards distributed at GHRC and other recreation centres
- Signage throughout the park and other parks throughout Gordon Head
- Features in the Saanich Spotlight and Rec Matters email newsletters
- A listing in the Saanich Recreation Activity and Program Guide
- Ongoing website updates

Additional media coverage supported the campaign. Saanich News published an online article on October 23, 2025 summarizing the project and outlining opportunities for input during Phase 1. CHEK News ran a story on December 30, 2025, followed by another article in Victoria News on January 9, 2026.

Overall, the project received strong attention, with more than **2,171 unique visitors** to the Hello Saanich project page during the Phase 1 engagement period.

Saanich invites public input on future of Lambrick Park Campus

Published 12:45 pm Thursday, October 23, 2025

By Olivier Laurin



Community imagines future of Lambrick Park, and many people hope it's on ice

by Jordan Cunningham
December 30, 2025 5:33 pm



Saanich is renewal p

Lambrick Park renewal project aims to transform the aging Saanich hub

Published 5:30 am Friday, January 9, 2026

By Olivier Laurin



5/6
Swipe or click to see more

The Gordon Head Recreation Centre opened in 1971 and rapidly became a community, recreational and sport hub for the community. (Olivier Laurin/Saanich News)

2.2 Engagement Activities

The following activities are organized in order of the number of participants, rather than by chronological order. A table summarizing the activities and participants is included at the end of this section.



2.2.1 Online Questionnaire

An online questionnaire was hosted on the District of Saanich’s online participation platform from October 21, 2025, to December 6, 2025. For those who preferred to fill out a hard copy, a printed copy was made available. A total of **390 community members** filled out the online questionnaire, including eleven hard copies.

The questionnaire was unique in its ability to capture more quantitative information regarding demographics, frequency of visits, seasonal changes, and popular sentiment about areas throughout the park. Key themes are explored in Section 3.

2.2.2 Open House

A project-specific public Open House was held on November 22, 2025. The event was held at the Gordon Head Middle School just north of the park. This event hosted **150+ attendees**.

The goal of the Open House was to inform the community about the project, gather context on the park, and understand the broader goals of the community. Visitors to the Open House were invited to share their experiences with answers to various prompts and questions.

Answers were captured via sticky notes and dots on large, printed boards. Over the course of the event, participants left **370+ comments and ideas**, which have been analyzed and incorporated into the Key themes in Section 3.



2.2.3 Family Day Pop Up

On February 16, 2026 the Family Day Arts Festival invited kids of all ages to imagine what the park might look like in the future. Using a variety of art supplies such as markers, stickers, pompoms, popsicle sticks, magazine cutouts, they were able to create a personal vision for the park's future. **Nearly 100 people** shared their vision for what they hope to see for the future of Lambrick Park Campus.



2.2.4 Gordon Head Recreation Centre Lobby Pop Up

On November 20, 2025, a partially staffed, informal pop-up was held in the Lobby of the Gordon Head Recreation Centre (GHRC). The pop-up included display panels that introduced the project, shared information about additional engagement opportunities, and invited people to share about their experiences and vision for the future of Lambrick Park Campus. The pop-up also directed participants to complete the online questionnaire through a QR code included on a rack card handout. These materials remained in the lobby throughout the day and were designed to be self-facilitated, so the number of participants for this activity is unknown. By the end of the afternoon, the boards were filled with ideas and **40+ post it notes**.



2.2.5 Youth Pop Up

A pop-up event was held on November 20, 2025, in the "Backdoor" Youth Centre at GHRC to engage with youth in the area. This was an opportunity to chat with young people about the park renewal project in a way that would resonate with them, and to demonstrate the value of their perspectives. There were **~30 participants** at this event. The youth that stopped in were also encouraged to think outside of the box and tell us their "BIG idea" for Lambrick Park by describing it or drawing it out on a sheet.

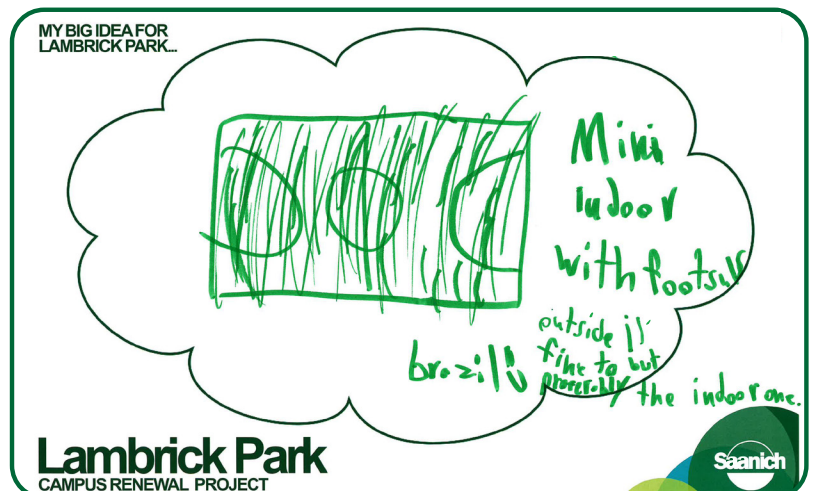

2.2.6 Older Adult (55+) Pop Up

A pop-up event was held on November 20, 2025 during the 55+ Social Drop In at the GHRC, to engage older adults in the community. About **20 individuals** over the age of 55 attended this session. The event served as an informational session and gave the Project Team an opportunity to understand older adults' relationships with Lambrick Park Campus.

2.2.7 Virtual Information Sessions

Two Virtual Information Sessions – one afternoon and one evening – were held online by invitation on November 27, 2025, for those who could not attend the in-person Open House event. A total of **11 people participated** across both sessions. The prompts and format were identical to the questions and activities used for the Open House. Where the in-person Open House asked participants to use sticky notes and dots to engage with the activities, the Virtual Information Sessions guided participants to use the online application Miro to share their perspectives.

2.2.8 Rec Centre Service Providers Workshop

A Rec Centre Service Providers Workshop was held on January 16, 2026 for those who were unable to attend the previous sessions. A total of **9 people participated** in this session, with representation from Kids Club, Lambrick Park Preschool & Childcare, Saanich Neighbourhood Place, BC Muslim Association, The Cridge Centre for the Family Brain Injury Services (Second Chance Café, and Victoria Nature School. Several health service providers were invited but unable to attend.

Lambrick Park

CAMPUS RENEWAL PROJECT

Help shape the future of Lambrick Park!

We want to hear from you about the future vision, goals and programming for Lambrick Park.

Online Info Sessions with Q&A

Thursday November 27, 2025
 Noon - 1:30 pm, 7:00 pm - 8:30 pm

Register online:
Saanich.ca/hellolambrick

Open House

November 22, 2025
 Noon - 4:00 pm

Gordon Head Middle School

Online Survey

Now - December 6, 2025

Stay informed!
 Scan the QR code to take the survey.
Saanich.ca/hellolambrick

2.2.9 District Staff Workshop

On December 5, 2025, an internal workshop was held for District of Saanich staff from various departments. In total, **18 people** attended this session – including managers and select staff in PRCS (including other Rec Centres) and Planning.

2.2.10 Sports User Groups Workshop

A Sports User Focus Group was held on November 20, 2025. There was a total of **15 attendees** at this event, with representation from Gordon Head Lawn Bowling, Gordon Head Baseball Association (and Seawolves), Maria Montessori Academy, Victoria Eagles Baseball Club, Eves of Destruction Roller Derby, Victoria Marmots Roller Hockey and South Island Tennis League. This included Home User Groups; other groups that regularly or occasionally book facilities in the park; and groups that have interest in more access to park spaces.

Those who were unable to attend the event were invited to provide written input and were also directed to the online questionnaire.

2.2.11 Adult Aquafit Pop Up

A pop-up session was held on December 5, 2025, for older adults (aged ~55+) that participate in the aquafit classes at GHRC. This session took a more informal discussion approach, with a small gathering of approximately **15 people** in the lobby of GHRC.

2.2.12 Correspondence

Throughout Phase 1, emails were welcomed through a project specific email address which was included on the project website and other engagement materials. **14 emails** were received throughout Phase 1.

2.2.13 1:1 Interviews

In addition to the methods listed previously, the project team had **several one-to-one meetings** with interested audiences and potential project partners. This occurred throughout Phase 1 and the themes of these conversations were consistent with general engagement themes.

2.3 Engagement Activity Summary by Participation Level

The following table outlines the engagement activities undertaken in Phase 1, the date when they occurred and the number of people who participated in each. They are organized by the number of people who participated in them rather than chronological order.

Engagement Activity	Participation
Online Questionnaire	390
Open House	150
Family Day Pop Ups	100
GHRC Lobby Pop Up	41
Youth Pop Up	30
Older Adult (55+) Pop Up	20
Virtual Information Sessions	9
Rec Centre Service Providers Workshop	11
District Staff Workshop	18
Sports User Group	15
Adult Aquafit Pop Up Session	15
Correspondence	15
1:1 Interviews	Several
TOTAL ENGAGED ~815	



Notes

Whole	Half	Quarter	Eighth	Sixteenth

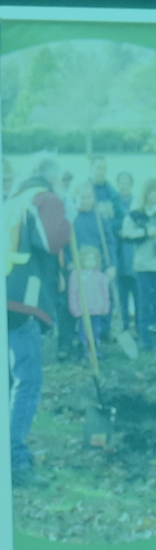

Discover the scenic surroundings and incredible views of our parks are used in many ways. We have over 160 parks covering more than 760 hectares to explore, and there's still more to grow.

Working in partnership with the community, our goal is to improve the quality of life through diverse lifestyles and protect our natural environment.

These parks are

Pa

3.0

Who We Heard From

WHO WE HEARD FROM

At the start of the project, the project team developed an audience registry that outlined all groups the project planned to engage with, their anticipated areas of interest, the projected timing of their involvement, and the approaches best suited to reach them. The registry covered both internal (District of Saanich) and external audiences and placed particular emphasis on identifying methods to connect with groups that are not often represented in public engagement processes. This helped the team consider not only who needed to be involved, but also how to create conditions that would make participation more accessible and meaningful for seldom heard communities.

The registry is intended to be a living tool. It will be reviewed and refined at the outset of the next phase of engagement, building on lessons learned from Phase 1. This will include incorporating learnings about which outreach tactics resonated, which audiences were more challenging to reach, and where additional efforts or adjustments may be valuable.

Demographic information was not collected during in person or virtual events. Following the District of Saanich's standard protocol, demographic questions were included only in the online questionnaire. As a result, the demographic profile presented in this report reflects only what we know about the participants who completed the questionnaire, rather than the full set of individuals who took part in the broader engagement activities.



3.1 Questionnaire Demographics

The first demographic question asked people about their place of residence. 351 people chose to answer this question. The majority (55%) of respondents lived in Gordon Head.

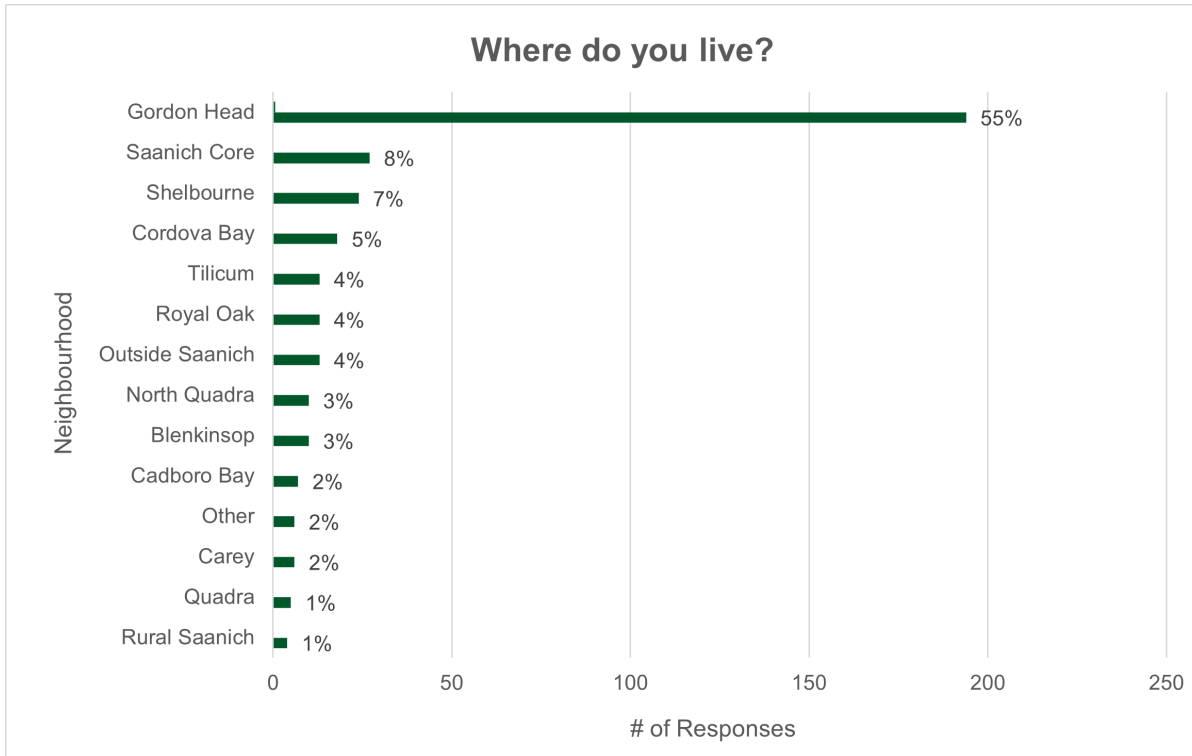

The highest amount of participants (26%) were between the ages of 35-44 years old, followed by those aged 45-54 years old at 22%. Respondents under the age of 24 did not seem to connect with the questionnaire format, as they only made up about 3% of responses.

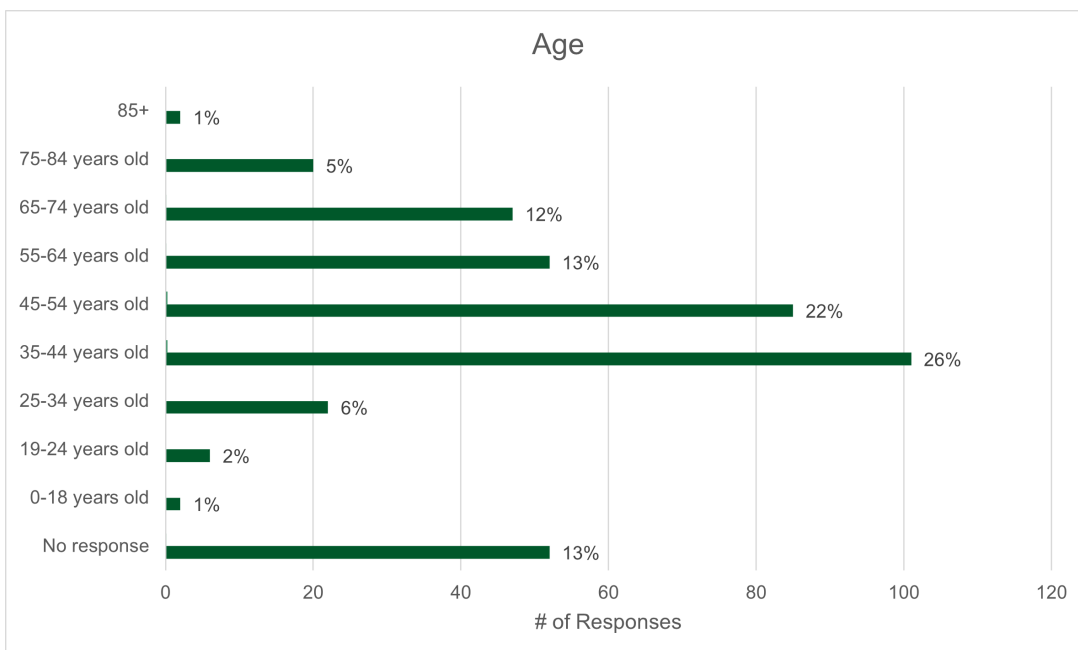

WHO WE HEARD FROM

Of the 392 participants who completed the questionnaire, nearly half (49%) identified as female.

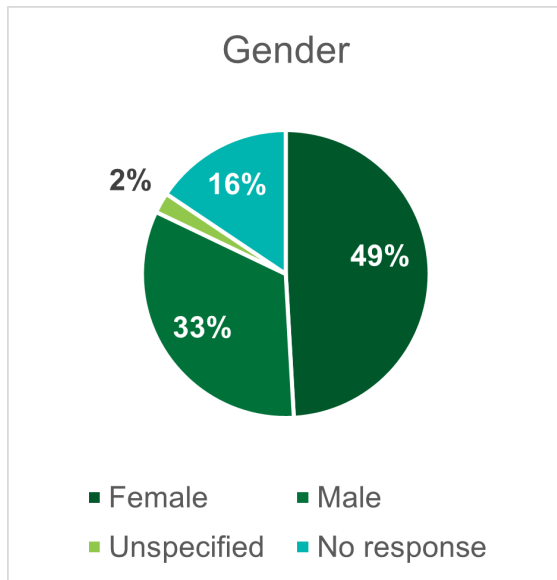

Respondents were able to choose multiple options when sharing their connection to Lambrick Park Campus. The majority use the GHRC (72%) or live nearby (69%). Many also visit for informal recreation (61%) or take part in sports on the fields, courts or greens (53%). Fewer attend programs or events (44%), work or volunteer in the area (17%), or selected "other" (9%).

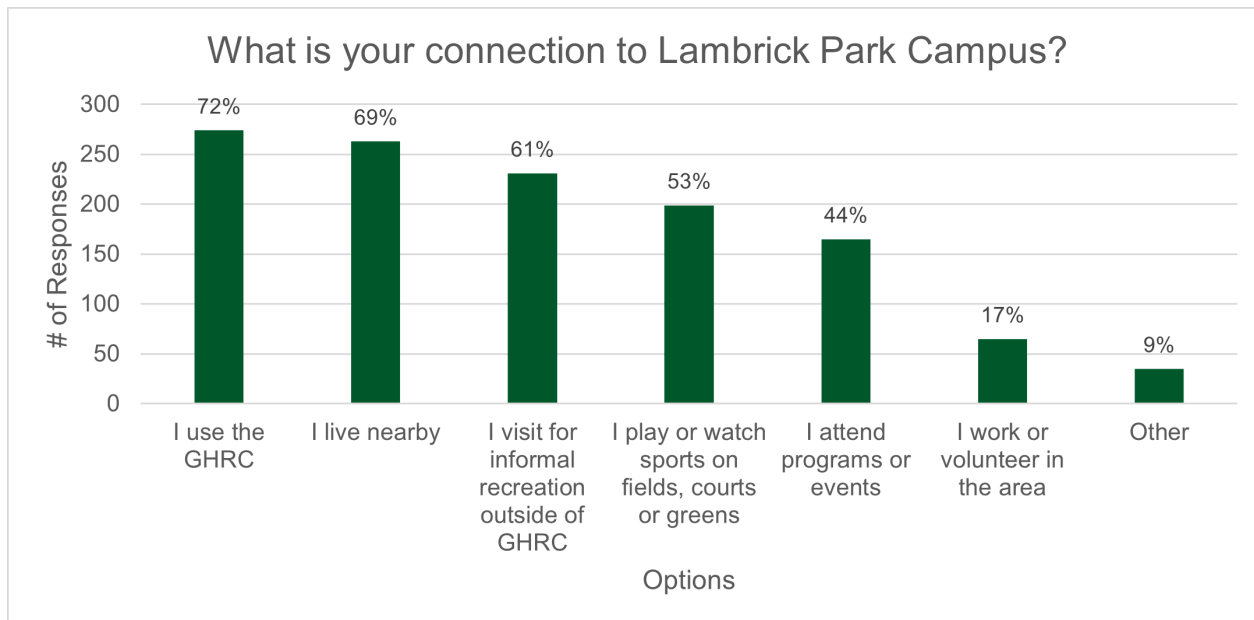

Almost 50% of respondents visit the park weekly, and 26% visit daily.

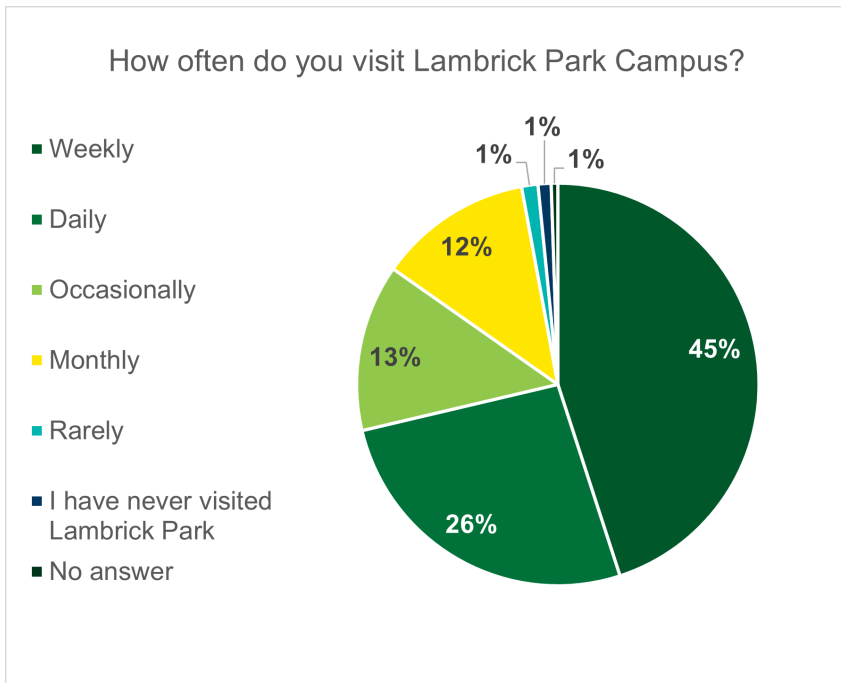

Over 60% of respondents spend roughly an hour in the park (and/or recreation centre) during most of their visits. Roughly 30% of respondents spend several hours (generally meaning two or more), while about 15% of users will spend 30 minutes here.

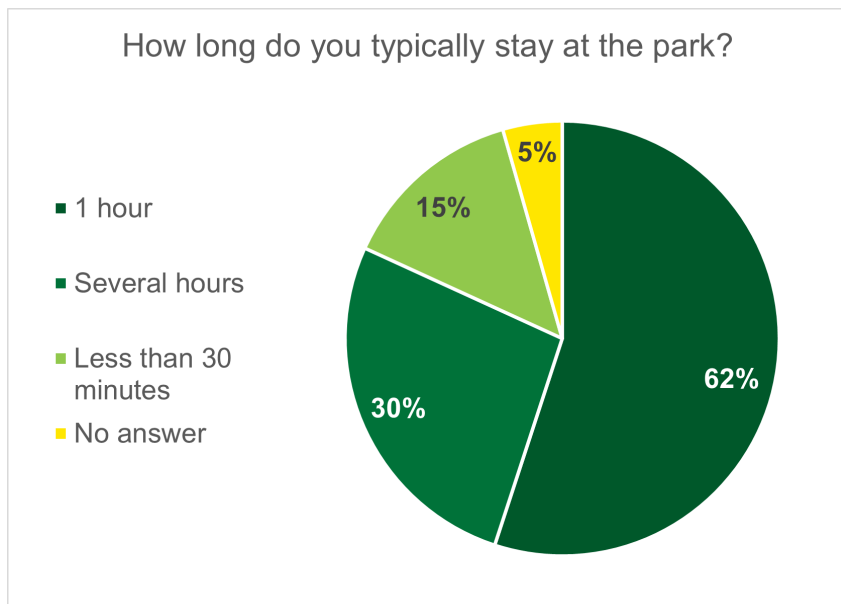

4.1 Engagement Event Feedback Summaries

This section summarizes the feedback we received through each individual engagement type. These are organized, as in Section 2, by the number of people who participated rather than the chronological order.

4.1.1 Online Questionnaire

In addition to the demographic questions outlined in Section 2, participants were asked questions about how they use the park, their favourite spaces and what they appreciate and also where they saw opportunities for improvement. The following text summarizes responses.

How people use Lambrick Park Campus

- Most respondents used Lambrick Park Campus on a **weekly (45%) or daily (26%) basis**.
- Visitors to the park mostly stayed approximately **1 hour (59%), followed by people who stayed several hours (29%)**. Only 15% stayed less than half an hour.
- In colder, wetter months, many people reported using more than one mode of travel. Among all responses, **83% indicated arriving by car** (72% as a driver and 10.5% as a passenger), 40% reported walking, and 23% reported cycling. Only 3% said they arrived by bus.
- In warmer, drier months, this pattern shifted. The share of respondents who selected car dropped to 66% (57.5% as a driver and 8% as a passenger), while selections for **cycling increased to 35% and walking also rose to 49%**. Bus arrivals remained steady at 3%.

Questionnaire Prompts

1. **What is your connection to Lambrick Park Campus?**
2. **How often do you visit Lambrick Park Campus?**
3. **How long do you typically stay at the park?**
4. **How do you typically travel to the park in the cooler, wetter months (October-February)?**
5. **How do you typically travel to the park in the warmer, dryer months (March-September)?**
6. **What do you appreciate most about Lambrick Park Campus today?**
7. **Where is your favourite place on the Lambrick Park Campus?**
8. **What challenges or barriers have you experienced with using the site?**
9. **Are there areas that feel difficult to access or navigate?**
10. **Which areas do you feel are underused or could be better activated?**
11. **Do you have ideas or suggestions for how Lambrick Park Campus could better serve the community in the future?**
12. **How do you prefer to be engaged?**

Favourite places & what people appreciate

- Many participants reported that they appreciated many features of Lambrick Park Campus. **Top selections included the Recreation Centre and its programs (62%), informal recreation opportunities such as walking, or play (57%), activities on sports fields and courts (49%), natural areas (35%).** The least selected feature was heritage values (5%).
- The following map shows the points that people selected when asked about their favourite spaces – nearly all areas of the Park were selected! However, there were focused areas of dots on the Recreation Centre and the Gary Oak Meadow and pathway at the north of the Campus.

MAP 2
Favourite Places

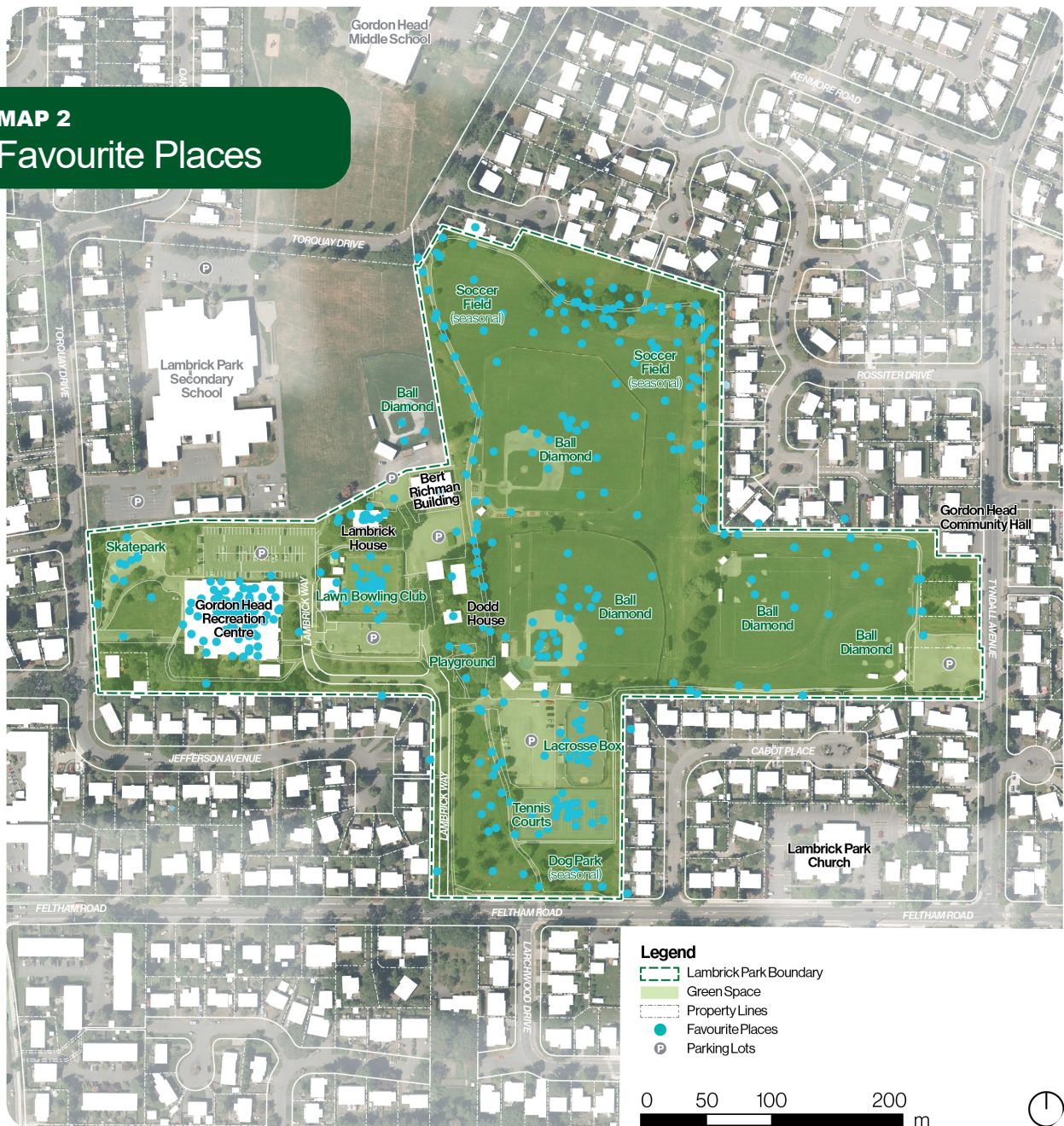

Opportunities for improvement

- When asked about what barriers people have experienced when using the site, **the top selected answer was that they did not experience any (35%)**. For those that did experience challenges or barriers, **76% of answers related to high demand** (programs filling up quickly (28%), parking availability (26%), and events of facilities are too busy (22%)).
- The following map shows areas that people felt were difficult to access or navigate. The key spots identified were the Recreation Centre, the Bert Richman Building, the playground and the skatepark.

MAP 3
Opportunities for Improvement



Underused Areas/ Benefit from Activation

While Lambrick Park Campus is highly appreciated across the community, engagement has provided insight into the opportunities for change and improvements. The Key Themes in Section 5.0 highlight those opportunities.

- Spaces that feel underused or could be better activated included outdoor sports fields and courts (32%), open green spaces (29%), indoor recreation spaces (23%) and natural areas (22%).



4.1.2 Open House

The open house asked for feedback in a variety of different formats. Some of this included quantitative methods (post it notes, sticky dots, mapping and big ideas sheets), while other was qualitative (one-to-one conversations with staff and facilitators). The following section outlines the key learnings from the quantitative feedback, which aligned with the key themes from the one-to-one conversations staff and facilitators had with participants.

Key questions were asked of participants around relationship to the site, what was valued, mobility and connectivity, sports fields and courts, Gordon Head Recreation Centre, Informal Uses, Natural Areas and Big Ideas for the Future. Many sticky notes that were placed on specific boards related to general themes, or had applicability to multiple questions.

There was strong and consistent messaging around preserving Lambrick Park Campuses natural spaces (**52 mentions**). The unpaved perimeter trail stands out as one of its most cherished features with daily and multi-generational use.

GHRC is widely viewed as over capacity, with many calls for expanded aquatics, fitness, and multi use indoor sport spaces (**22 mentions**). The idea of an ice rink is the most polarizing issue (**63 mentions**), generating both strong support and strong opposition. Families consistently express the need for improved play spaces, including safer and larger playground areas and water play features. Many participants also emphasize opportunities for naturalization, biodiversity, and community gardens as important directions for the future. Lighting (**17 mentions**), safety (**23 mentions**), and mobility concerns appear repeatedly, particularly around path illumination, bike–pedestrian conflicts, and safer access points. Additionally, the Lambrick Park Preschool (**16 mentions**) was highlighted as a highly valued community asset with strong support for its continued presence.



Open House Board Prompts

1. What do you appreciate most about the park today?
2. Where are your favourite spaces?
3. Where do you feel welcome or unwelcome?
4. What spaces need improvement?
5. What is your vision for the park in 15 years?
6. How do you typically travel to the park?
7. What would make it easier for you to access and physically navigate the park and its amenities?
8. What improvements would you like to see to the sport's fields, courts and supporting facilities?
9. What improvements would you like to see to the GHRC?
10. Where do you see opportunities for naturalization in the park?
11. How do you use unprogrammed areas of the park? What are the opportunities to better support informal recreation?
12. What is your big, bold idea for the renewal of the park?



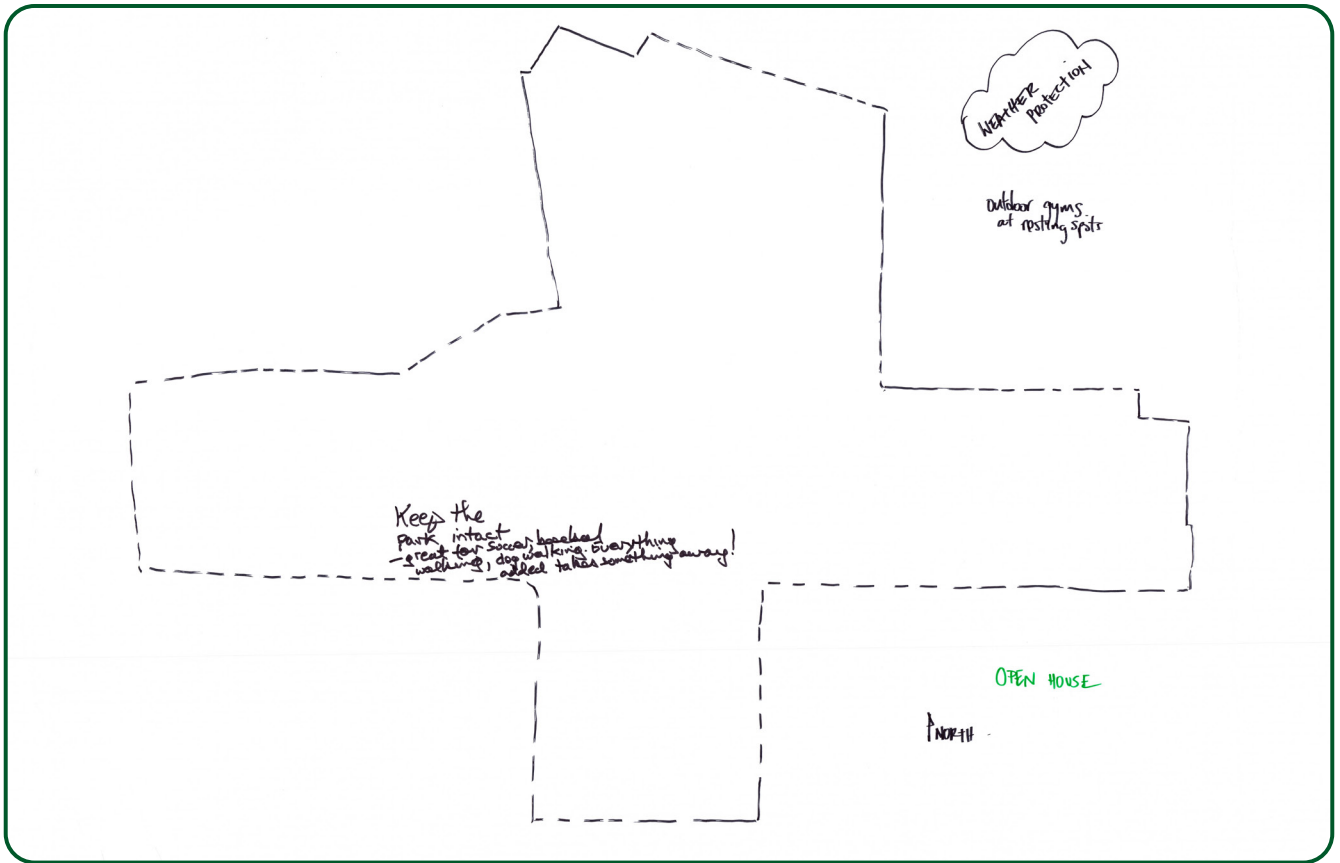

4.1.3 Family Day Pop Up

Creativity was abound at the Family Day Pop Up! Visual responses included drawings and multi-media collages. Key themes in the visual responses included outdoor formal and informal sports, play structures, wildlife (images of deer and birds) and greenspace (images and drawings of flowers, trees, lawns).

There were also 44 sticky notes shared by accompanying adults and older children on a Vision for Lambrick Park board. The two most frequently mentioned ideas included references to a pool (**10 mentions**), a splash park/water park (**5 mentions**), and an improved playground (**6 mentions**).



Art Activity Prompt

What do you want to see at Lambrick Park in the future?

Create your vision for Lambrick park! Use crayons, markers, stickers, pompoms, popsicle sticks, or anything else you have on hand to show us what you want to see in Lambrick Park in the future.

Here are some ideas:

- Draw a picture
- Write a poem
- Create a collage using old magazines, stickers, or materials from outside!

Stay up to date!

For more information on the Lambrick Park Campus Renewal project, please visit www.saanich.ca/hellolambrick.



4.1.4 GHRC Pop Up

Many ideas were shared during a day-long pop up at the Gordon Head Recreation Centre Lobby. Input received highlighted opportunities to improve circulation and access (**5 mentions**), a desire to retain existing services, and for expanded swim facilities. **Two comments** mentioned that they were confused by the term “Campus”.

Facilities and programs for children – including kindergym, preschool, swim lessons, and playground improvements emerged as a strong theme from this event. This was likely due to a kindergym program during the event. Overall, the conversations reflected a mix of practical suggestions, clarifying questions, and enthusiasm for strengthening the family oriented offerings at the site.

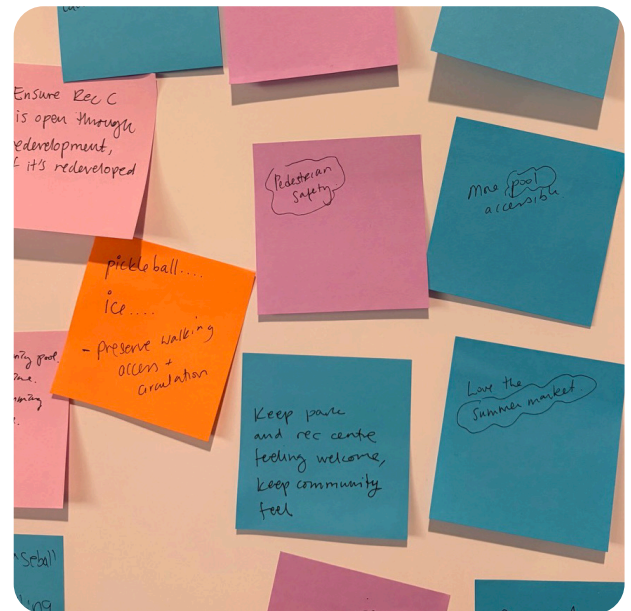

4.1.5 Youth Pop Up

Participants at the youth pop up worked on mapping their favourite spaces, sharing their big ideas for the future and drawing potential future layouts of the park. Of the input gathered from youth, the three most popular topics were:

- GHRC (enthusiasm for current programming and spaces, as well as desire for updates) (**33 mentions**)
- Sports fields, courts and amenities – with a strong focus on baseball and soccer (**29 mentions**)
- Informal recreation and open space such as a ‘funner playground’, a climbing wall or an improved skatepark (**22 mentions**)

One aspect that stood out from the rest of the engagement activities was the emphasis that youth placed on the need for improved play spaces at the park. Youth want to see the playground improved, either through expansion or adding an obstacle course. Finally, youth emphasized that for the campus to become a more attractive and fun place for younger community members, it needs more water-based activities. Suggestions included adding a splash pad, outdoor pool, and waterslides (**6 mentions**).

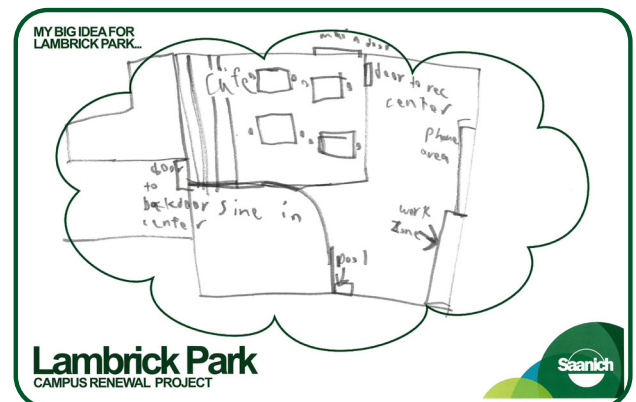
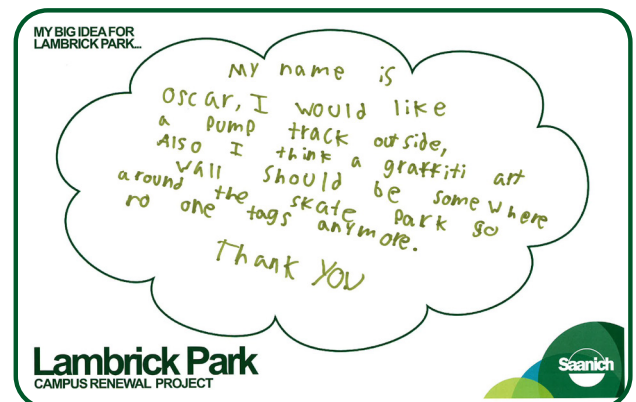

Big Ideas from the Youth Pop Up

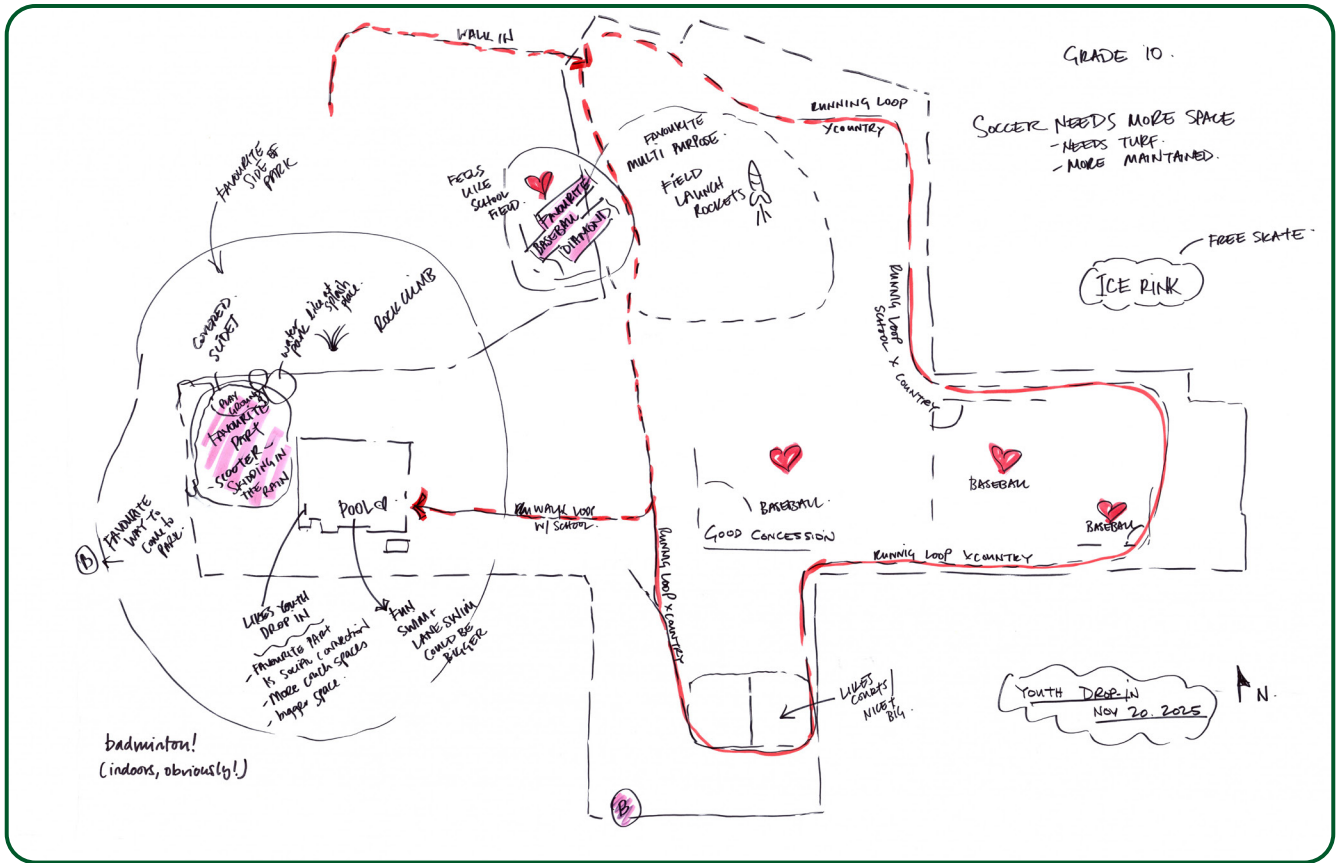

Big Ideas from Youth Pop Up

MY BIG IDEA FOR LAMBRICK PARK. Lowie

big playground with opsticle cores
 Skate park (Improved)
 coffe shop
 slide in pool
 Soccer field
 Mini indoor/out

Lambrick Park
 CAMPUS RENEWAL PROJECT

MY BIG IDEA FOR LAMBRICK PARK. Lillian-B

-baseball and softball
 -more Fields.
 trees-Concession
 -Lambrick park
 preschool
 -funner playground.

Lambrick Park
 CAMPUS RENEWAL PROJECT

MY BIG IDEA FOR LAMBRICK PARK. Lauren - GYMMS

Volleyball court!!!!!!
 for Gordon Head Middle school field?

Lambrick Park
 CAMPUS RENEWAL PROJECT

MY BIG IDEA FOR LAMBRICK PARK. Nina // Arbutus

hockey rim
 Physgromd
 Skate park
 Rec Centre

Lambrick Park
 CAMPUS RENEWAL PROJECT

4.1.6 Older Adult (55+) Pop Up

The participants in this session shared unique perspectives of the park (refer to map trace below). When asked what spaces they favoured, they mentioned spaces and activities that offer a sense of peace, quiet and calmness, such as using the lacrosse box/ball hockey court for Tai Chi on weekday mornings.

The group also advocated the need for accessible spaces and activities. Some participants shared that the north quadrant of the park is inaccessible to them because of a perceived lack of safety due to lack of lighting and “eyes on the street”. Other participants requested more recreation opportunities that cater to an older demographic, such as table tennis and older adult focused exercise classes. Another notable request was that GHRC be expanded with mobility issues and universal accessibility in mind, because some users found it currently challenging to maneuver.

Youth & Adult Pop Up Prompts

- Where are your favourite spaces?
- Where do you feel welcome or unwelcome?
- What spaces need improvement?
- What is your vision for the park in 15 years?

Map Trace from the Adult Pop Up

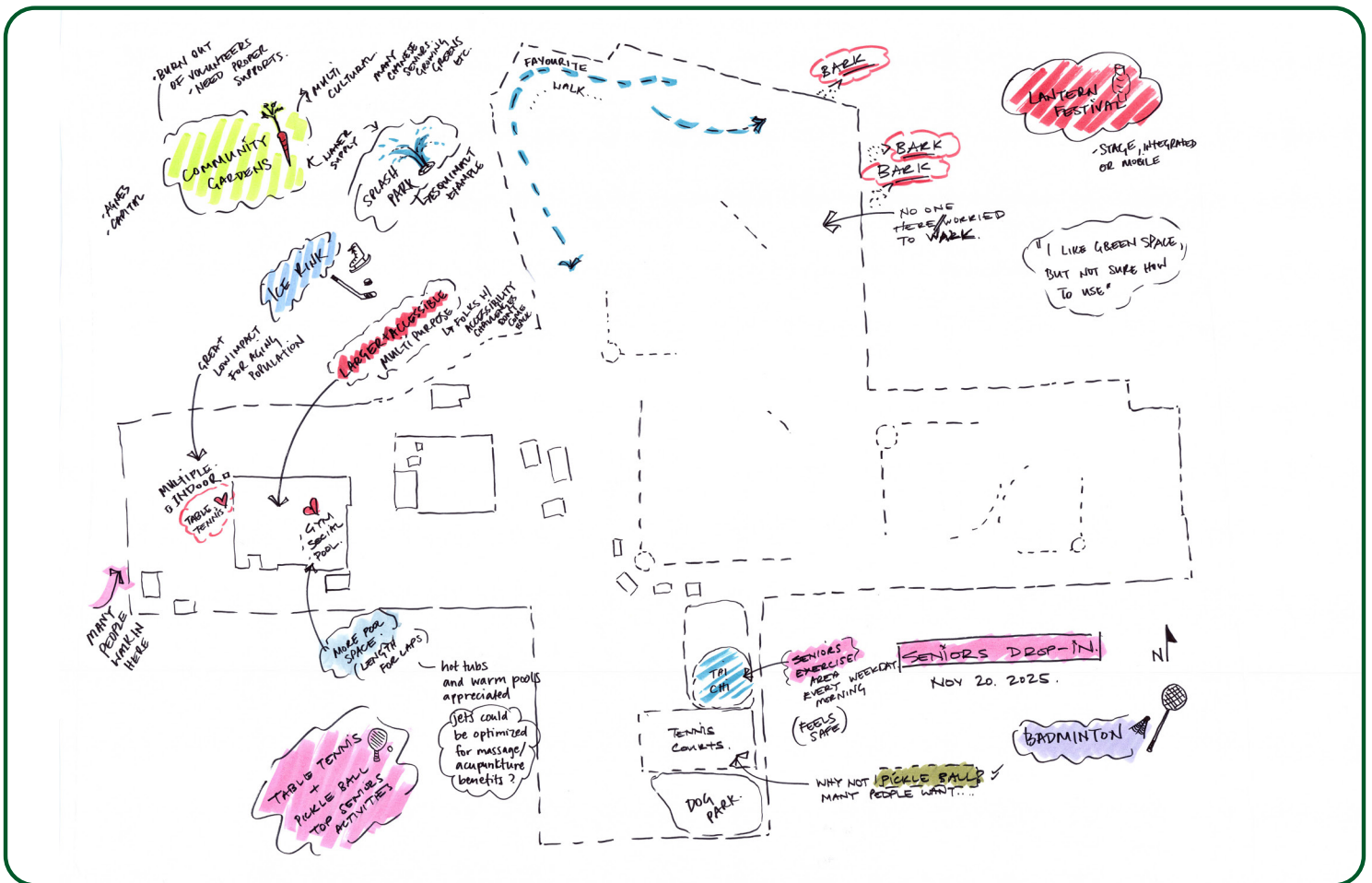

4.1.7 Virtual Information Sessions

Community members explained that the amount of change underway in the neighbourhood feels overwhelming, which made their appreciation for the Lambrick Park Campus even more apparent. People spoke warmly about the multi use pathways and the trail that loops around the park, and also pointed to opportunities to improve parking not by increasing the number of spaces, but by improving how vehicles move in and out of the lots. Improved lighting was raised as a way to support a stronger sense of safety (**5 mentions**), with the understanding that upgrades would likely need to be targeted rather than applied across the entire Campus. Participants also highlighted their fondness for the Campus's green spaces (**9 mentions**) and expressed interest in preserving and enhancing them. Sports fields and courts were also appreciated (**10 mentions**), though some saw potential to consolidate or share certain spaces to better accommodate a wider range of park users.

Prompts

1. **What do you appreciate most about the park today?**
2. **Where are your favourite spaces?**
3. **Where do you feel welcome or unwelcome?**
4. **What spaces need improvement?**
5. **What is your vision for the park in 15 years?**
6. **How do you typically travel to the park?**
7. **What would make it easier for you to access and physically navigate the park and its amenities?**
8. **What improvements would you like to see to the sport's fields, courts and supporting facilities?**
9. **What improvements would you like to see to the GHRC?**
10. **Where do you see opportunities for naturalization in the park?**
11. **How do you use unprogrammed areas of the park? What are the opportunities to better support informal recreation?**
12. **What is your big, bold idea for the renewal of the park?**

4.1.8 Rec Centre Service Providers Workshop

In the January session for Rec Centre Service Providers, participation came from partner organizations operating at various rec centres. There was an appreciation for Lambrick Park as a valued community space, yet participants also identified several areas for improvement to better support local needs, reflecting aspirations for more inclusive, accessible, and multi generational spaces. Safety concerns (**5 mentions**) were a theme that arose, particularly around the busy multi use path, limited lighting (**2 mentions**), and conflicts between different park users. Participants also emphasized the need for upgraded facilities—including an improved playground (**3 mentions**), fenced outdoor areas, rentable structures, quiet zones, and a community kitchen to strengthen social connection and support families. Overall, the conversation underscored both the park's value today and the community's hope for thoughtful, climate resilient, people centered improvements.

Prompts

1. **What are the highs and lows of operating your program/ organization/ business on or near Lambrick Park today?**
2. **Are there any changes or trends in your field that you think we should be planning for over the next 10-20 years?**
3. **How could the park better support the people who spend time here; children, families, staff, visitors, and neighbours?**
4. **In what ways could the renewed park help strengthen community health, inclusion, and connection?**
5. **What trade-offs would be acceptable, and what elements are essential or non-negotiable for the future design?**
6. **Are there any partnerships or collaborations that you think could help make this project more successful?**
7. **Is there anything else about this park or the surrounding area that you think we should know as we move forward?**

4.1.8 District Staff Workshop

Staff emphasized the importance of designing the future Lambrick Park Campus to be as inclusive as possible, reflecting the diversity of the neighbourhood and welcoming user groups that have not traditionally been part of the site.

The discussion highlighted the potential for the project to demonstrate leadership in sustainable and economically responsible development, with opportunities to integrate new technologies, build health sector partnerships, and collaborate with non profits and other community organizations.

Participants also spoke about meaningful ways to acknowledge pre contact history through naming or interpretive signage. The workshop closed with a robust conversation about the next phase of engagement and how to broaden participation, particularly by reaching voices that are seldom heard in typical consultation processes.

Prompts for Staff Discussion

1. **What opportunities do you see the Lambrick Park Campus Renewal project to further the District of Saanich's municipal priorities?**
2. **What operational challenges do you foresee with maintaining new facilities or expanded programming?**
3. **How can design choices reduce long-term maintenance costs?**
4. **How can this renewal strengthen community health, inclusion, and engagement?**
5. **What opportunities are there to integrate cultural or heritage elements into the design?**
6. **What opportunities for partnerships do you see which could enhance the success of this project?**
7. **What does equitable access look like for different user groups?**
8. **How can we ensure the park serves both organized sports and casual users?**
9. **What should be prioritized given the demographic trends and anticipated changes over the next 10-20 years?**
10. **Rank the following goals for the concept options, based on priority: Community impact, Futureproofing, Equity & access, Environmental sustainability, Financial considerations, Operational feasibility**

4.1.9 Sports User Groups Workshop

Participants in the sports user group workshop brought a deep familiarity with the Lambrick Park Campus and expressed strong appreciation for the park's vibrancy and variety of activity. One participant remarked, "I get so energized by this park with so much going on!"

Much of the discussion focused on outdoor sports fields, courts, and supporting facilities (**38 mentions**). While participants valued the number of fields available, they saw opportunities to improve the overall layout to reduce user conflicts and increase efficiency. Ideas included reorganizing the baseball diamonds into a more efficient "clover leaf" configuration that would allow four diamonds to share common amenities such as washrooms and concessions. Many also advocated for a shared clubhouse or year round training facility that could partner

with Saanich schools, as well as the potential for a covered multi sport space.

Participants also emphasized the need for improved field maintenance, noting that several areas experience poor drainage during heavy rain. This includes the central baseball diamond, another diamond in the north quadrant, and a soccer field to the north. Better lighting on fields and courts was identified as another priority, both to extend safe play time and to support winter use (**11 mentions**).

Additional topics included ensuring equitable access for all sports groups, enhancing Gordon Head Recreation Centre including athlete training opportunities (**10 mentions**), and addressing vehicular congestion during high volume events and tournaments (**5 mentions**).

Prompts for Sports Users

1. **What does an ideal campus experience look like for your organization and for the broader community? What supporting features would make the experience better?**
2. **What opportunities do you see for shared use of fields and facilities?**
3. **What space barriers currently exist for your users/participants or the public in accessing Lambrick Park Campus, and how can we improve upon them?**
4. **What trends in your sport or recreation activities need to be planned for in the next 10-20 years?**
5. **How do you use unprogrammed areas of the park? What are the opportunities to better support informal recreation?**
6. **What is your big, bold idea for the renewal of the park?**

4.1.10 Adult Aquafit Pop Up

Older adults who participate in the GHRC Aquafit program expressed a high level of satisfaction with the Gordon Head Recreation Centre and emphasized the importance of thoughtful, cautious development that maintains existing recreation and exercise opportunities. They value the centre's size, layout, accessibility, staff, and strong sense of community. At the same time, they noted frustration with the temporary weight room closure and the disruptions it caused to daily routines, while acknowledging that parts of the facility, including the pool, are due for updates or potential replacement.

Participants also shared that GHRC feels more accessible than other facilities in the community, pointing specifically to the building's scale and the ease of navigating the entrance. However, they did mention that the bus stop at Feltham feels too far away.

Suggestions were offered on how to better engage senior populations throughout the process, alongside a broader emphasis on ensuring that all diverse users of the site remain informed and involved as planning continues.

4.1.11 Correspondence

During Phase 1, community emails reflected a broad mix of perspectives. While some focused on dog parks and leash optional areas, some shared views on recreational amenities, highlighted maintenance and ecological concerns, or expressed interest in improving family oriented and all season facilities. Other emails were more logistical, seeking clarification on how to access the Questionnaire (**4 emails**).

Overall, the correspondence demonstrated wide ranging community priorities and a strong interest in shaping the future of the site.



What is your vision for Lambrick Park in 15 years?

Using your creative imagination, share your ideas on sticky notes for the experience and character of the Lambrick Park Campus in 2040.

ICE RINK
2ND POOL
MINI GOLF
OUTDOOR CIRCUIT
LIKE HENDERSON

Multiuse
facility think
Langley Sports
Complex

ICE RINK
CURLING - HOCKEY

World famous
outdoor
swimming pool!

Better Safer
access
Use roundabouts
More cohesive

Yes!
outdoor pool
waterpark
sauna

Maintain
Green
spaces

Need multi-
purpose
indoor court
for
badminton, ping pong, squash

more facilities to
accommodate more
programs. we currently
leave Gordon Head for
skating, tennis, arts
programs - all at
other Saanich Rec
centres
summer day camps

Expand Rec. Centre
Weightroom and pool
Not suitable for ice

Multi-
use
eg.
Improve
Shellborne

5.0

Key Themes

KEY THEMES

Throughout all engagement, eight key themes emerged, in no particular order:

- Celebrate and preserve the community's strong connection to Lambrick Park Campus.
- Upgrade the GHRC and replace or modernize indoor recreation spaces.
- Expand programming to support a wider range of uses and user groups.
- Improve transportation, mobility, and accessibility across the campus.
- Enhance lighting in strategic locations such as along main pathways and address perceived safety concerns.
- Upgrade and optimize sports fields, courts, and related amenities.
- Protect and enhance naturalized areas and environmental features.
- Strengthen opportunities for informal and unstructured recreation.



5.1 Celebrate and preserve the community's strong connection to Lambrick Park Campus.

Residents deeply value Lambrick Park Campus as a vibrant, multi-use space that fosters community connection, describing it as an irreplaceable gathering place woven into daily life. People value the park's mix of programmed and unprogrammed spaces, from lively ball games to farmer's markets to quiet moments along natural trails.

Respondents appreciate the park's diversity of activities, highlighting its role as an inclusive hub for all ages. Trails and open green spaces are considered essential for recreation, accessibility, and community well-being, with emphasis on maintaining natural surfaces to keep them as a slower space for pedestrians. Overall, the park is seen as unique, family-friendly, and irreplaceable, with a clear desire to retain its character while supporting existing programs and services.

Support for the Lambrick Park Preschool and Childcare was evident, with many respondents vocalizing a strong desire to preserve it amid future development, both the building for its heritage value and the childcare programming.

Some participants voiced a desire to prioritize the preservation of the special parts of the park during redevelopment. With other development happening nearby, the associated impacts are front of mind for many residents. There is some concern that development (such as an ice rink or the potential inclusion of housing) could reduce the amount of green space, increase traffic, and alter the park's welcoming atmosphere. Instead, participants hope that development prioritizes preservation of existing greenspace and thoughtful enhancements that respect the park's character. Overall, feedback reflects a deep appreciation for the park as a neighborhood hub with a multitude of special spaces.

"I get energized by this park with so much going on!"

"Love watching baseball & grabbing a hotdog"

"The children and educators at Lambrick Park Preschool LOVE these hills! We roll down them (and run) when the grass is dry. So fun!"



5.2 Upgrade the GHRC and replace or modernize indoor recreation spaces.

GHRC and other indoor recreation facilities were one of the strongest themes in this phase of engagement. GHRC is a well-loved amenity in the area, which has led to the facility being at capacity with waitlists for many activities. While some community members expressed concern about change and potential disruptions to service, there was a general agreement that there was a need for expansion of existing offerings at the GHRC to keep up with the growth of the surrounding area. A sense of urgency was also expressed regarding the GHRC improvements by some participants, while others advocated for a replacement to be built before any renovations or deconstruction happens.

Accessibility and inclusivity were also mentioned regarding GHRC, with some users mentioning that expansion could allow the opportunity to create more family or gender neutral changerooms.

Pool

While some community members feel the current pool meets community needs, most agree that expansion or complementary facilities are necessary to relieve overcrowding. The pool is highly valued by families and local swimmers, but many users noted that it is too small and shallow for serious lap swimming and competitive use. Some users specifically recommended a competitive-sized swimming facility that can accommodate events. Other suggestions included expanding the pool to add more lanes, increasing depth for flip turns, and improving accessibility with additional family and universal change rooms to accommodate more people. Many community members, especially youth, advocated for an outdoor pool that could be used in the warmer seasons.

“Swimming pool is not suitable for serious length swimmers. It is too shallow to do flip turns at the shallow end and not great for lap swimming.”

Indoor Courts and Gymnasium

Participants envisioned more flexible indoor spaces to accommodate sports such as badminton, pickleball, volleyball, squash, and table tennis. Participants specifically highlighted pickleball as an up-and-coming sport without adequate space to meet current and future demand. Suggestions included building a larger gymnasium with higher ceilings, adding multipurpose courts, and creating spaces for dance and martial arts. Respondents emphasized the need for open gym time for non-registered sports. Specific requests included gym space for volleyball, and floor space for dancers to use outside of organized dance classes.

Programs and Classes

There is enthusiasm for expanding programming beyond fitness to include arts, music, cultural activities, and informal social spaces. Ideas include job training opportunities for youth, meditative and wellness programs, and more drop-in options for families. This is further highlighted in the next theme. Respondents also suggested that the District of Saanich leverage school partnerships for evening and weekend programs to free up space at GHRC.

It is important to note that this project is focused on addressing spatial needs for Lambrick Park Campus. While the spatial needs may be influenced by sports and recreation programming and classes, this project will not directly influence or change the actual programs themselves, including frequency and scheduling of classes. The Project Team will take this feedback into consideration as it relates to other relevant PRCS work.

“Desire to see [GHRC] more as a “Community Hub”, alongside better facilities for competitive level athletes.”

The weight room is appreciated but considered too small and outdated. Participants recommended expanding the space, modernizing equipment, and creating designated areas for rehabilitation and low-impact exercise. A larger, well-equipped weight room was seen as essential to meet the needs of a growing population. Some users also expressed that the temporary closure of the weight room has been a significant challenge for them. It is important to note that the closure of the weight room at the time of engagement could have impacted perspectives regarding GHRC.

“More fitness programs”

“Use current gym space (too small, low ceilings) for something else & build a new weight room.”

“Fix up Bert Richman”

“Multi-purpose indoor sports space (pickleball, badminton, etc.)”

Key Requests

1. **Expand the square footage to serve more community members, if possible.**
2. **Expand and improve the aquatic centre to allow for more lanes, longer pools for length swimming and a facility that will be capable of hosting swim competitions.**
3. **Accommodate a higher frequency of existing classes and expand to more diverse offerings.**
4. **Expand the weight room/gym to allow for more diverse exercise, including low-impact exercises for the aging population.**



5.3 Expand programming to support a wider range of uses and user groups.

Participants appreciate that Lambrick Park Campus serves a variety of community needs, going beyond sports, recreation, and wellness. However, there was also a theme of a desire to further expand the diverse uses offered in the park to create more of a “community hub”.

Community members expressed interest in expanding social spaces that offer the opportunity to connect. In particular, some park users mentioned Lambrick Park Campus serves residents living in secondary suites or apartments that rely on public spaces to gather in larger groups. Participants asked for more informal gathering areas with comfortable seating, picnic tables, rainproof outdoor shelters like a gazebo with tables, and multipurpose indoor rooms for sports, arts, and community events.

There is a strong appreciation and a desire to expand existing features that explore culture or highlight local food. For example, the farmers market and the lantern festival were activities that users advocated to expand. Youth vocalized their desire for ice cream or concession stands. Park users also want more programming for music, public art, and cultural interpretation, including Indigenous perspectives.

“Include indoor community space for informal gathering shop/comfy couches/tables & seating”

“Summer market please.”

This project will not directly influence the activities and programming itself, but will instead influence the spaces that could accommodate the mentioned activities.

Further fulfillment of the daily needs of residents could be met with expansions to childcare and food options. The preschool and childcare at Lambrick House are vital to community members, and many who participated in engagement hope for expanded childcare and early learning programs to serve families in Saanich. Other suggestions included adding amenities such as a coffee shop, ice cream stand, and more healthy food options at the concession that can help serve a diversity of daily needs.

While preserving open green space remains a priority, some respondents proposed integrating affordable or senior housing nearby, ensuring that any development complements the park’s character. Overall, feedback reflects a desire for Lambrick Park Campus to evolve into a welcoming, multifunctional destination that balances recreation and social connection for all ages.

Key Requests

- 1. Expand spaces to accommodate a diversity of events, such as music and art.**
- 2. Add additional spaces for childcare or early learning programs on site.**
- 3. Incorporate more food options, including cafes or concession stands.**
- 4. Consider covered outdoor spaces to encourage gathering across all seasons.**

5.4 Improve transportation, mobility, and accessibility across the campus

Many community members spoke about mobility and accessibility as it relates to both *getting to* the park and *navigating within* the park.

Getting to the Park

Most issues in this topic are related to vehicle traffic, while cyclists tended to feel that getting to the park by bike was convenient. Cyclists praised the new south corner entrance, while others vocalized desire for a traffic light or safety measures at the south entrance.

Parking

Community members experience challenges finding parking and say that the multiple and disconnected parking lots mean that some parking lots (especially near GHRC) fill up early in the morning, while others remain underused. Specific infrastructure improvements were suggested, such as paving and line marking of the current gravel parking lots. Some community members proposed developing underground parking to preserve green space and converting underused areas into landscaped zones. Covered bike parking with solar roofs and improved facilities for e-bikes and family bikes were also recommended.

“Separate walking/pedestrian path from the cycle path.”

“South end entrance needs major modifications to increase safety. Suggestion for additional entry point. Need for better signage, keeping wheeled-mobiles slow, traffic lights, and better fencing.”

“Northside entrance of park is perceived as dangerous and underdeveloped. Lacks signage/wayfinding.”

Sense of arrival and navigation

Several community members emphasized the need for clearer wayfinding and a stronger sense of arrival at park entrances. The north entrance was highlighted with this theme, with some community members suggesting adding a larger more definitive entrance. It was described as underdeveloped and lacking signage, despite being used by school groups. Improved directional signs and a more cohesive design were suggested to make navigation easier and enhance the park’s identity.

Safety

Safety concerns focused on traffic and pedestrian access, particularly at the north and south entrances and crossings such as Tyndall Avenue. Ideas included adding roundabouts, traffic calming measures, and better fencing to separate wheeled mobility users from pedestrians. Community members also called for safer bike routes, designated paths for walkers and cyclists, and additional entry points to reduce congestion and improve overall accessibility. Further safety concerns are explored in Section 5.5.

Key Requests

1. Create a larger, more centralized parking lot.
2. Create better connections with clearer wayfinding and signage particularly at north entrance.
3. Create traffic-calming infrastructure at the south entrance

Navigating within the Park

Community members enjoy using trails as shortcuts to surrounding neighborhoods and local businesses, reinforcing the park's role as a connector. However, the input strongly emphasizes the need to improve safety, access, and mobility throughout the park.

Perimeter Trail Design and Surface

Respondents strongly value the perimeter trail as a unique and well-used amenity for walking, running, and off-leash dog use. Many emphasized keeping the trail unpaved during future development to maintain its "natural feel", while others suggested improvements such as widening, better drainage, and reducing muddy sections. A few proposed paving or adding a cement/asphalt loop for accessibility, though most prefer the current natural surface. Maintaining the trail for all ages and diverse abilities was highlighted as essential.

"Our family, including a person with disability, uses the 1.5km perimeter trail daily as exercise... Our dog is off-leash. It is a fantastic unprogrammed community space to foster connections."

"Cycling sightlines are limited, low visibility overall."

"Slow down wheeled traffic."

Cycling and Multi-Use Paths

While the central multi-use path is appreciated for connectivity, some cyclists find it too busy for commuting. Many respondents highlighted conflict zones and dangerous interactions between pedestrians and fast-moving cyclists or e-bikes where pathways intersect. Particular conflict zones were noted near the central ball diamond/Lambrick House. As a result, a repeated priority was the separation of pedestrian and cycling pathways and the need to implement measures to slow down wheeled traffic, especially fast-moving e-bikes. Suggestions included painting lines to delineate walking and cycling zones, adding speed bumps, or even creating segregated paths for different users. A bike safety and training park for children was also proposed, along with more e-bike parking and improved sightlines for cyclists.

Key Requests

- 1. Improve visibility at night, particularly along multi-use paths, while remaining Dark Sky compliant for wildlife.**
- 2. Reduce conflicts between fast moving cyclists/micromobility users and pedestrians through clear separation and other safety measures. A particularly hazardous intersection of the park is where the multi-use trail meets the Bert Richman Building.**
- 3. Maintain the unpaved perimeter path while improving drainage and accessibility for pedestrians of all ages and abilities.**

5.5 Enhance lighting in strategic locations such as along main pathways and address perceived safety concerns.

The responses show a strong and consistent call for improved lighting and perceived safety throughout the park.

Lighting

Users who rely on the park in the late afternoon and evening (specifically 4 pm – 9 pm) emphasized that poor visibility creates safety and usability concerns, especially during the darker months when it gets dark early. Multiple respondents specifically requested lights along the paths (including the main walkway to the recreation centre and the full perimeter loop) noting that the current lighting is inadequate or only available during certain seasons. Several comments also highlighted that areas used for sports like the lacrosse box and baseball diamonds are poorly lit during the fall ball season, limiting year-round play. Many respondents said that low or lack of lighting can at times make them feel unsafe.

“Proper fencing needed in between fields for better safety due to stray balls flying near small children. Current fences are too low. Suggestion to move 20-30 feet to the east.”

“Why not light at night very dark for walks and bikes through the park.”

Perceived Unsafe Spaces

Perceived safety concerns focused on several spaces; the north entrance was described as underdeveloped and unsafe, requiring better visibility; playground areas need fencing to protect children from nearby roads and fast-moving e-bikes; and ball fields require higher fencing to prevent stray balls from reaching pedestrians and small children. Community members also frequently mentioned the Bert Richman Building as a priority for safety improvement, with suggestions ranging from a full replacement to significant renovations. Concerns included safety issues with the second floor* and conflict points around the building that impact pedestrian and bike traffic.

**At the time of report publication, access to the second floor has been closed off due to safety concerns.*

Key Requests

1. **More lighting needed throughout the park. Ball diamonds were mentioned most frequently.**
2. **Consider fencing or reconfiguration of uses to protect from foul balls from baseball fields. Current hazard areas were noted around parking lots and the playground.**
3. **Upgrade or replace the Bert Richman building.**

5.6 Upgrade and optimize sports fields, courts, and related amenities.

Countless comments across all engagement events and methods related to sports fields, courts, and related amenities. Community members made it clear that they value these spaces within Lambrick Park Campus.

Ice Surface

Many community members expressed strong interest in adding an ice rink to the Lambrick Park Campus, viewing it as a valuable amenity for hockey, curling, figure skating, and public skating. Several community members noted that the rink should be designed efficiently, with some participants referencing the G.R. Pearkes Recreation Centre as a guiding precedent. Suggestions emphasized putting multiple ice sheets into one multi-level recreation facility with underground parking to minimize land impact. Some proposed features included commercial spaces for skate sharpening, dryland training areas, and shared spaces for roller hockey and roller derby. Supporters emphasized that an ice rink would serve all ages and meet growing demand in the Gordon Head area, especially given the loss of other facilities nearby.

However, some residents voiced concerns about the ice rink's footprint, potential loss of green space, increased traffic, and the need for large parking areas. A few participants suggested locating the rink elsewhere in Saanich or developing it in partnership with UVic to avoid compromising the park's natural character. Even some of the supporters of the rink emphasize the need to retain green space in the process. Overall, resistance focused on preserving open parkland and minimizing hardscape development.

“Several ice sheets. One for skating & curling, one hockey.”

“Expand rec centre to include ice rink but am concerned about losing green/walking space.”

“No ice rink. Keep fields natural. Not plastic grass.”

“Ice rink is a must!!! For all ages.”

“No ice rink!”

Baseball and Softball Fields

Participants expressed strong appreciation for Lambrick Park Campus' reputation as a popular baseball destination and emphasized retaining all existing diamonds. Suggestions included reorienting fields into a cloverleaf design for efficient spatial use and centralized amenities, upgrading batting cages and bullpens, and improving drainage and lighting - especially in the north quadrant and central east diamond. There was also interest in seating upgrades for families and spectators. There was a strong desire to create a multi-sport training facility/ clubhouse in Lambrick Park Campus, with many baseball players suggesting that it is needed near the baseball diamonds.

Soccer and Multi-Use Fields

Feedback highlighted the need for additional soccer fields, including a full-sized turf field and mini fields for youth. Community members noted that overlapping soccer and baseball use may remain necessary but suggested that a turf field and better scheduling would help to optimize field sharing. Drainage improvements were seen as critical to making fields usable year-round.

Tennis and Pickleball Courts

The tennis courts are heavily used and often unavailable, prompting calls for more courts and better enforcement of time limits. Many participants suggested adding dedicated pickleball courts or shared pickleball-tennis spaces, with some advocating for covered courts to enable play in all seasons. One tennis player noted that the current configuration with four courts allows for tournaments.

Lawn Bowling and Croquet

The lawn bowling facility is valued for fitness and social connection, especially among older adults. Some community members suggested expanding the clubhouse, adding a second green for croquet, and creating indoor spaces for short mat bowling during winter months to improve the facility's appeal.

Lacrosse and other sports that can utilize the box

The lacrosse box is appreciated but needs repairs, better lighting, and possibly a covered surface to support roller derby, ball hockey, and year-round use.

Partnerships

Finally, several participants proposed partnerships with the School District to coordinate recreational programming and activities between facilities in Lambrick Park Campus and nearby schools during evenings, weekends, and holidays, reducing pressure on Lambrick Park Campus land. Others suggested exploring agreements with nearby schools for relocating certain sports facilities, such as tennis or lacrosse courts, to optimize space for green areas and informal recreation.

Key Requests

1. **Integrate ice surface or multiple sheets into one multi-sport recreation facility to preserve as much green space as possible. Multi-sport usage could include hockey, figure skating, and ball hockey, lacrosse, etc.**
2. **Reconfigure the sports fields and courts for more accessible shared amenities.**
3. **Build a multi-sport, shared training facility/ clubhouse near the baseball diamonds.**
4. **Improve drainage in the park fields, particularly in the north and central baseball diamonds and soccer fields.**

“Soccer & baseball overlap - may always be necessary but there are better ways of accommodating (e.g. turf).”

5.7 Protect and enhance naturalized areas and environmental features.

Community members emphasized the importance of maintaining and enhancing green spaces within Lambrick Park Campus. Many participants mentioned that preserving and expanding green spaces is important for mitigating the impacts of climate change, creating shaded areas, and offering habitat for wildlife within the park. Suggestions included preserving the existing forest canopy, expanding the Garry Oak ecosystem, and adding more native plantings, pollinator gardens, and wildlife habitat. Many community members expressed interest in creating deeper forested areas to support biodiversity and climate resilience. Maintaining mature trees and adding new plantings - particularly at the northern tip - were regarded as priorities. Participants also highlighted their love for green spaces in general, saying they especially value the hills for play, snow activities, and informal recreation.

Green Infrastructure

Some residents mentioned specific infrastructure to enhance the natural habitat of Lambrick Park Campus. There was significant enthusiasm for introducing community garden plots in sunny, arable areas of the park. Ideas ranged from vegetable and flower gardens to pollinator-friendly spaces and informal orchards. Some people also mentioned opportunities for stream daylighting (if possible) and solar panel installations to support sustainability goals.

“Community Garden in some of the green area!!”

Key Requests

1. **Prioritize the preservation of green space in future development.**
2. **Prioritize sustainable measures in the park like controlled water usage and solar panels.**
3. **Create a community garden.**
4. **Preserve and expand forest canopy to create safer habitats for wildlife and more shade.**

“More trees less grass that gets watered in the summer.
Not a great use of water.”



5.8 Strengthen opportunities for informal and unstructured recreation.

Community members strongly value Lambrick Park's open areas for casual, unprogrammed activities such as kite flying, dog walking, and casual play. Many emphasized the importance of keeping unprogrammed spaces accessible for peace, relaxation, and social connection, especially as neighborhood density increases. Maintaining open parkland was seen as essential for mental and physical health. The space to sit near the "singing bushes" (bird-friendly shrubs) was referenced as a valued opportunity for peaceful reflection. Ideas for future development included adding gazebos for shelter, expanding informal seating areas, and ensuring that open fields remain accessible for spontaneous play and community use.

Playgrounds and Family-Friendly Features

There was significant interest in upgrading or expanding the playground to make it safer, larger, more engaging and more inclusive for all ages. Community members requested features such as fencing for safety, and additional playground equipment like monkey bars and obstacle courses. Splash pads, waterparks, and lifeguarded outdoor pools were frequently mentioned as desirable additions for summer use, while ensuring sustainable water use. The engagement input regarding aquatic facilities indicates that some of the community imagines more serious and competitive facilities to be expanded indoors, while more recreational and family-friendly swimming can happen outside (families and youth desire an outdoor pool). Finally, skatepark improvements and climbing walls were also suggested to provide more options for youth recreation.

The People, Pets and Parks Strategy includes recommendations that align with dog-friendly spaces. Read more about it online at saanich.ca/dogs

Dog-Friendly Spaces

Dog walking is a popular activity in the park and many community members advocated for permanent, fenced, year-round off-leash areas*. Suggestions included fenced dog parks with taller barriers, dog wash stations, and water access points. Pop-up dog parks and winter use of enclosed ball diamonds for dogs were also appreciated and recommended for continuation.

Community members that expressed a safety concern regarding dogs emphasized the need for separation. Participants requested that off-leash areas for dogs be clearly separated with tall barriers and clear signage to increase the likelihood of cooperation.

**The entire park is currently leash-optional and pop-up dog areas are provided for those who want a secure area to run their dogs. PRC Staff have made efforts to accommodate different needs depending on the owners and their dogs, and acknowledge that not all dog owners want the same things.*

Key Requests

1. **Keep large, unstructured areas for casual activities like walking, kite flying, and informal sports. Avoid replacing these spaces with new facilities.**
2. **Provide permanent, fenced off-leash dog parks. This serves dogs and dog-owners while also serving the needs of community members that expressed safety concerns.**
3. **Expand the playground to improve diversity of equipment including obstacle courses. Prioritize the safety of children in the upgrades.**
4. **Create water-based recreation amenities including splash pads and an outdoor pool. These amenities should also prioritize sustainable water-use.**

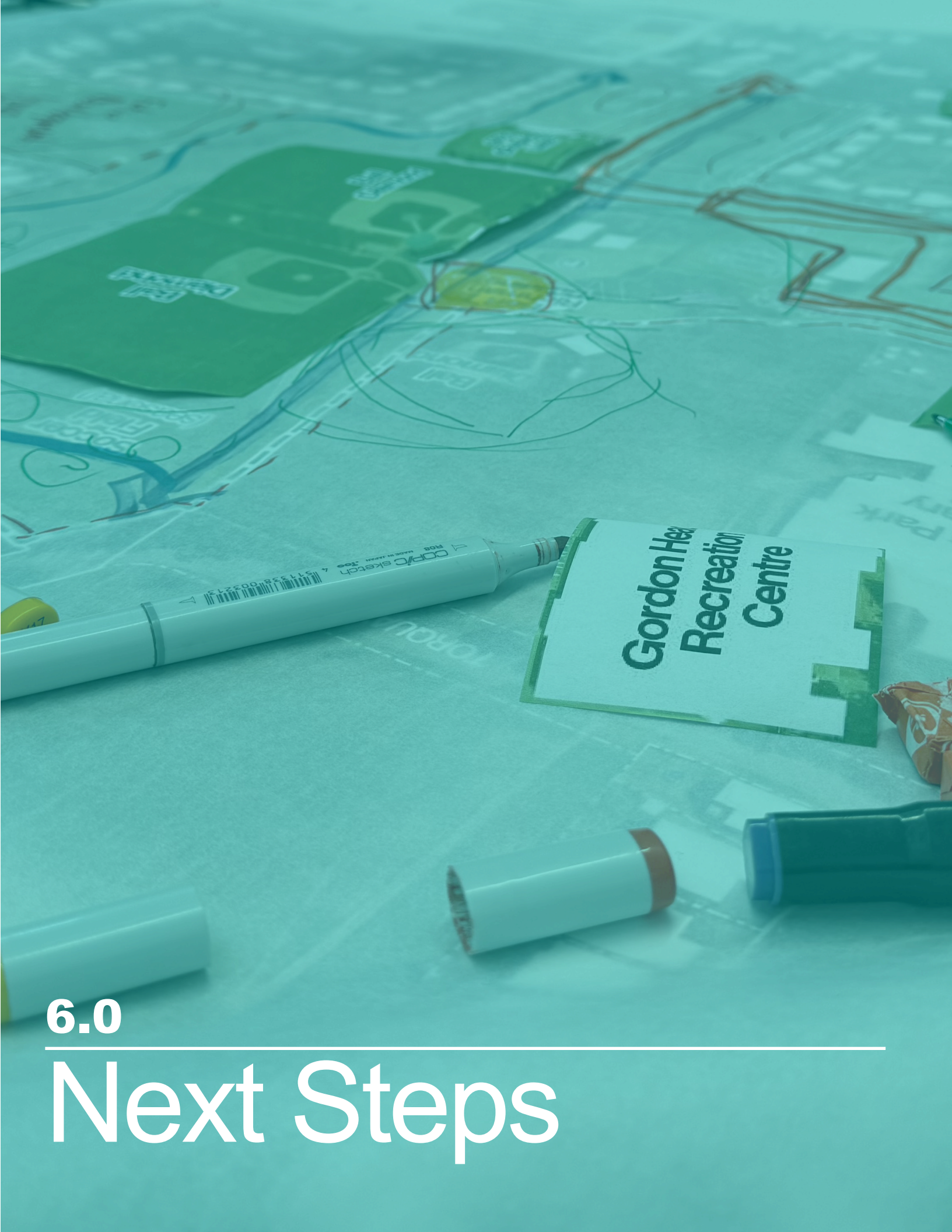

6.0

Next Steps

NEXT STEPS

Round 1 Engagement is now complete. The input received will help shape the forthcoming design options so they reflect community priorities while meeting technical and regulatory requirements.

The project team will now begin advancing the campus design (Phase 1 Design). This stage includes developing concepts, integrating public feedback, and preparing draft design options for review.

After the 2026 municipal election, an update will be provided to Council. Round 2 Engagement is expected to follow in early 2027. At that time, draft design options will be shared for community input.

Join us during Round 2 of community engagement. Find more information and updates on the project page at saanich.ca/lambrick or by contacting the following email: lambrick@saanich.ca

