

# PROPOSED FEE SIMPLE SUBDIVISION AND BARELAND STRATA OF LOT 24, SECTION 65, VICTORIA DISTRICT, PLAN 31674.

Civic Address: 931 Woodhall Drive, Victoria, B.C.

PID: 001-134-264

Zoning: RS-6

0 2.5 5 10 15 20 25  
The intended plot size of this plan is 560mm in width by 432mm in height, (C size), when plotted at a scale of 1:250

## NOTES

If this plan is used in digital form, J.E. Anderson & Associates will only assume responsibility for information content shown on original unaltered drawing.

Lot dimensions are derived from Field Survey, but may change upon completion of final survey.

Distances and elevations are in metres

Elevations are Geodetic (CVD28) based on control monument 79H0737

Elevations are at natural grade unless noted otherwise

Setbacks shown are based on RS-6 zoning, location of side yard setbacks may be adjusted, as long as they have the required combined total of 4.5m.

This plan lies within the Municipality of Saanich

This plan lies within the Capital Regional District.

The trees shown on this plan must be confirmed by an arborist.

## LEGEND

- Denotes Lamp Standard
- Denotes Water Service
- Denotes Water Valve Box
- Denotes Catch Basin
- Denotes Sewer Manhole
- Denotes Drain Manhole
- Denotes Irrigation Valve
- Denotes Typical Spot Elevation
- Denotes Cedar Tree
- Denotes Coniferous Tree
- Denotes Deciduous Tree
- TT099 --- Denotes Tree Tag Number
- FS --- Denotes Fee Simple
- SL --- Denotes Strata Lot

Client:

MARK KEWLEY

PROJECT SURVEYOR : CWG

DRAWN BY : SAL DATE : NOV 06/18

JOB # 30993 LAYOUT: Proposed Subdiv

REVISION DATE: 2020-03-30

FILE PATH:

V:\\_Projects\30993\08\Drawings  
...\Microsurvey\30993\_Legal.dwg

**JEA** J.E. ANDERSON & ASSOCIATES  
SURVEYORS - ENGINEERS  
TEL: 250-727-2214 WEB: www.jeanderson.com  
VICTORIA - NANAIMO - PARKSVILLE - CAMPBELL RIVER

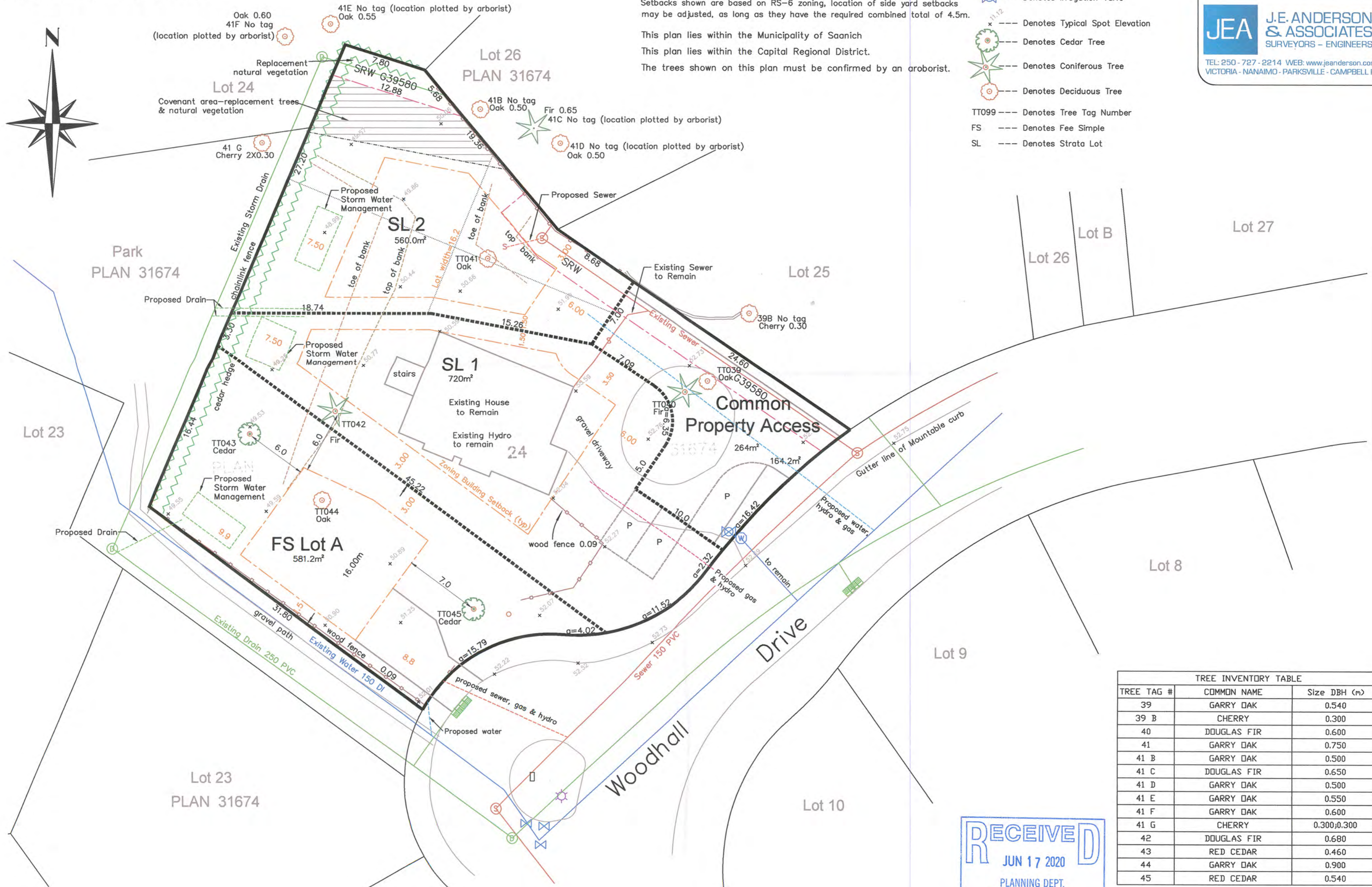

TREE TAG #	COMMON NAME	Size DBH (m)
39	GARRY OAK	0.540
39 B	CHERRY	0.300
40	DOUGLAS FIR	0.600
41	GARRY OAK	0.750
41 B	GARRY OAK	0.500
41 C	DOUGLAS FIR	0.650
41 D	GARRY OAK	0.500
41 E	GARRY OAK	0.550
41 F	GARRY OAK	0.600
41 G	CHERRY	0.300;0.300
42	DOUGLAS FIR	0.680
43	RED CEDAR	0.460
44	GARRY OAK	0.900
45	RED CEDAR	0.540

