

0 2 4 8 12 16 20
 The intended plot size of this plan is 560mm in width by 432mm in height, (C size), when plotted at a scale of 1:200.

This sketch does not constitute a redefinition of the legal boundaries hereon described and is not to be used in any matter which would assume same.
 J.E. Anderson & Associates accepts no responsibility or liability for any damages that may be suffered by a third party as a result of any decision made, or actions taken based on this document.
 Subject to charges, legal notations, and interests shown on: Title No. CA6628034 (P.I.D. 003-595-633)

Distances and elevations are in metres.
 Elevations are geodetic based on control monument 79H1077.
 Elevations are at natural grade unless noted otherwise.

SITE PLAN

PARM DODD

Lot 2, Block 4,
 Section 44, Lake District,
 Plan 1522

ADDRESS : 5185 Del Monte Avenue

PROJECT SURVEYOR : RPH

DRAWN BY : BAR DATE : MAY 08/18

OUR FILE : 31293 REVISION :

JEA J.E. ANDERSON & ASSOCIATES
 SURVEYORS - ENGINEERS

4212 GLANFORD AVE, VICTORIA, B.C. V8Z 4B7
 TEL: 250-727-2214 FAX: 250-727-3395
 E-MAIL: info@jeanderson.com
 VICTORIA-NANAIMO-PARKSVILLE-CAMPBELL RIVER



- LEGEND**
- --- Denotes Standard Iron Post Found
 - ▲ --- Denotes Traverse Station Placed
 - --- Denotes Deciduous Tree
 - --- Denotes Typical Spot Elevation
 - ⊕ --- Denotes Utility Pole
 - ⊖ --- Denotes Water Service

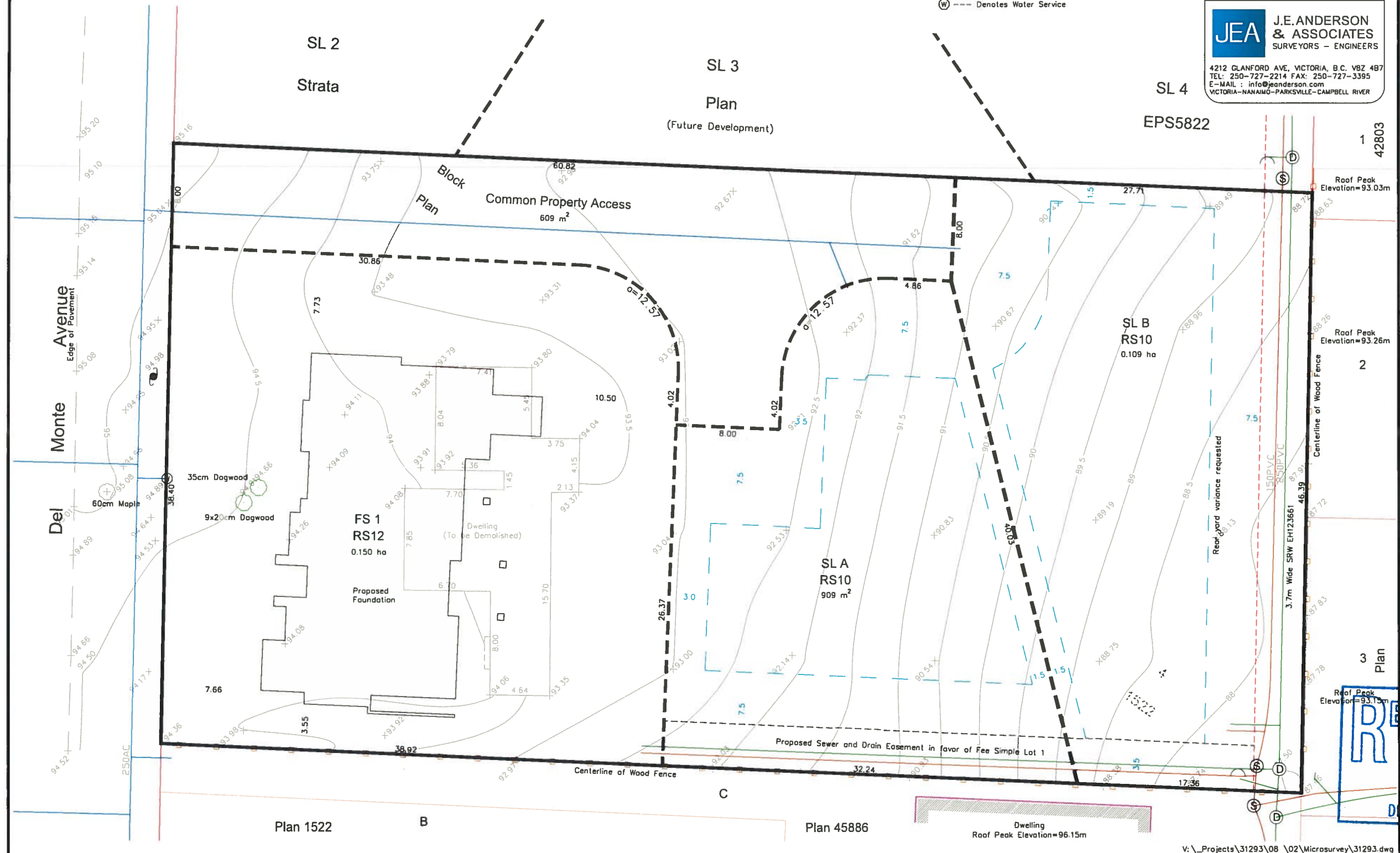

RECEIVED
 AUG 01 2019
 PLANNING DEPT.
 DISTRICT OF SAANICH