

- GENERAL NOTES**
- All drawings, plans, models, design, specifications and other documents prepared by Hoyt Design Co. (HDC) and used in connection with this project are the property of Hoyt Design Co. and shall remain the property of HDC. The contractor shall not be permitted to copy, reproduce, or otherwise use any part of these documents for any other project.
  - It is the responsibility of the Contractor to verify all dimensions, elevations, and site conditions as applicable to the project and the proposed work. The Contractor shall notify HDC of any errors, omissions, or discrepancies identified within the drawings prior to commencement of the work. Commencement of construction or any part thereof constitutes acceptance of the drawings, specifications of the existing site conditions, and agreed elevations and approvals have been coordinated, verified and are accurate.
  - The Contractor shall work with a B.C.L.S. to verify correct placement, setting and elevation of the proposed buildings or structures on the property prior to commencing the work. HDC is not responsible for any inaccuracies with respect to location, setting or placement. Any proposed changes with respect to elevation, setting or placement shall be confirmed with a B.C.L.S. prior to installation.
  - The Contractor shall engage a Professional Engineer licensed in the Province of BC for the design and field review of all structural components and systems within the work as required by the Authority Having Jurisdiction. Prior to commencement of the work, the Contractor shall notify HDC of any changes to the design required by the Structural Engineer, those manufacturers or other original component supplier.

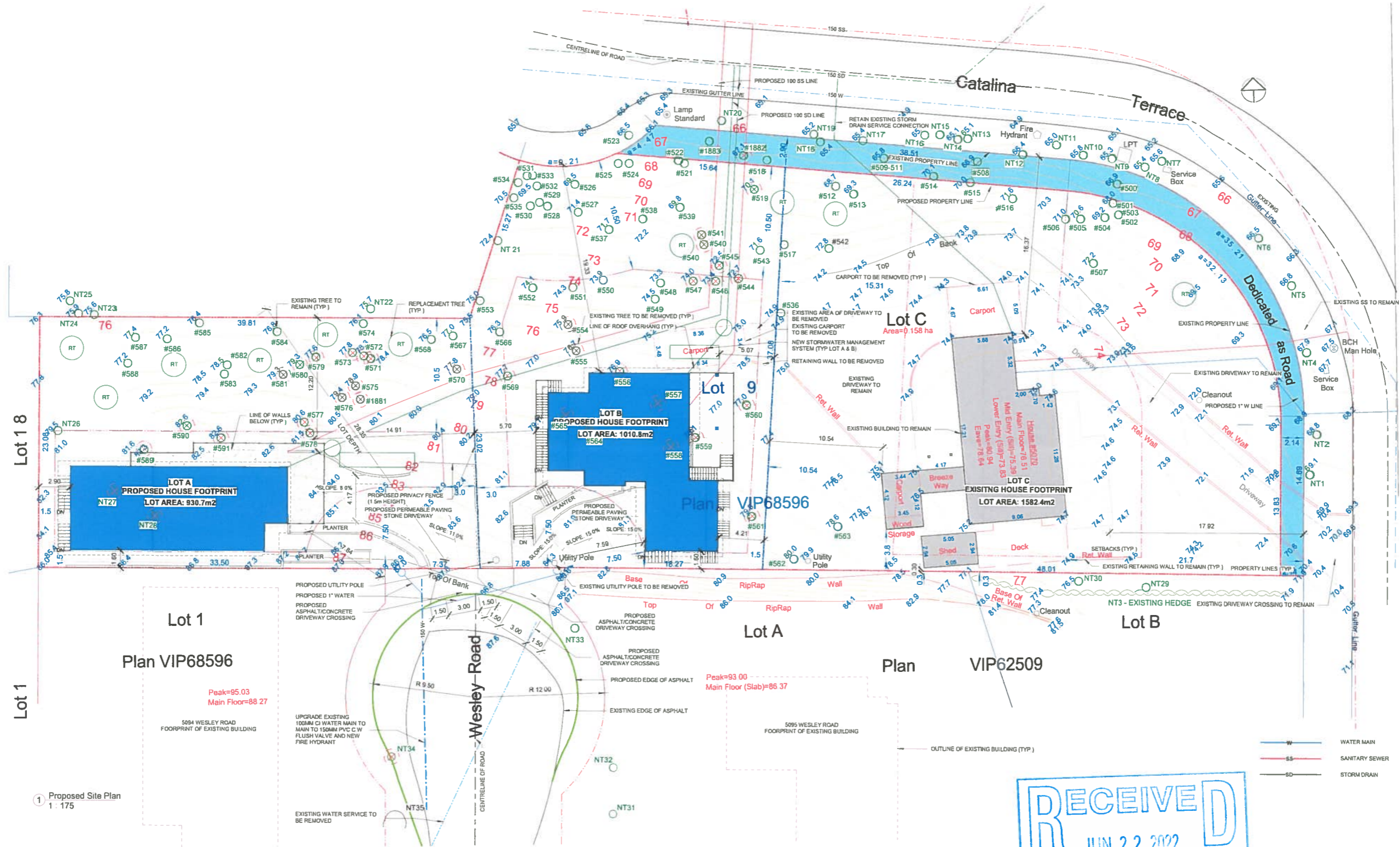

**PROJECT**  
**5070 Catalina Terrace - Subdivision**

ISSUE DATE: 22Jun07 REV 10

Date:	Description:	No.:
20Jun11	Issue for DP	5
20Nov30	Site Plan Rev1	6
21Jan11	Site Plan Rev2	7
21June04	DP Revisions	8
22Feb07	DP Revisions 2	9
22Jun07	DP Revisions 3	10

Proposed Site Plan



**A1.3**