

Proposed Subdivision of 4601 Cordova Bay Road

Parcel A (DD 7803-W) of Lot 1,
Section 24, Lake District, Plan 11854

Parcel Identifier: 004-892-861

Scale - 1 : 5 0 0

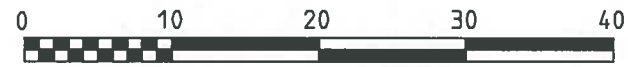

All distances are shown in metres.
The intended print size is 11 by 17.

The following non-financial charge
is shown on the current title which
may effect the property -
Covenant - CA4819104

The proposed lot dimensions
and areas shown are based
on a current field survey.

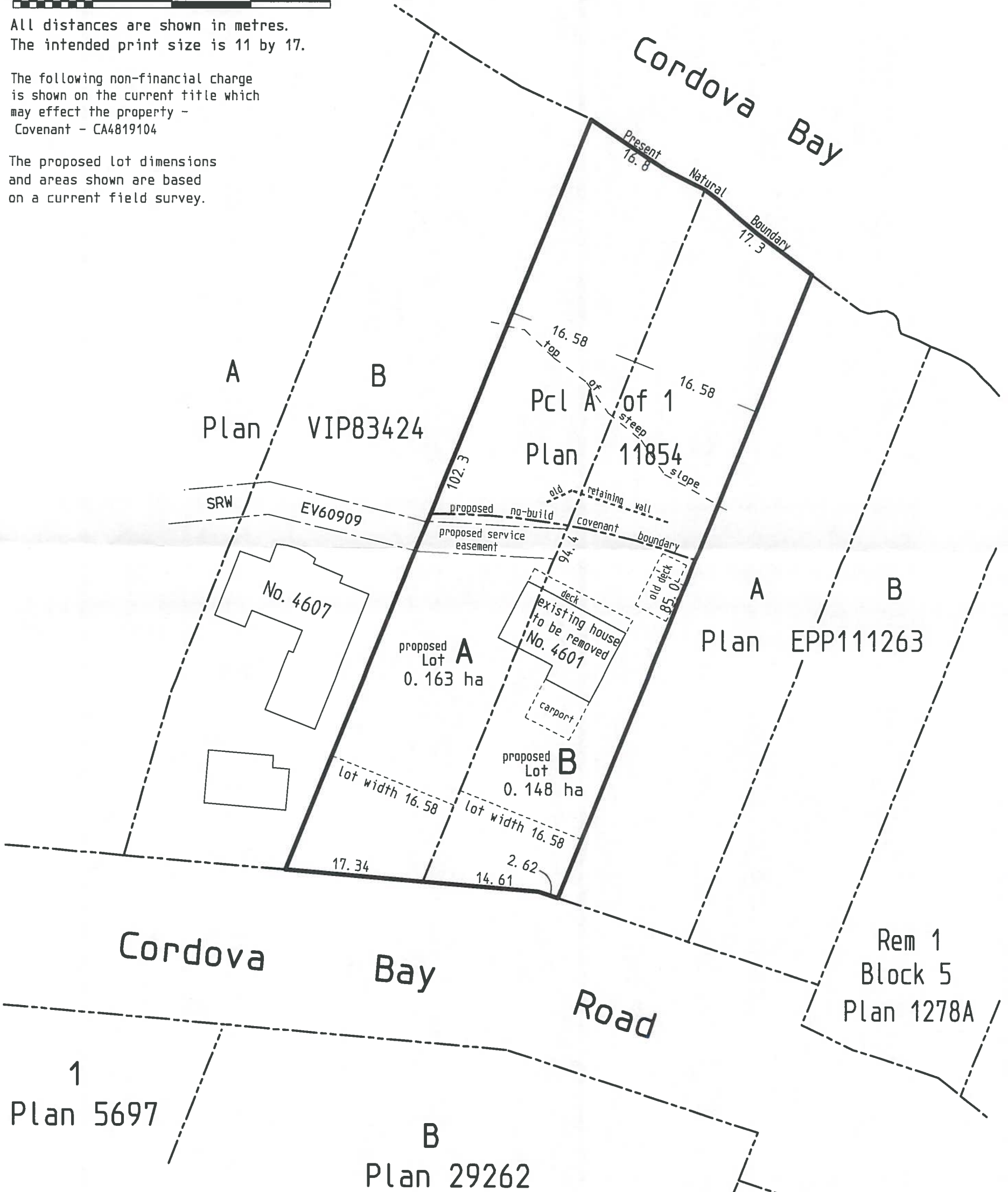

June 28, 2022

| |
|--------------------------------|
| File: 13,493 Site (70D) |
| POWELL & ASSOCIATES |
| BC Land SurveyorS |
| 250-2950 Douglas Street |
| Victoria, BC V8T 4N4 |
| phone (250) 382-8855 |

RECEIVED
SEP 26 2022
PLANNING DEPT.
DISTRICT OF SAANICH