

BC LAND SURVEYORS SITE PLAN OF:

PROPOSED SUBDIVISION OF:

Civic: 4317 Majestic Drive

**Legal Lot A, Section 17,
Victoria District, Plan 9311**

Parcel Identifier: 005-611-512
in the District of Saanich

LEGEND

Elevations are geodetic and referenced to the CVD28BC datum.

- # - denotes - tree tag number
- denotes - protected root zone
- Tree diameters are in centimetres.

Lot Area = 892 m²



Majestic Drive

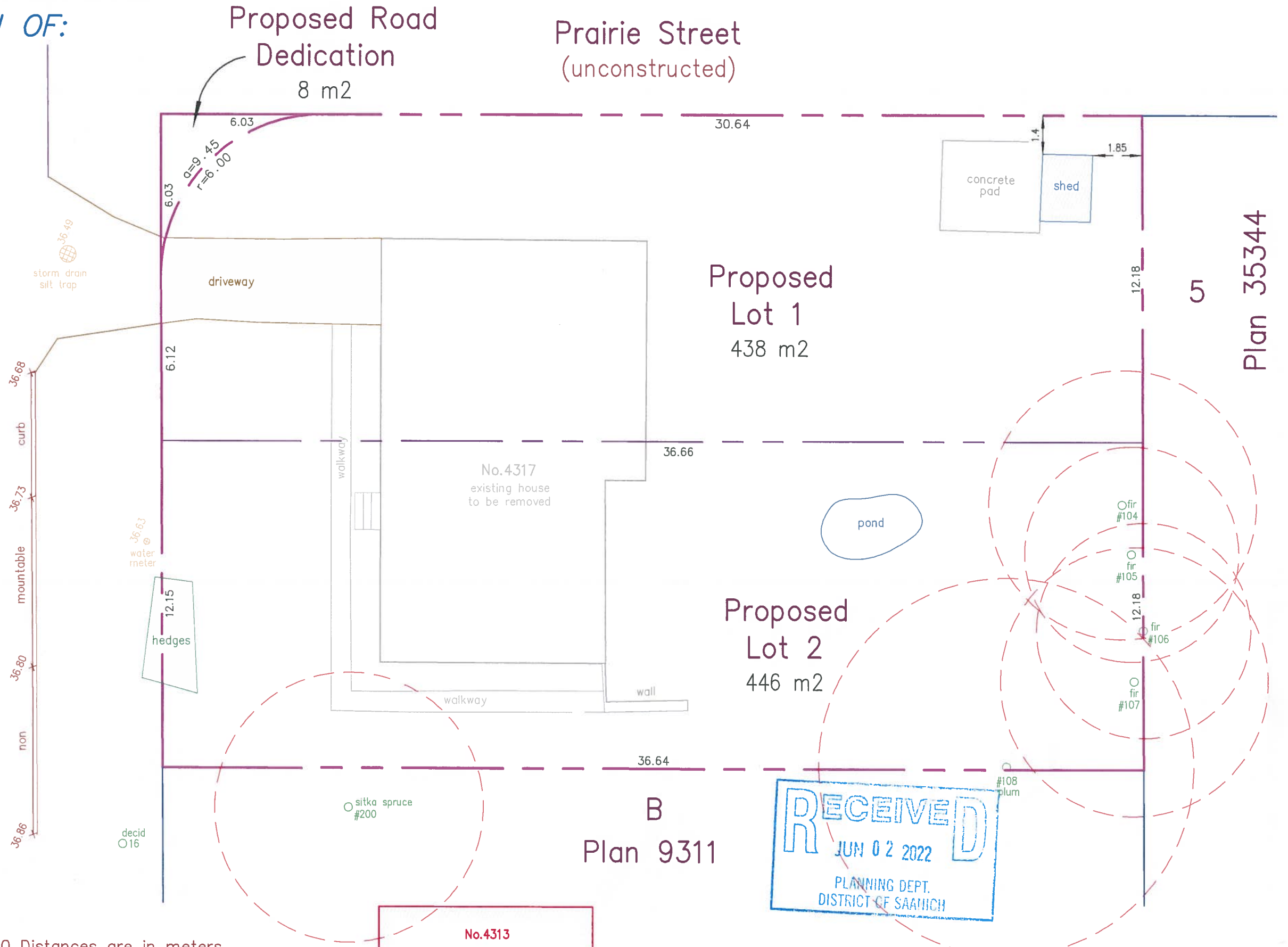

3731 SUB 03

| | |
|--|--------------|
| Date | May 12, 2022 |
| File | 13,731-62 |
| POWELL & ASSOCIATES BC Land Surveyors 250-2950 Douglas Street Victoria, BC V8T 4N4 phone (250) 382-8855 | |

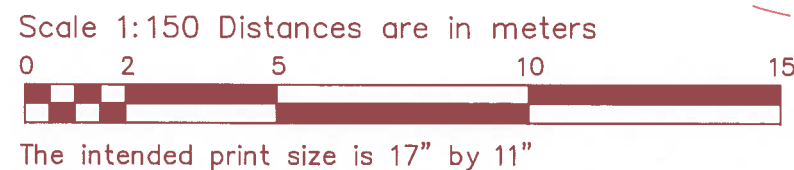

Setbacks are derived from field survey.
Parcel dimensions shown hereon are derived from Land Title Office records.

This document shows the relative location of the surveyed features and shall not be used to define property boundaries.