



RETAINING WALL



PAVERS

Small growing trees (6m max mature height) are not to be planted within 3m of foundations, fences or outbuildings and medium and large growing trees (more than 6m mature height) are not to be planted closer than 4m from building foundations. This allows for the growth of the tree over its life and prevents problems in the future that may cause the tree's removal.

Replacement trees must also be planted 1m away from all property lines, 3m away from another tree and not planted in hedge like formation.

PROPOSED TREES  
(Japanese snowbell/Eddie's White Wonder Dogwood/  
Starlight Dogwood/ Eastern Redbud or Serviceberry  
(Autumn Brilliance or 'Princess Diana'))

LANDSCAPE  
RETAINING WALL  
12" TO 36" TALL

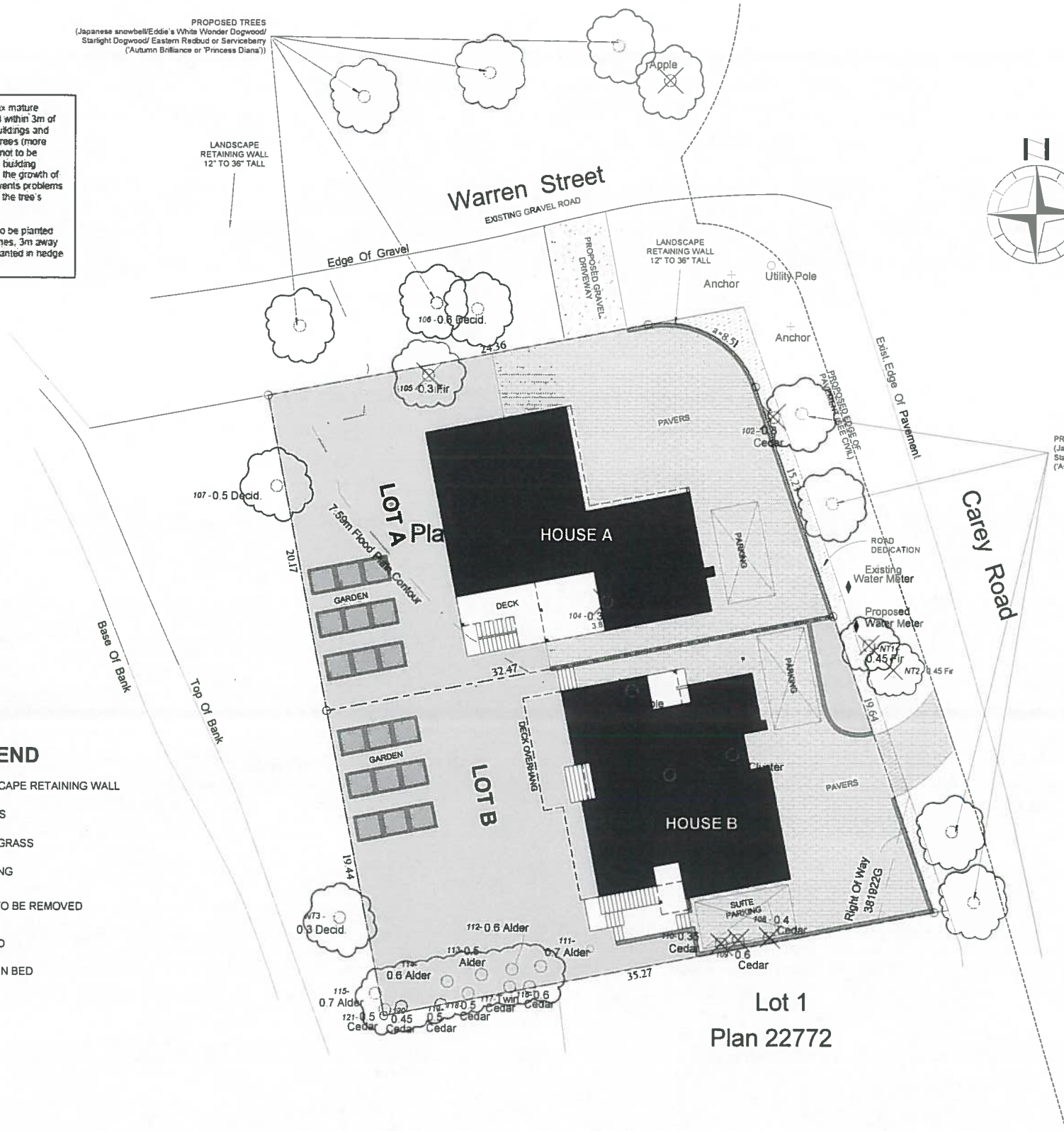

PROPOSED TREES  
(Japanese snowbell/Eddie's White Wonder Dogwood/  
Starlight Dogwood/ Eastern Redbud or Serviceberry  
(Autumn Brilliance or 'Princess Diana'))

LEGEND

- [Symbol] LANDSCAPE RETAINING WALL
- [Symbol] PAVERS
- [Symbol] LAWN GRASS
- [Symbol] BUILDING
- [Symbol] TREE TO BE REMOVED
- [Symbol] TREE ID
- [Symbol] GARDEN BED

Lot 1  
Plan 22772

LANDSCAPE PLAN  
1 : 150

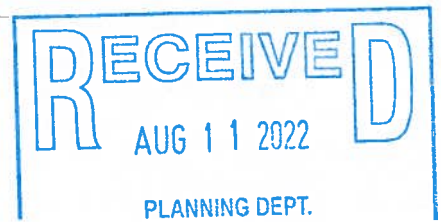

No.	Date	Appr.	Revision	Notes
A	23-02-23	Permit set		
B				
C				

Aspire Custom Designs  
1145 Blue Street  
Victoria BC Canada V8C 1L9  
Lindsay / Beier 250-415-1056

4136 CAREY RD  
REZONING / SUBDIVISION

LANDSCAPE PLAN

23-02-23

L. Baker 1/4" = 1/8" or as noted

L. Baker