

COPYRIGHT RESERVED. ALL PARTS OF THIS DRAWING ARE THE EXCLUSIVE PROPERTY OF WA ARCHITECTS LTD AND SHALL NOT BE USED WITHOUT THE ARCHITECT'S PERMISSION. ALL DIMENSIONS SHALL BE VERIFIED BY THE CONTRACTOR BEFORE COMMENCING WORK.

CIVIL CONSULTANT  
**McElhanney**

OWNER/CLIENT  
**WESBILD**

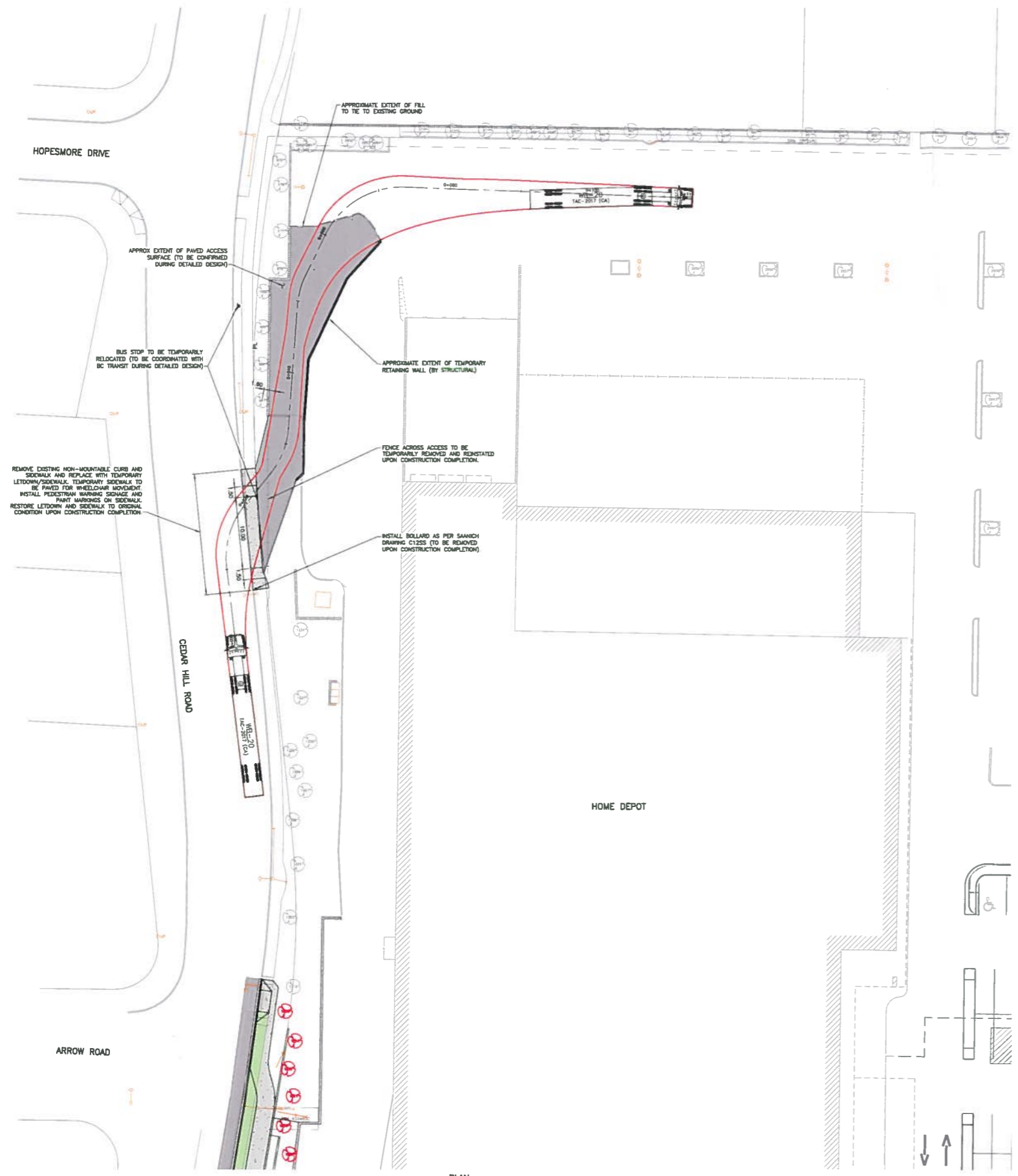

PLAN  
1:250

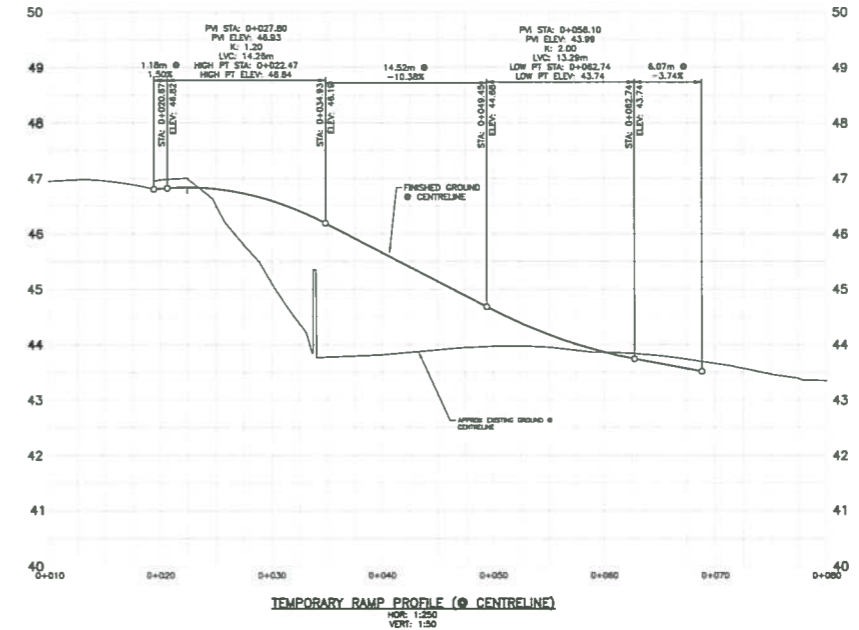

TEMPORARY RAMP PROFILE (@ CENTRELINE)  
HOR: 1:250  
VER: 1:30

NO.	ISSUE	DATE
1	RE ISSUED FOR DEVELOPMENT PERMIT	2020/04

CONSULTANT:



1444 Alberni Street Vancouver V6B 2Z4  
154 3212 Jackson Road Victoria V8B 2J5  
604 685 3329 | office@wa.arch.ca | wa.arch.ca

PROJECT NAME:  
**UNIVERSITY HEIGHTS SHOPPING CENTRE MIXED-USE**  
PROJECT ADDRESS:  
3956 SHELBORNE STREET  
SAANICH, BC V8N 3E2  
DRAWING TITLE:  
**TEMPORARY CONSTRUCTION ACCESS OFF CEDAR HILL ROAD**

PROJECT NO: 17-005 DRAWN BY: MTK  
SCALE: AS NOTED REVIEW BY: NCD  
DWG NO: CIVIL DP 4

- LEGEND:
- EXISTING TREE TO REMAIN
  - TREE TAG NUMBER
  - EXISTING TREE TO BE REMOVED

- NOTES:
- FOR BUILDING INFORMATION, SEE DRAWINGS BY WA ARCHITECTS LTD.
  - FOR LANDSCAPE, SEE DRAWINGS BY PAE LANDSCAPE ARCHITECTS.
  - FOR LEGAL INFORMATION, SEE DRAWINGS BY MCILVANEY RILEY LAND SURVEYING INC.
  - FOR DETAILED TREE INFORMATION, SEE REPORT BY DUNSTER & ASSOCIATES ENVIRONMENTAL CONSULTANT LTD.

- NOTE:
- DRAWING PROVIDES CONCEPTUAL PLAN AND PROFILE DETAILS OF THE TEMPORARY ACCESS OFF CEDAR HILL ROAD. DETAILED DESIGN DRAWINGS TO BE COMPLETED CONFIRMING WALL HEIGHTS, WALL DETAILS, BUS STOP RELOCATION, PEDESTRIAN SIGNAGE, ETC.
  - CURB, SIDEWALK, BOULEVARD, FENCES, ETC. TO BE RECONSTRUCTED TO ORIGINAL CONDITION TO THE APPROVAL OF SAANICH UPON CONSTRUCTION COMPLETION.



MAY 4, 2020  
ISSUED FOR  
DEVELOPMENT  
PERMIT

LEGAL PLAN & AND SURVEY  
INFORMATION PROVIDED BY MCILVANEY  
RILEY LAND SURVEYING INC.

