

Reynolds Street

B.C. Land Surveyor's Site Plan of Lot A (DD 235730I), Block 3, Section 32, Victoria District, Plan 1489.

Scale 1:250

All distances are in metres.
Lot dimensions derived from registered plans.

Elevations are Geodetic.

CIVIC ADDRESS: 3943 La Salle Street, Victoria B.C.

P.I.D. 004-233-000

Note: Lot dimensions are approximate and need a legal survey to determine final subdivision dimensions.

 100 Denotes tree and tree number

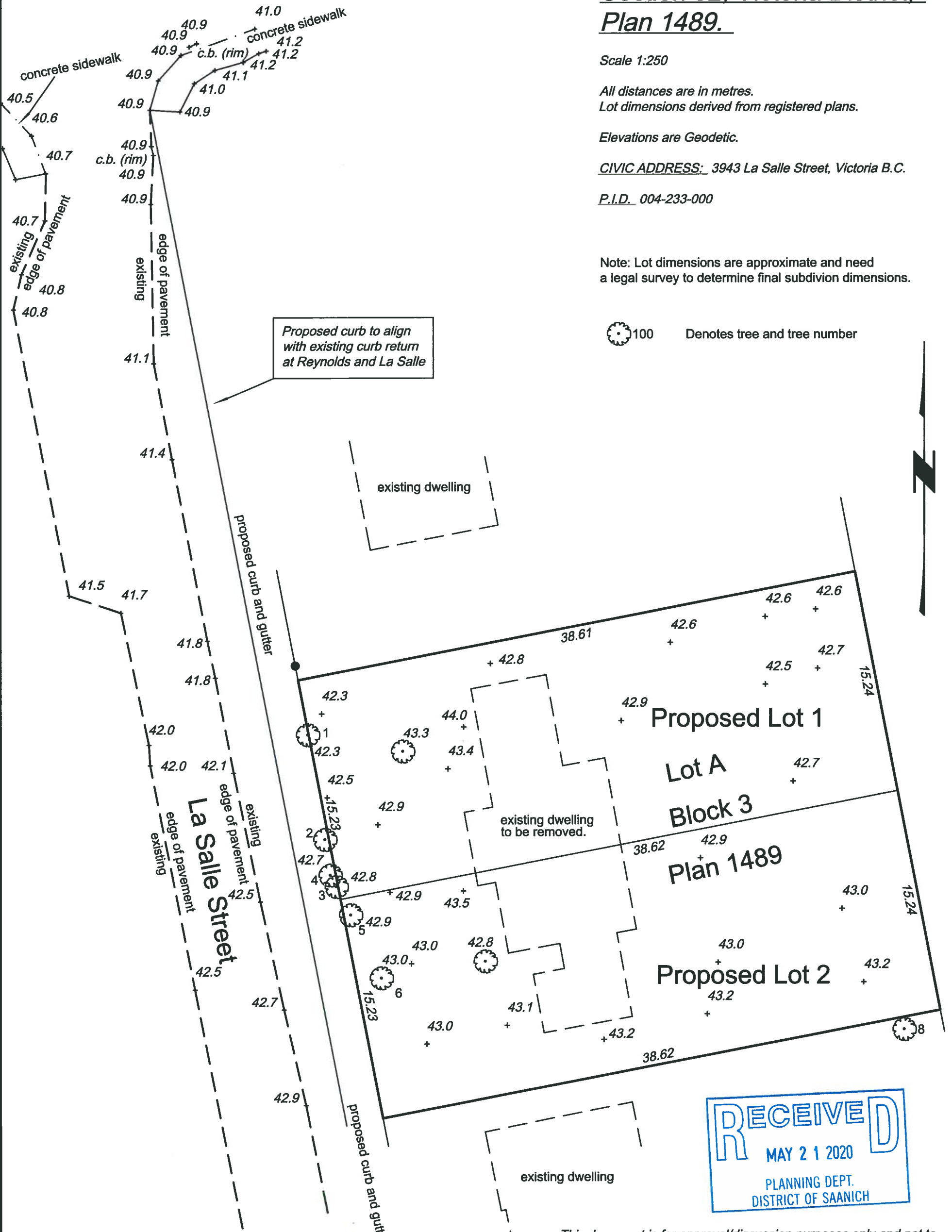

Please see tree report supplied by Talbot Mckenzie Associates.

This document is for approval/discussion purposes only and not to be used for the reestablishment of property boundaries.

This plan was prepared for design purposes and is for the exclusive use of our client.

The signatory accepts no responsibility for any damages that may be suffered by a third party as a result of reproduction, transmission, or alteration to this document without consent of the signatory.

Field Survey: April 24, 2020

MICHAEL CLAXTON
LAND SURVEYING INC.

B.C. & Canada Lands Surveyor
Unit 80A 4223 Commerce Circle
Victoria, B.C. V8Z-6N6
Phone: 250-479-2258 Fax: 250-479-3831
Email: surveys@hilbre.ca

File: 19478(Site 2)

AMD. May 12, 2020

This plan is prepared from unchecked field data.
Check measurements prior to construction.

© MICHAEL E. CLAXTON, B.C.L.S. 2020