

PROJECT ADDRESS

3941 Lasalle
Saanich BC

Lot A (DD 235730), Block 3,
Section 32, Victoria District, Plan 1489

PID 004-233-000

ZONE RS-6
LOT AREA 1176 m2 (Total)

PROJECT DATA

Proposed Lot 1
Lot Area = 6329 ft2 / 588 m2
Lot Coverage = 1642 ft2 / 152.50 m2 / 25.9%
Main Floor Area (Garage Ex) = 1073 ft2 / 99.68 m2
Upper Floor Area = 1211 ft2 / 112.51 m2
Basement Floor Area = 877 ft2 / 81.48 m2
Total Floor Area = 3161 ft2 / 293.67 m2 / FAR 0.499/1
Non Basement Floor Area = 2284 ft2 / 212.19 m2
72.1% of Allowable Area
Building Height - From Avg. = 7.14m
From Low Avg. = 7.38m
See Plan for Setback Information

Proposed Lot 2
Lot Area = 6329 ft2 / 588 m2
Lot Coverage = 1660 ft2 / 154.2 m2 / 26.2%
Main Floor Area (Garage Ex) = 1073 ft2 / 99.68 m2
Upper Floor Area = 1208 ft2 / 112.23 m2
Basement Floor Area = 877 ft2 / 81.48 m2
Total Floor Area = 3158 ft2 / 293.39 m2 / FAR 0.499/1
Non Basement Floor Area = 2281 ft2 / 211.91 m2
72.1% of Allowable Area
Building Height - From Avg. = 7.02m
From Low Avg. = 7.03m
See Plan for Setback Information



2 Location Map
A1 Scale: 1:1600



4 Location Map
A1 Scale: 1:800



3 Location - Aerial Isometric
A1



3947 / 3949 Lasalle St.



3943 Lasalle St. (Subject Property)



3941 Lasalle St. (Subject Property)



3939 Lasalle St.



3937 Lasalle St.

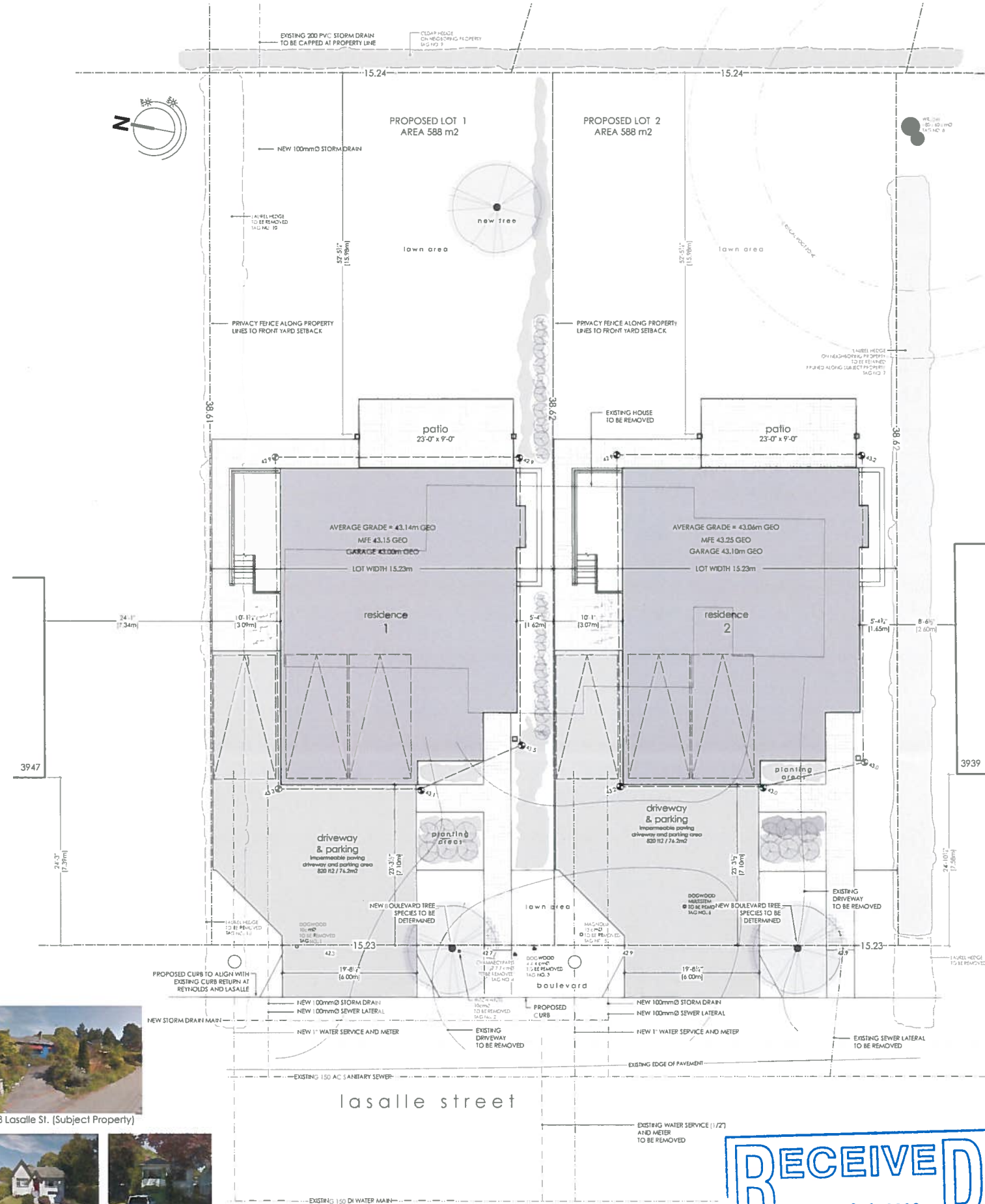

1 Site Plan
A1 Scale: 1:100

REVISION LIST

- R1 - Issue for DVP - Oct. 2.18
- R1 - SERVICING REVISIONS - MAY 4, 2020

DRAWING LIST

- A1 Site and Landscape Plan, Location Maps
- A2 Proposed Design Plans
- A3 Proposed Building Elevations

Subdivision for Mijo Construction
3941 Lasalle St. Saanich BC

FILE	SCALE	DATE	DATE
SE30.19	As Noted	1912	May 4, 2020
TDR			
DVP			

