



Area Map



Location Map



Aerial Views of Subject Property



Existing Accessory Garage, View to North



Existing Accessory Garage, View to Northwest

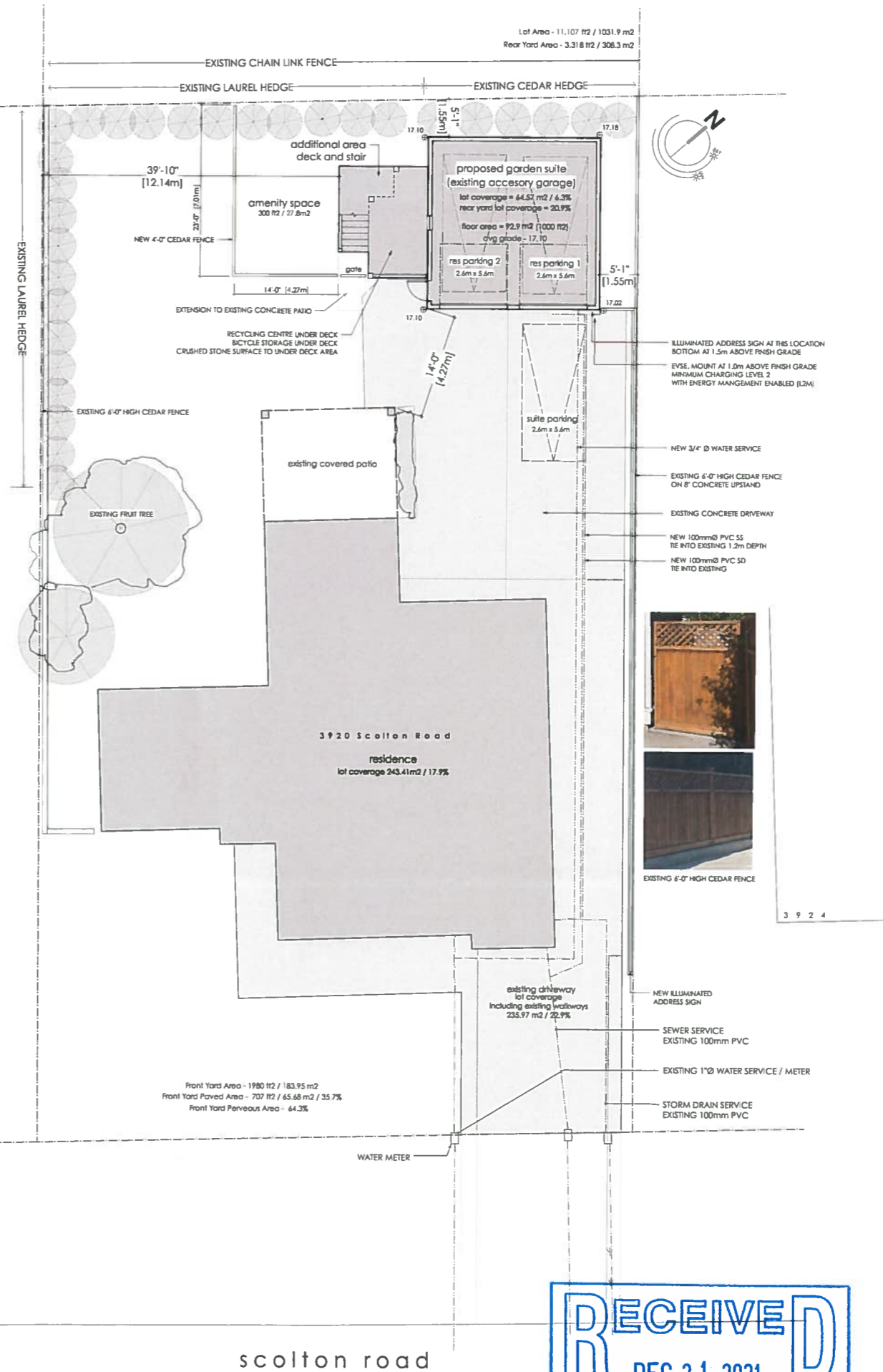

Site Plan
Scale: 1:100

PROJECT ADDRESS

3920 Scollon Road
Saanich BC

The South East Part of Lot 2
Section 44, Victoria District, Plan 5460

PID 005-966-523

ZONE RS-10

LOT AREA 1031.9 m² / 11,107 ft²

PROJECT DATA

Use Garden Suite

Setbacks	
Rear Yard	1.55 m*
Side Yard Interior (NE)	1.55 m*
Side Yard Interior (SW)	12.14 m
Building Separation - Residence	4.27 m

Avg Natural Grade	17.10 m
Avg Finished Grade	17.10 m

Building Height	5.93 m
-----------------	--------

Lot Coverage	
Lot Area	1031.9 m ²
Proposed Garden Suite	64.57 m ² / 6.3%
Existing Residence Lot Cov	243.41 m ² / 17.9%
Total Lot Coverage	307.98 m ² / 24.2%

Rear Yard Area	308.3 m ²
Total Rear Yard Coverage	64.57 m ² / 20.9%

Open Site Space (G5)	
Proposed Garden Suite	64.57 m ²
Walkways, Patios, Driveway	235.97 m ²
Existing Residence	243.41 m ²
Total Coverage	543.95 m ² / 52.7%
Open Site Space	47.3%

Parking	
Garden Suite	1
Residence	2

Suite Floor Area	92.9 m ² / 1000 ft ²
------------------	--------------------------------------------

* Denotes existing condition, variance request.

REVISION LIST

R1 - October 25, 2021
Issue for Review / Permit

DRAWING LIST

A1 Site & Location
A2 Plans, Section, Elevations & Existing

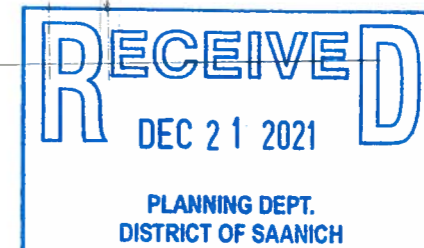

Garden Suite for J. Howard
3920 Scollon Road

PROJECT NO	SE13.21	SCALE	As Noted
DATE	2135	DATE	Oct. 25, 2021
DRAWN BY	TDR	SHEET NO	A1
ISSUE FOR	Issue For Review	REV	