

CEDAR HILL ROAD

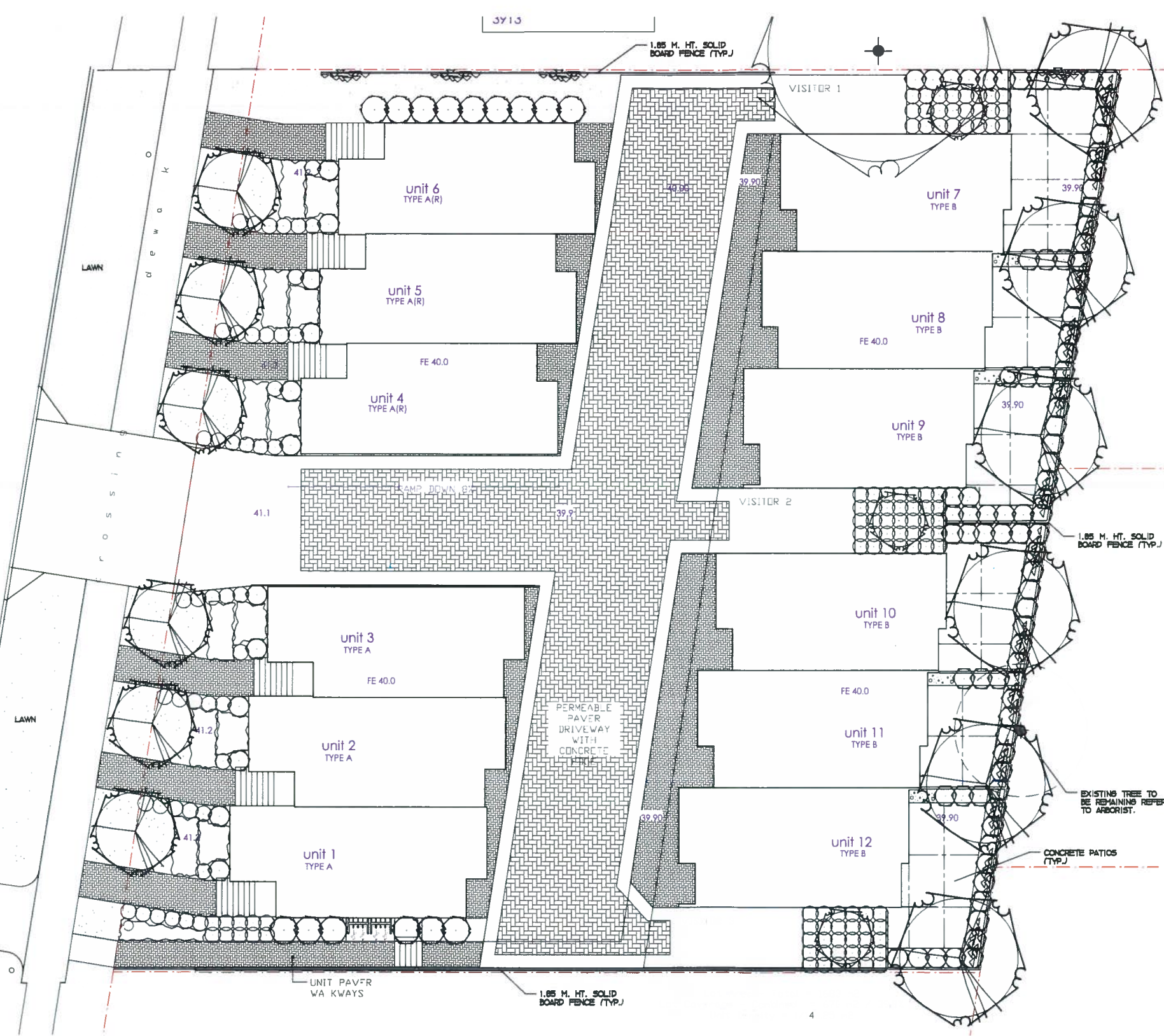

### LEGEND

- MEDIUM DECIDUOUS TREE TO BE A SELECTION OF: RED MAPLE, KATSURA TREE, HEDGE MAPLE, HOLY LOCUST, LITTLE LEAF LINDEN, TREBLING ASPEN, SIZE 5 CM CAL., APPROXIMATE NO. - 06
- COLLIMAR DECIDUOUS TREE TO BE A SELECTION OF: COLLIMAR GOLD MAPLE, COLLIMAR RED MAPLE, SIZE: 6.0 CM CAL., 4.5-5.5 M HT., APPROXIMATE NO. - 06
- MULTI STEM TO BE A SELECTION OF: STAR MAGNOLIA (DEC), STARBERRY SUMAC (DEC), HOLY (BU), CAMELIA (BU), JAPANESE ARALIA (BU), LILAC (DEC), SIZE 27 CM POT, APPROXIMATE NO. - 08
- LARGE SHRUB TO BE A SELECTION OF: GLOSSY ADELIA (BU), PIERIS (BU), RHODOODENDRON (BU), MEXICAN GRANITE (BU), DECIDUOUS AZALEA (DEC), COTONASTER (BU), PORTUGUESE LAUREL (BU), FIRETHORN (BU), HYDRANGEA (DEC), SIZE 27 CM POT, APPROXIMATE NO. - 15
- MEDIUM SHRUB TO BE A SELECTION OF: RHODOODENDRON (BU), JAPANESE AZALEA (BU), PINK ESCALLONIA (BU), BARBERRY (BU), BUXUS (BU), FERNS (BU), SIZE 21 CM POT, APPROXIMATE NO. - 100
- SMALL SHRUB TO BE A SELECTION OF: DWARF RHODOODENDRON (BU), EDWARD BOULEDER ADELIA (BU), LAVENDER (BU), SOUTHERN SPirea (DEC), DWARF JAPANESE AZALEA (BU), NEWPORT DWARF ESCALLONIA (BU), SIZE 15 CM POT, APPROXIMATE NO. - 144
- VINES TO BE A SELECTION OF: PYRAMANTHA (BU), BELMANN IVY (DEC), CLEMATIS (DEC), SIZE 21 CM POT, APPROXIMATE NO. - 18
- GROUNDCOVER TO BE A SELECTION OF: PERIWINKLE, PERIWINKLE (BU), KIRKINICK (BU), WINTERGREEN (BU), BEARBERRY (BU), SIZE 10 CM POT, PLANT 48 CM O.C.

### NOTES

- LANDSCAPE AREAS ARE TO BE IRRIGATED WITH A FULLY AUTOMATIC UNDERGROUND IRRIGATION SYSTEM.
- THIS DRAWING IS CONCEPTUAL ONLY AND NOT INTENDED FOR CONSTRUCTION PURPOSES.
- THIS DRAWING IS FOR SOFT LANDSCAPE ONLY.

**RECEIVED**  
DEC 04 2020  
PLANNING DEPT.  
DISTRICT OF SAANICH

3907/ 3909 CEDAR HILL  
VICTORIA, B.C.

<p>S.P.</p> <p>J.P.</p> <p>DATE: OCTOBER 19, 2020</p> <p>PROJECT: 8907-09-PIR2.DWG</p> <p>SCALE: 1776 29 01</p>	<p>1 : 100</p>
---	----------------



**PRELIMINARY PLAN P1**



CEDAR HILL ROAD



LEGEND

- MEDIUM DECIDUOUS TREE TO BE A SELECTION OF: RED MAPLE (DEC), KATLANA TREE (DEC), RED MAPLE (DEC), LACINIA (DEC), LITTLE LEAF LINDEN, TREMBLING ASPEN, SIZE 5' CH CAL., APPROXIMATE NO. - 06
- COLUMNAR DECIDUOUS TREE TO BE A SELECTION OF: COLUMNAR RED MAPLE, COLUMNAR RED MAPLE, SIZE: 6.0 CH CAL., 4.5-5.5 M HT., APPROXIMATE NO. - 06
- MULTISTEM TO BE A SELECTION OF: STAR MAGNOLIA (DEC), STAR-MAGNOLIA (DEC), TOLLY (BU), CAMELIA (BU), JAPANESE ANEMONE (BU), LILAC (DEC), CITRUS (BU), FORTULIFE LILAC (BU), FIRE-THORN (BU), HYDRANGEA (DEC), SIZE 27 CH POT, APPROXIMATE NO. - 15
- LARGE SHRUB TO BE A SELECTION OF: GLOSSY ABELIA (BU), PIERIS (BU), RHODODENDRON (BU), MEXICAN ORANGE (BU), DECIDUOUS AZALEA (DEC), COTONASTER (BU), FORTULIFE LILAC (BU), FIRE-THORN (BU), HYDRANGEA (DEC), SIZE 27 CH POT, APPROXIMATE NO. - 15
- MEDIUM SHRUB TO BE A SELECTION OF: RHODODENDRON (BU), JAPANESE AZALEA (BU), PINK ESCALLONIA (BU), BARBERRY (BU), SUXIA (BU), PIERIS (BU), SIZE 21 CH POT, APPROXIMATE NO. - 100
- SMALL SHRUB TO BE A SELECTION OF: DWARF RHODODENDRON (BU), EDWARD GOLDSCHER ABELIA (BU), LAUREL (BU), SOLIDAGO SPICE (DEC), DWARF JAPANESE AZALEA (BU), NEWPORT DWARF ESCALLONIA (BU), SIZE 15 CH POT, APPROXIMATE NO. - 144
- VINES TO BE A SELECTION OF: PYRACANTHA (BU), ENIGMATA (BU), (DEC), OLEA (DEC), SIZE 21 CH POT, APPROXIMATE NO. - 18
- GROUNDCOVER TO BE A SELECTION OF: PERIWINKLE (BU), KINKIKINICK (BU), WINTERGREEN (BU), BARBERRY (BU), SIZE 10 CH POT, PLANT 48 CH O.C.

NOTES

- LANDSCAPE AREAS ARE TO BE IRRIGATED WITH A FULLY AUTOMATIC UNDERGROUND IRRIGATION SYSTEM.
- THIS DRAWING IS CONCEPTUAL ONLY AND NOT INTENDED FOR CONSTRUCTION PURPOSES.
- THIS DRAWING IS FOR SOFT LANDSCAPE ONLY.

Lot Area - Total = 1683 m<sup>2</sup>  
 Lot Coverage - (Concrete) = 670 m<sup>2</sup> / 39.8%  
 Unit Density = 1/140.25 m<sup>2</sup>

RECEIVED  
 DEC 04 2020  
 PLANNING DEPT.  
 DISTRICT OF SAANICH

3907/ 3909 CEDAR HILL  
 VICTORIA, B.C.

DATE	BY	REVISION
S.P.		
J.P.		
OCTOBER 19, 2020		
8907-09-PIR2.DWG		
17/8 20 01		



PRELIMINARY PLAN (PI)