

Plan 877

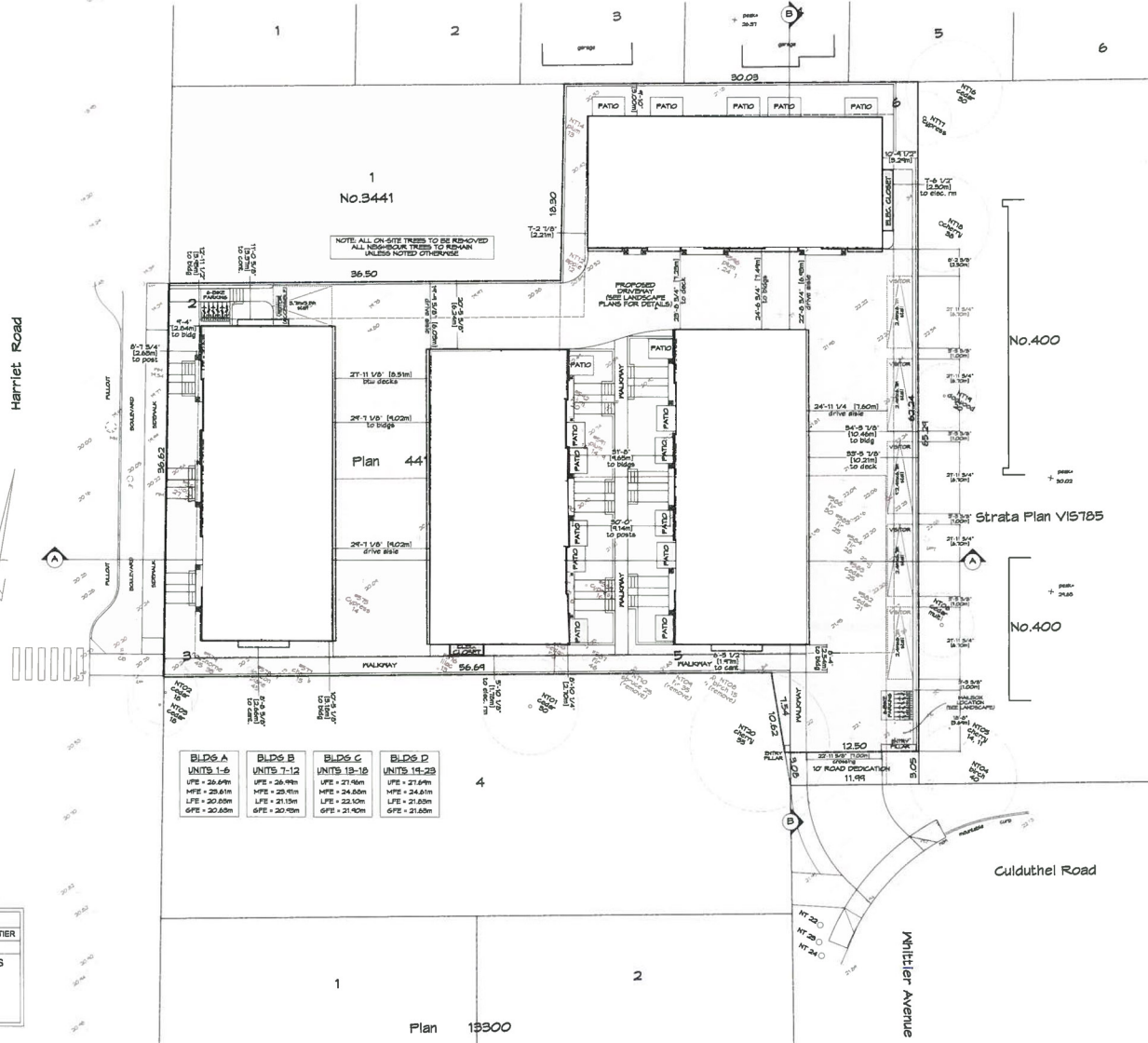

No. 3441

Plan 44

No. 400

Strata Plan V15785

No. 400

Cuduthel Road

Whittier Avenue

Plan 19300

Proposed Site Plan  
Scale: 1:200

BLDG. A UNITS 1-6	BLDG. B UNITS 7-12	BLDG. C UNITS 13-18	BLDG. D UNITS 19-23
UFE = 26.69m	UFE = 26.99m	UFE = 27.90m	UFE = 27.69m
MFE = 23.61m	MFE = 23.91m	MFE = 24.82m	MFE = 24.61m
LFE = 20.89m	LFE = 21.19m	LFE = 22.10m	LFE = 21.89m
GFE = 20.89m	GFE = 20.19m	GFE = 21.10m	GFE = 21.89m

SITE PLAN BASED ON SURVEY:  
Date: JUNE 04, 2019  
Drawing: 2822 SITE 3450 WHITTIER  
File: 12.622 - 33  
POWELL & ASSOCIATES  
B C Land Surveyors  
250-2950 Douglas Street  
Victoria, BC V8T 4N4  
phone (250) 382-8856

NOTE:  
FOR ROAD/SIDEWALK/DRIVEWAY & SERVICING DETAILS  
SEE CIVIL PLANS BY JE ANDERSON  
FOR WALKWAYS/PATIOS/RETAINING WALLS/FENCES/GRADING DETAILS  
SEE LANDSCAPE PLANS BY MURDOCH DEGREEFF

ABBREVIATIONS:  
UFE = UPPER FLOOR ELEVATION  
MFE = MAIN FLOOR ELEVATION  
LFE = LOWER FLOOR ELEVATION  
GFE = GARAGE FLOOR ELEVATION

RE-ISSUED FOR  
DP/REZONING  
APR. 08, 2021

ARCHITECT  
**steller**  
ARCHITECTURAL  
CONSULTING  
210-4352 Commerce Circle  
Victoria, BC V8L 4H2  
250-294-8078

Drawn By: K. KOSHMAN  
Date: DEC. 05, 2018  
Scale: AS NOTED  
Project:  
PROPOSED  
TOWNHOUSES  
3450 WHITTIER AVE

**RECEIVED**  
JUN 24 2021  
PLANNING DEPT.  
DISTRICT OF SAANICH

REV. NO.	DESCRIPTION	DATE
1	REVISE STREETFRONT ALONG HARRIET & WHITTIER TO MATCH CIVIL LANDSCAPE. INCREASE FRONT SIZE OF TREES TAGS FOR LEGIBILITY	JAN. 07/19
2	REVISE PROJECT TO 4 BUILDINGS WITH 23 UNITS. REVISE SITE SUIT	SEPT. 14/20
3	ADD CASTLEBERRY TO UNIT UNITS. REVISE ELECTRICAL ROOMS. UPDATE SETBACKS	NOV. 16/20
4	REVISE WALKWAY TO SOUTH PROPERTY LINE. REVISE PARKING & UNIT & REVISE PARKING/BIKE RACKS ALONG 545' PROPERTY LINE. REVISE TREES TO RETAIN/REMOVE. REVISE PROXIMITIES ON WHITTIER/HARRIET	APR. 08/21

Title:  
SITE PLAN  
Revision:  
1st Submission  
REV. 1: JUN. 09/18  
REV. 2: JAN. 07/19  
REV. 3: NOV. 16/20  
REV. 4: APR. 08/21  
Sheet:  
**A**  
**101**  
Proj. No. TBD