

REVISIONS:

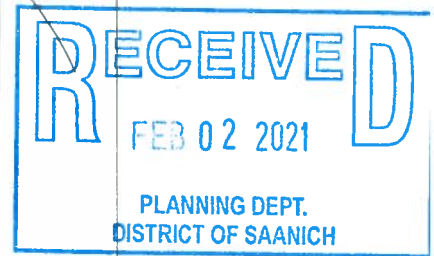





1. Issued for Review	2020/07/16
2. Revised and Re-Issued	2020/07/17
3. Revised and Re-Issued	2020/07/20
4. Revised and Re-Issued	2020/07/29
5. Revised and Re-Issued	2020/08/18
6. Revised and Re-Issued	2021/01/06
7. Revised and Re-Issued	2021/01/22
8. Revised and Re-Issued	2021/01/26

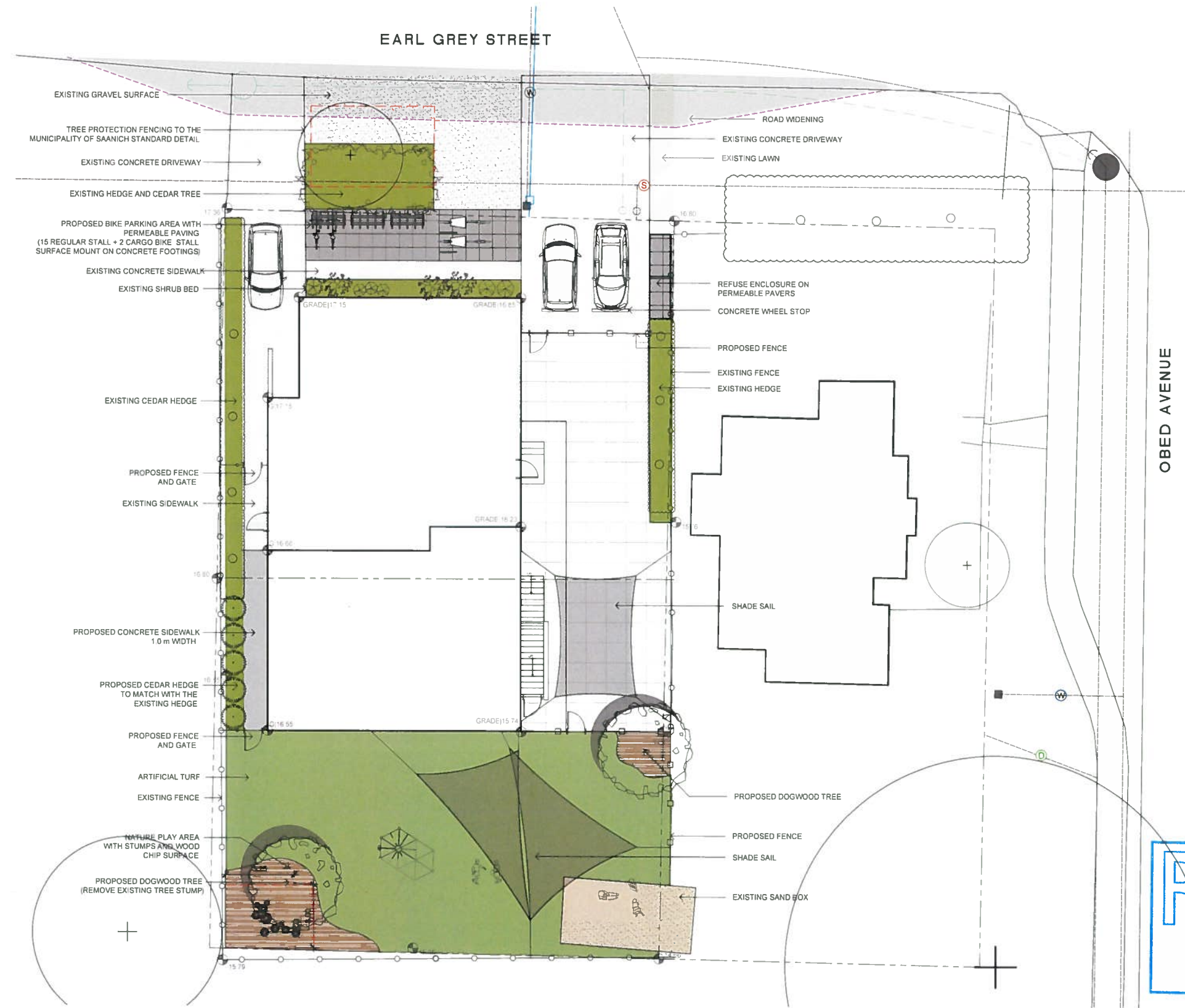

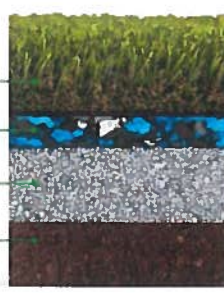
**LEGEND**

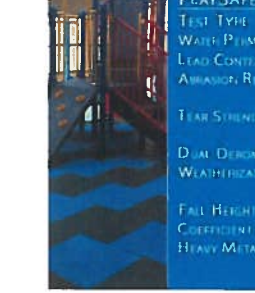
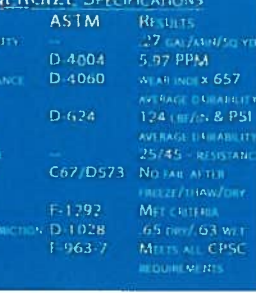
---	PROPERTY LINE
-○-	PROPOSED FENCE LINE
-○-	EXISTING FENCE LINE
-○-	TREE PROTECTION FENCING
[Green Box]	ARTIFICIAL TURF
[White Box]	EXISTING LAWN
[Green Box]	ON-SITE LANDSCAPE AREA
[Grid Box]	PERMEABLE PAVERS
[Dotted Box]	EXISTING GRAVEL
[Grey Box]	PROPOSED CONCRETE
[White Box]	EXISTING CONCRETE
[Grid Box]	RUBBER PLAYGROUND SURFACE
[Brown Box]	EXISTING SAND BOX
[Wood Box]	NATURE PLAY AREA • STUMPS AND WOOD CHIP SURFACE
[Bike Rack]	BIKE RACK (5 STALL)
[Cargo Bike Rack]	CARGO BIKE RACK (2 STALL)
[Circle +]	EXISTING TREE TO RETAIN
[Circle o]	EXISTING TREE STATUS TO BE DETERMINED
[Circle with Dotted]	PROPOSED DOGWOOD TREE
[D]	EXISTING DRAIN
[S]	EXISTING SANITARY
[W]	EXISTING WATER
[Dashed]	PROPOSED DRAIN
[Blue Box]	PROPOSED WATER
[Red Dashed]	TREE PROTECTION FENCING



<p>Rymar Artificial Turf</p> 	<p>1" or 2" Foam Pad</p> 	<p>Minimum 3" to 4" of Granular A or Crusher run</p> 	<p>Native Soil or sub-straight</p> 	<p>REFUSE ENCLOSURE</p> 	<p>RUBBER PLAYGROUND SURFACE</p> <table border="1"> <thead> <tr><th colspan="3">PLAYSAFE ENERGIZE SPECIFICATIONS</th></tr> <tr><th>TEST TYPE</th><th>ASTM</th><th>RESULTS</th></tr> </thead> <tbody> <tr><td>WATER PERMEABILITY</td><td>---</td><td>0.27 GAL/FARMS/SQ YD</td></tr> <tr><td>LEAD CONTENT</td><td>D-4004</td><td>5.97 PPM</td></tr> <tr><td>ABRASION RESISTANCE</td><td>D-4060</td><td>WEAR INDEX x 657</td></tr> <tr><td>TEAR STRENGTH</td><td>D-624</td><td>AVERAGE DURABILITY 124 (IMPACT &amp; PSI)</td></tr> <tr><td>DIAL DERMOMETER WEATHERIZATION</td><td>C67/D573</td><td>AVERAGE DURABILITY 25/45 - RESISTANCE NO FAB AFTER FREEZE/THAW/DRY</td></tr> <tr><td>FALL HEIGHT</td><td>F-1292</td><td>MEET CRITERIA</td></tr> <tr><td>COEFFICIENT OF FRICTION</td><td>D-1028</td><td>0.65 (DRY) / 0.3 (WET)</td></tr> <tr><td>HEAVY METAL</td><td>F-963-7</td><td>MEETS ALL CPSC REQUIREMENTS</td></tr> </tbody> </table>	PLAYSAFE ENERGIZE SPECIFICATIONS			TEST TYPE	ASTM	RESULTS	WATER PERMEABILITY	---	0.27 GAL/FARMS/SQ YD	LEAD CONTENT	D-4004	5.97 PPM	ABRASION RESISTANCE	D-4060	WEAR INDEX x 657	TEAR STRENGTH	D-624	AVERAGE DURABILITY 124 (IMPACT & PSI)	DIAL DERMOMETER WEATHERIZATION	C67/D573	AVERAGE DURABILITY 25/45 - RESISTANCE NO FAB AFTER FREEZE/THAW/DRY	FALL HEIGHT	F-1292	MEET CRITERIA	COEFFICIENT OF FRICTION	D-1028	0.65 (DRY) / 0.3 (WET)	HEAVY METAL	F-963-7	MEETS ALL CPSC REQUIREMENTS	<p>SHADE SAIL</p> 	<p>NATURE PLAY</p> 
PLAYSAFE ENERGIZE SPECIFICATIONS																																					
TEST TYPE	ASTM	RESULTS																																			
WATER PERMEABILITY	---	0.27 GAL/FARMS/SQ YD																																			
LEAD CONTENT	D-4004	5.97 PPM																																			
ABRASION RESISTANCE	D-4060	WEAR INDEX x 657																																			
TEAR STRENGTH	D-624	AVERAGE DURABILITY 124 (IMPACT & PSI)																																			
DIAL DERMOMETER WEATHERIZATION	C67/D573	AVERAGE DURABILITY 25/45 - RESISTANCE NO FAB AFTER FREEZE/THAW/DRY																																			
FALL HEIGHT	F-1292	MEET CRITERIA																																			
COEFFICIENT OF FRICTION	D-1028	0.65 (DRY) / 0.3 (WET)																																			
HEAVY METAL	F-963-7	MEETS ALL CPSC REQUIREMENTS																																			

ISSUED FOR DEVELOPMENT PERMIT  
January 26, 2021

Scale: 1:100

**L1** Landscape Site Plan

DATE: January 26, 2021



REVISIONS:

1. Issued for Review 2020/07/16
2. Revised and Re-Issued 2020/07/17
3. Revised and Re-Issued 2020/07/20
4. Revised and Re-Issued 2020/07/29
5. Revised and Re-Issued 2020/08/18
6. Revised and Re-Issued 2021/01/06
7. Revised and Re-Issued 2021/01/22
8. Revised and Re-Issued 2021/01/26



ISSUED FOR  
DEVELOPMENT PERMIT  
January 26, 2021

Scale: 1:100

L2 Existing Tree Retention  
and Removal Plan

DATE: January 26, 2021

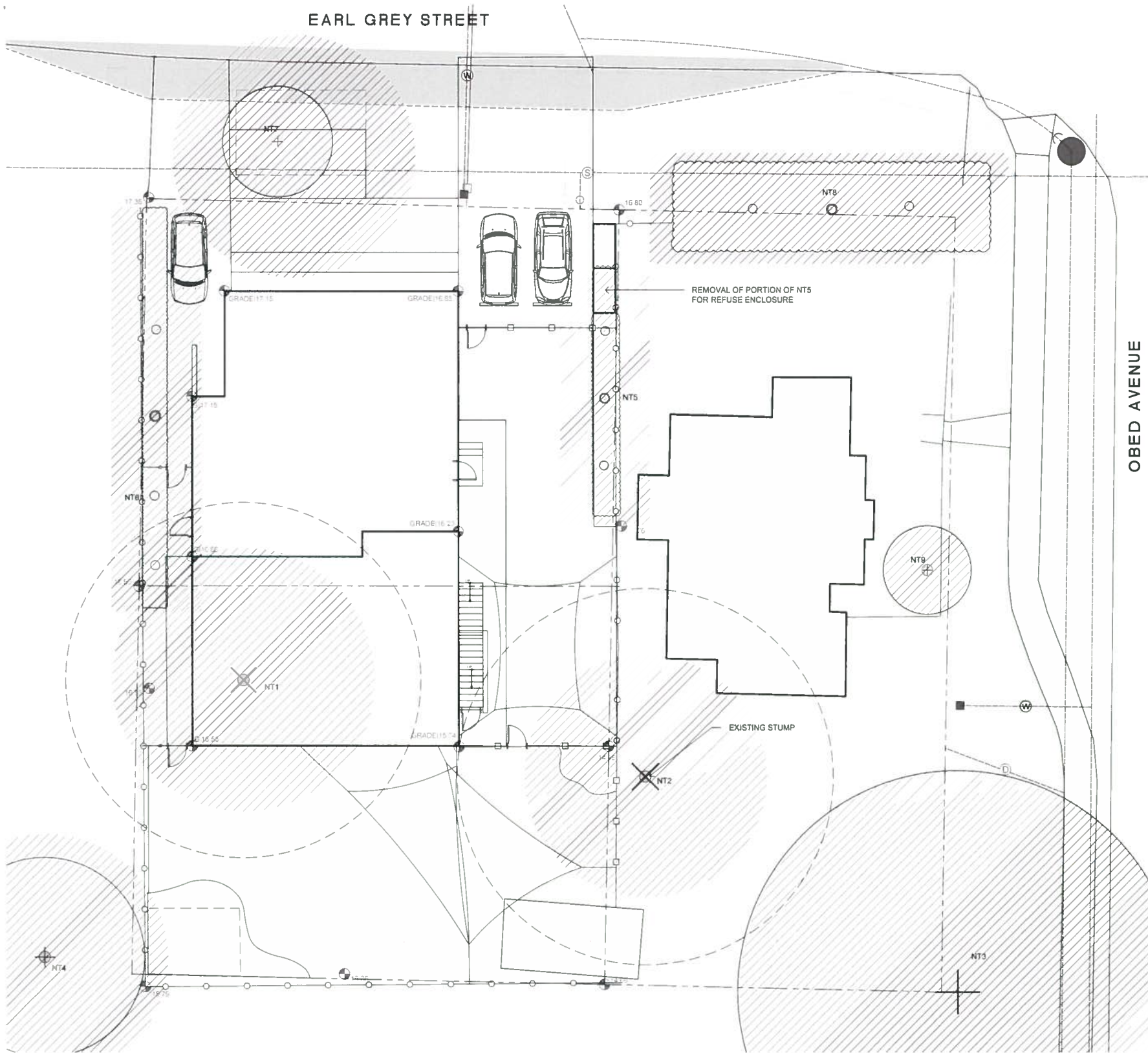

**LEGEND**

- TREE FOR REMOVAL
- PROTECTED TREE TO RETAIN
- TREE TO BE RETAINED
- TREE REMOVAL / RETENTION TO BE DETERMINED
- EXTENT OF CRITICAL ROOT ZONE
  - SEE ARBORIST REPORT PREPARED BY TALBOT MACKENZIE & ASSOCIATES
- (D)--- EXISTING DRAIN
- (S)--- EXISTING SANITARY
- (W)--- EXISTING WATER
- (D)--- PROPOSED DRAIN
- (W)--- PROPOSED WATER
- TREE PROTECTION FENCING

2969 Earl Grey St., Saanich Tree Resource Spreadsheet

Tree ID	Common Name	Latin Name	DBH (cm) - approximate	Crown Spread (meters or more)	CRZ (meters or more)	Relative Tolerance (1-5)	Health	Structure	Remarks and Recommendations	Bylaw Protected	Retention Status	Impacts
NT 01	English Walnut	<i>Juglans regia</i>	61.0	16.0	6.0	M	Fair	Fair	Twig dieback in upper canopy	Yes	Removal	Within building addition
NT 02	London Plane	<i>Platanus x acerifolia</i>	57.0	17.0	5.5	G	Good	Fair	Neighbour's Crossing Limbs	No	Removed Jan. 2021	
NT 03	Linden	<i>Tilia species</i>	-110	20.0	-10	M	Good	Fair/poor	Multiple codominant unions with included bark at DBH and 3m. Pruned for hydro lines on one side	Protected	Retain	
NT 04	Norway Spruce	<i>Picea abies</i>	-45	9.0	5.5	M	Good	Good	Neighbour's Surface roots on subject property despite retaining wall.	No	Retain	Play area, stump removal
NT 05	Pyramidal Cedar hedge	<i>Thuja occidentalis 'Pyramidalis'</i>	-	1.0	2.0	M	Fair	Good	9 plants, 6 have single stems that are close to 10cm in diameter (estimated)	No	TBD	Re-paving
NT 06	Pyramidal Cedar hedge	<i>Thuja occidentalis 'Pyramidalis'</i>	-	1.0	2.0	M	Fair	Good	10 plants along south property line, 5 have single stems over 10cm in diameter (estimated)	No	TBD	Swale, foundation excavations
NT 07	Lawson Cypress	<i>Chamaecyparis lawsoniana</i>	37.0	5.0	5.5	P	Fair	Poor	Municipal tree Topped at 5m for overhead hydro lines	Protected (municipal)	Retain *	Bike Parking
NT 08	Laurel hedge	<i>Prunus laurocerasus</i>	-	3.0	-2.5	G	Good	Good	Shared with municipality Truncated to 4m tall. Some stems over 10cm in diameter	Likely not considered protected	Retain if desired	
NT 09	California Lilac	<i>Ceanothus leucodermis</i>	13.8	4.0	2.0	M	Fair	Fair	In front of doorway in raised bed	No	Retain if desired	