

**SITE PLAN OF PROPOSED SUBDIVISION UPON LOT 11,  
SECTION 45, VICTORIA DISTRICT, PLAN 1045.**

**SHEET 1**

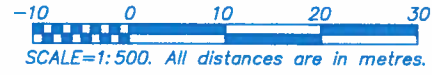

**LEGEND**

Buildings, streetscape, trees and present natural boundary surveyed October 2001.

- Denotes Standard Iron Post Found.
- ⊕ Denotes Iron Pipe Found.

NOTE: A Geotechnical Engineer must confirm the location of the building envelopes.

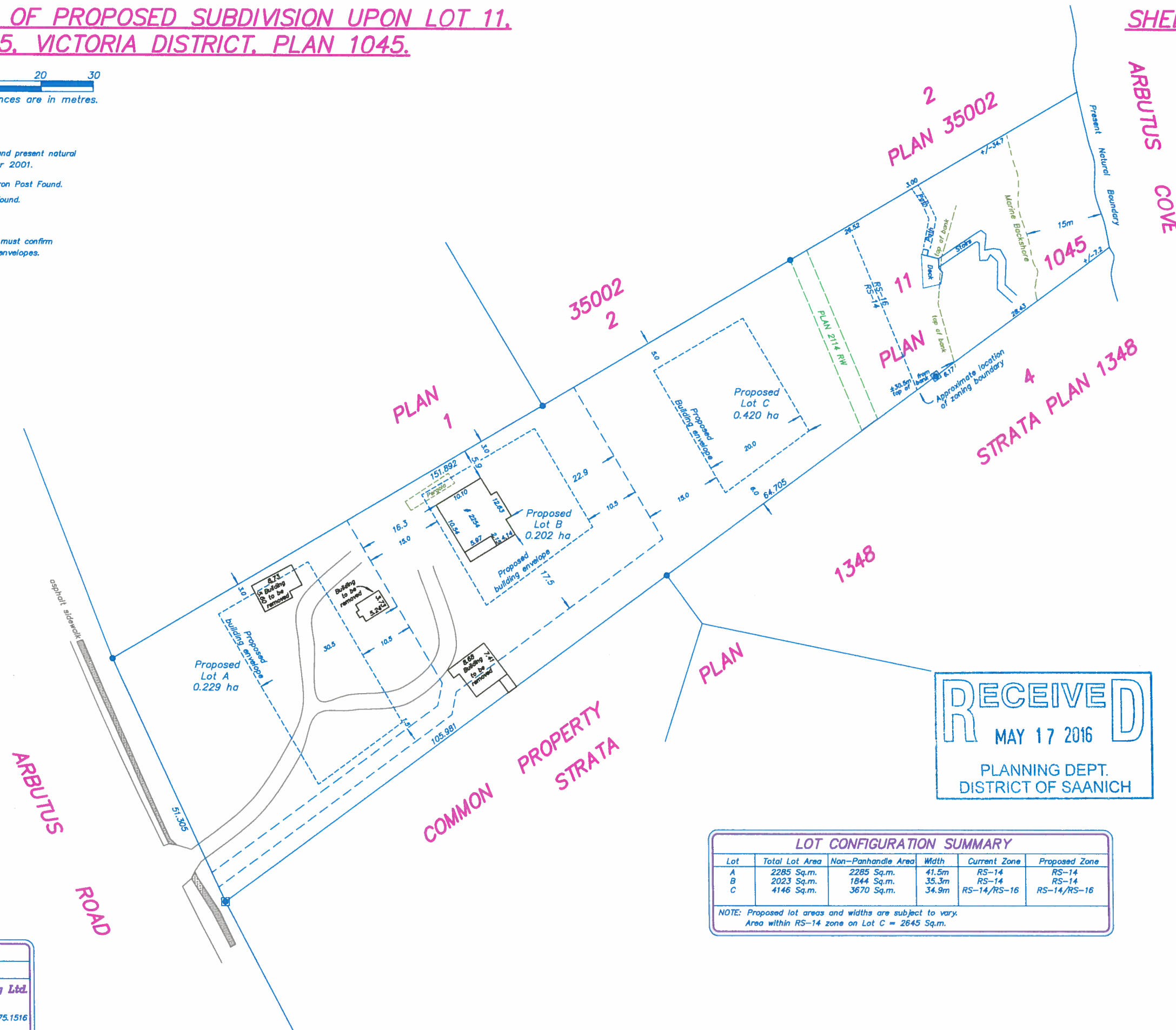

**RECEIVED**  
MAY 17 2016  
PLANNING DEPT.  
DISTRICT OF SAANICH

LOT CONFIGURATION SUMMARY					
Lot	Total Lot Area	Non-Panhandle Area	Width	Current Zone	Proposed Zone
A	2285 Sq.m.	2285 Sq.m.	41.5m	RS-14	RS-14
B	2023 Sq.m.	1844 Sq.m.	35.3m	RS-14	RS-14
C	4146 Sq.m.	3670 Sq.m.	34.9m	RS-14/RS-16	RS-14/RS-16

NOTE: Proposed lot areas and widths are subject to vary.  
Area within RS-14 zone on Lot C = 2645 Sq.m.

File: 59-MCG-MN8  
Date: May 13, 2016  
**Island Land Surveying Ltd.**  
1-15 Cadillac Avenue  
Victoria, B.C. V8Z 1T3  
TEL 250.475.1515 FAX 250.475.1516  
www.islandsurveying.ca