



**J.E. ANDERSON
& ASSOCIATES**
SURVEYORS - ENGINEERS

VICTORIA NANAIMO PARKSVILLE CAMPBELL RIVER
PHONE: 250-727-2214 WEB: www.jeanderson.com



The intended plot size of this plan is 280mm in width by 432mm in height (B size) when plotted at a scale of 1 : 400.

CLIENT : KASAPI CONSTRUCTION	
LEGAL: Lot B, Section 53, Victoria District, Plan 20946 Except Parcel A (DD 82750W)	
SHEET : TENTATIVE PLAN OF SUBDIVISION	
DRAWN BY : BAR	PROJECT SURVEYOR : D. R. CARRIER
SCALE : 1 : 400	DATE : AUGUST 1, 2019
OUR DRAWING : 30565-9.dwg LAYOUT: TENT SUB	
V: _Projects\30565-9\08\02\Microsurvey\	
At San Mateo Place	PID 003-467-627
OUR FILE : 30565-9	REVISION :

Notes:
All info is approximate only.
All distances and elevations are in metres and decimals thereof.
Elevations are to geodetic datum and are at natural grade unless otherwise noted.
Property lines have been calculated from current survey and existing records.
Additional cadastral survey is required to confirm lot dimensions.
Subject to a tree report.
Servicing shown schematically.

LEGEND

- --- Denotes Standard Iron Post Found
- △ --- Denotes Traverse Station Set
- ▣ --- Denotes Catch Basin
- ⊙ --- Denotes Drain Manhole
- ⊙ --- Denotes Sewer Manhole
- ⊙ --- Denotes Utility Pole
- ⊠ --- Denotes Water Valve Box
- ★ --- Denotes Coniferous Tree
- --- Denotes Deciduous Tree

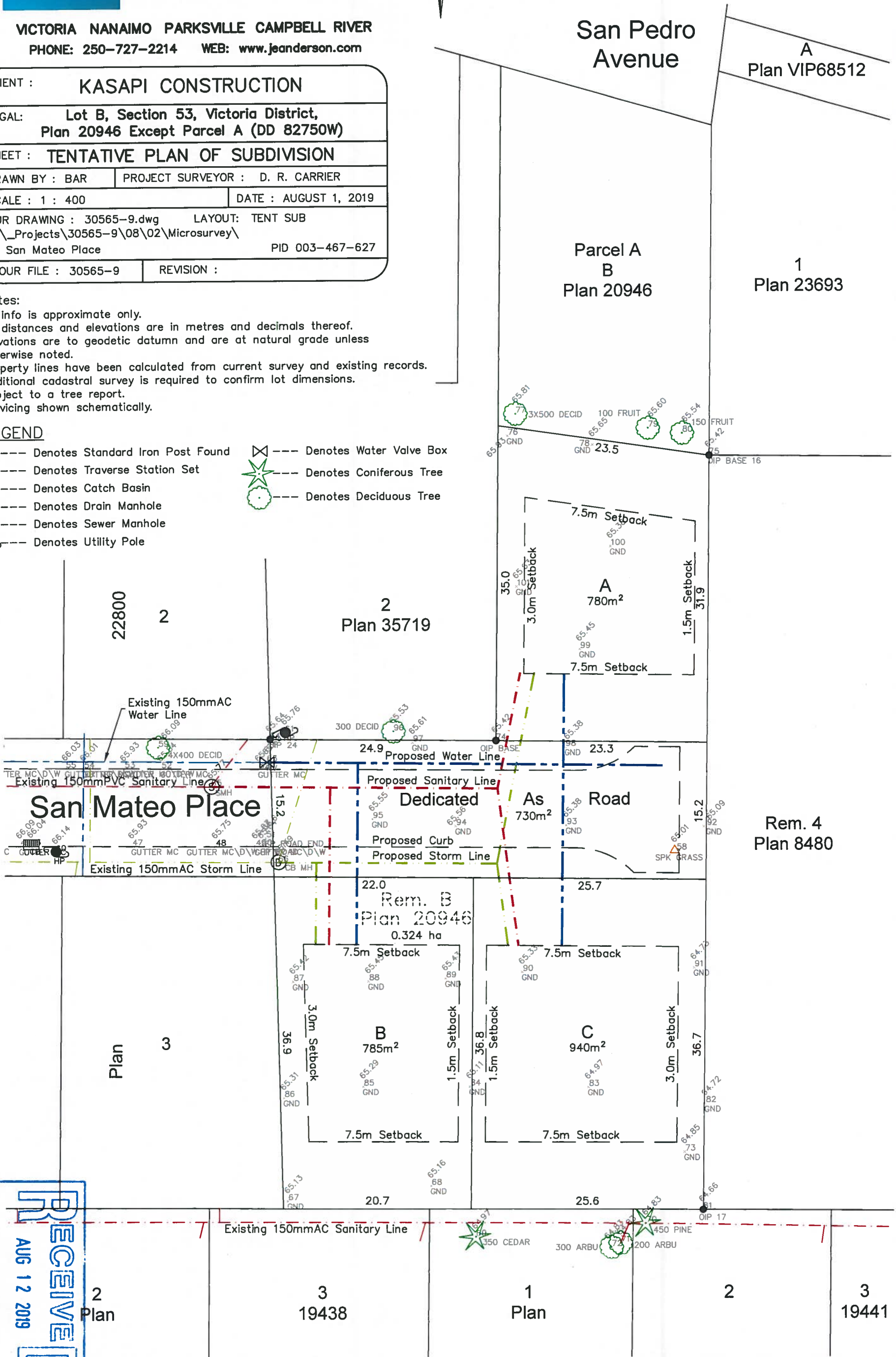

RECEIVED
 AUG 12 2019
 PLANNING DEPT.
 DISTRICT OF SAANICH