

Proposed Subdivision of 4601 Cordova Bay Road

Parcel A (DD 7803-W) of Lot 1,
Section 24, Lake District, Plan 11854

Parcel Identifier: 004-892-861

Scale - 1 : 5 0 0

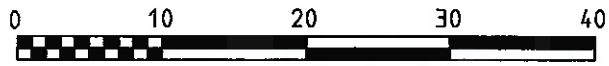

All distances are shown in metres.
The intended print size is 11 by 17.

The following non-financial charge
is shown on the current title which
may effect the property -
Covenant - CA4819104

The proposed lot dimensions
and areas shown are based
on a current field survey.

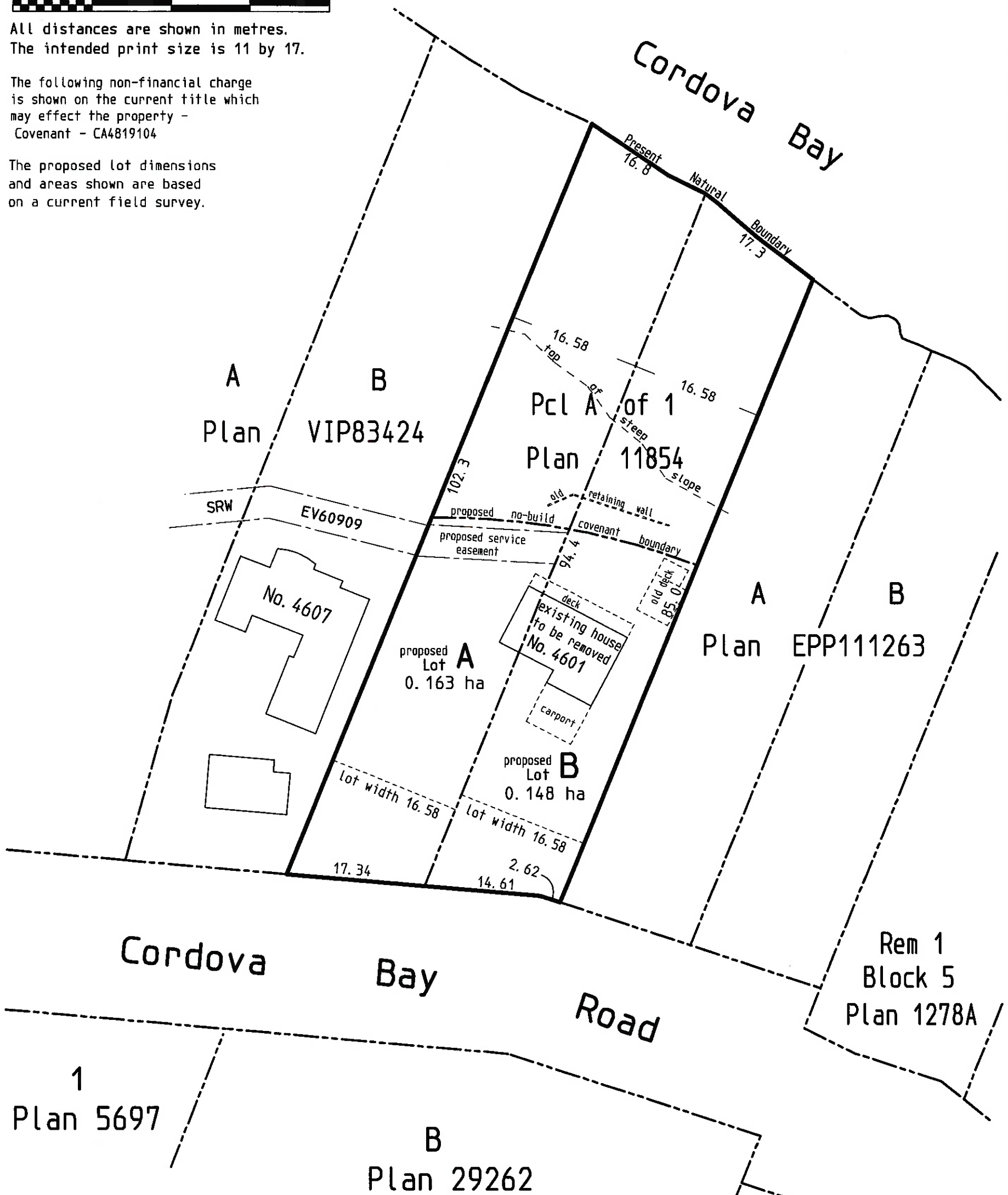

June 28, 2022

File: 13,493 Site (70D)
POWELL & ASSOCIATES
BC Land Surveyors
250-2950 Douglas Street
Victoria, BC V8T 4N4
phone (250) 382-8855

RECEIVED
AUG 02 2023
PLANNING DEPT.
DISTRICT OF SAANICH