

1 Site Plan - Existing
A102 Scale: 1:100

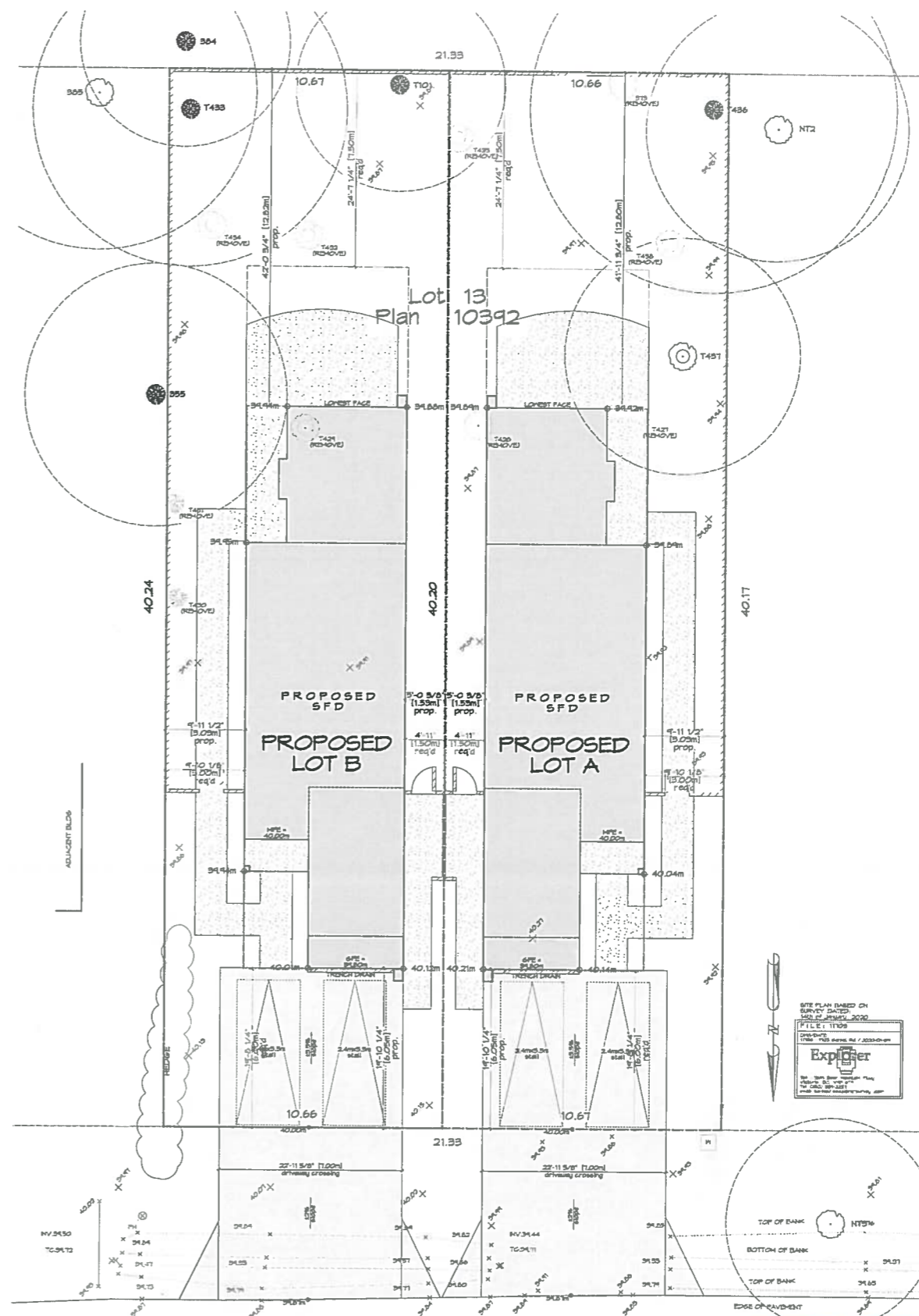

2 Site Plan - Proposed
A102 Scale: 1:100

RECEIVED
NOV 26 2021
PLANNING DEPT.
DISTRICT OF SAANICH

ISSUED FOR
SUBDIVISION & DVP
AUGUST 25, 2021

ZEBRADESIGN

1161 NEWPORT AVE
Victoria, B.C. V8S 5E6
Phone: (250) 360-2144
Fax: (250) 360-2115

Drawn By: K. K & C. C

Date: AUG 25, 2021

Scale: AS NOTED

Project:
1705 GARNET RD
- PROPOSED
SUBDIVISION

Title:
SITE PLAN

Revision:	Sheet:
	A
	102
	Proj.No. TBD